



WEAVE CITY, JIAXING, CHINA

PROJECT STATEMENT

According to the TOD model combined with urban design, the project continues the nine major scenarios of the future community, so that the needs of education, medical care, business, sports, shopping, leisure, entertainment and so on can be met in the 5-10-15 life circle. Different from the traditional development design according to the zone and stage, the future community will use the development mode of mixed linkage of multiple functional areas and zones due to its composite and diversified attributes. The "integrated design of landscape and planning" proposed by us has well unified the macro vision and implementation, and the integrity of the community and the efficiency of promotion have also been satisfied.

Weave City is a super neighborhood sharing community that integrates urban resources. From preliminary planning, design, implementation to operation planning, it is an attempt and exploration of the future urban renewal model. We link urban life, community life and family life to build an ideal community for Yuli people, paying tribute to Yuli in a more professional, holistic, and long-term way. The ever-growing Weave City will become the name card of city. Soon, we will witness the birth of this future community full of surprises.



PROJECT NARRATIVE AND CONTENTS

Every moment is an epitome of the past. In the long river of history, Yuli has gradually become a splendid and prosperous place with thriving commerce and culture. It connects the past and the present with the change of the sea salt pond. Historical marks such as silos, water towers and old wharfs become the urban memory of the land.

What does the future of Yuli look like? For new Yuli, it is a sense of nostalgic familiarity looking back on the past, as well as a sense of mysterious unknown in the face of the future. This Project uses the pictures in the memory to describe the infinite possible future, and builds a city of the future with the memory of the city. Yuli is an urban unit of Jiaxing as well as a miniature city that integrates regional social resources. The concept of co-construction, sharing and symbiosis will provide the entire site an unprecedented spiritual core, which allows Yuli to enter a new era of future community.

Weave City is a habitable future community with strong historical and cultural heritage. And it closely integrates Jiangnan water towns with modern city. The three axes running vertically and horizontally link the past, present, and future of Yuli, awakening the memory of the city and recording the past and present life of Yuli.

We plan the entire Yuli area, creating a future path for Yuli with a thinking mode that subverted the traditional landscape. The whole area is promoted to radiate to the city by preservation, inheritance and innovation. The bold imagination and expectation for the future have contributed to the unrestrained imagination of New Yuli, which will open up the future practice of the community and the city on the basis of the old and new culture, and carry out a futuristic urban revival.

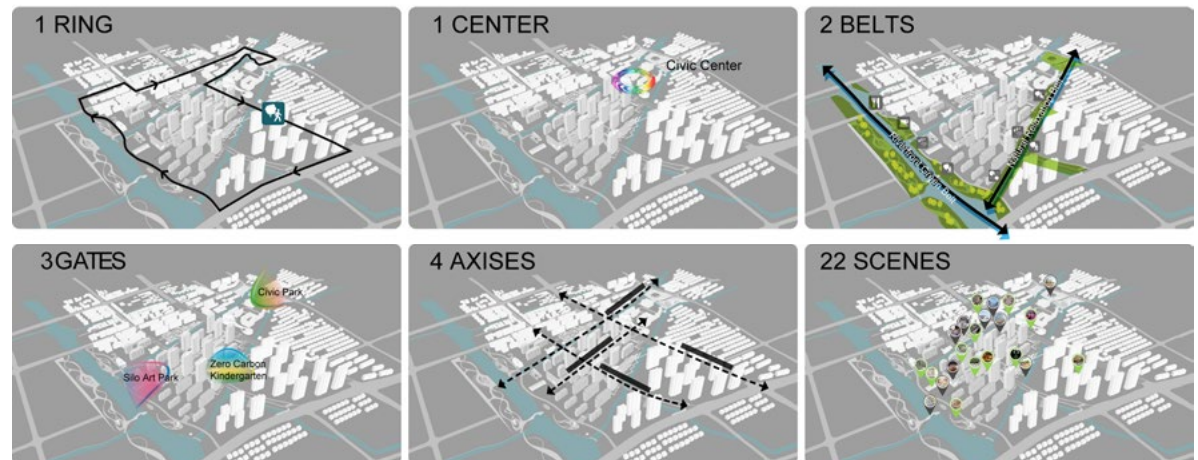



- 1. Neighborhood Center
- 2. Neighborhood Park
- 3. Residential Area
- 4. Evibrant Neighborhoods

- 5. Silo Art Center
- 6. Commercial Water Street
- 7. Primary School
- 8. Civic Cultural Park

- 9. Sea Salt Pond Waterfront
- 10. Ecological Revetment

MASTER PLAN

HEART OF THE FUTURE

New Landmark that Reshapes the Relationship between the Community and the City

The project integrates the memory of Jiaxing's water city into the landscape construction, and builds an ecological floating island with a strong sense of technology in the ripples of the water. This "flying saucer" landed in the center of the zone. It is the neighborhood center of Weave City as well as the core with complex functions. The establishment of strong memory point IP will become the future landmark of the area. The combination of IP and TOD also eliminates the boundary between the district and the city, and reshapes the relationship between the community and the city.

The building and the landscape of this project are closely integrated, to create a multi-dimensional and three-dimensional green ecological space. This is where nature, cities and communities interact to bring out the best of each other.







CO-INTEGRATION AND CO-CREATION

Activation and Regeneration of Old and New

How to connect a building with multiple functions to the surrounding neighborhoods is an issue that we need to think about. The water street next to the "flying saucer" is the memory of the city, overlapping in time and space with the neighborhood center symbolizing the future at the same time. Humanities, arts and urban texture are integrated here, and the ten scenes of the old Yuli in memory have been completely reinterpreted. The preserved silos, water towers, old wharfs and other historical relics have been reborn after decades and become Weave City.

The commercial water street uses the concept of Jiangnan water alley to create a new community business model with the scale and scene of the lane. The open and diverse commercial water street revitalizes the popularity of the neighborhood with urban memory, giving new life to old street, and the garden-style landscape fully expresses the leisure lifestyle of exquisite LOHAS.









For the natives of the site, belonging comes from identity. By preserving the memory of the city, they would maintain their lifestyle in this rejuvenated place. Meanwhile, the novel and interesting design content with future technology attracts talents to settle in new Yuli, allowing fashion trends and cultural creativity to gather here. A new group of people creates a new community, builds a multi-dimensional community life in which aboriginals and new elites coexist, and creates an infinite variety of landscapes. The interweaving of multiculturalism is the most splendid pioneering spirit in new Yuli.

SCENE SHARING

Let Social Happen Naturally

A community is not an island, and breaking boundaries is the mission that every individual needs to undertake in today's rapid urban process. The tight road network of small blocks replaces the traditional planning model, thereby stimulating the vitality of the block. We coordinate social life, community life and family life to inspire the public to socialize with their neighbors. Multiple distributed social scenes are reasonably planned into the public open space, so that sharing replaces private enjoying. The organic combination of residential areas and blocks also breaks the inherent boundaries, allowing social interaction to occur naturally. Thus, forming a scientific, rational, healthy, and intelligent new pattern of neighborhood social interaction.





The Foresight Future Plaza is an open art street corner park that takes water as the road and fish as the island, and integrates leisure and entertainment functions. The square takes the shape of a boat canopy in Jiaxing, and the green space in the shape of a fish group combines with the undulating terrain to form a shared space for social interaction to happen naturally. The slow-moving system with ecological attributes in the transitional space is combined with art installations to create a pleasant and fashionable green block.

DIALOGUE WITH HISTORY SYMBIOSIS WITH FUTURE

A Wandering Forest Floating Street

As time goes by, it is important to revive the fireworks at the end of the street, search for the memories of the street that once existed, bring back the energy and socialization of the past, and recreate a comfortable neighborhood with a strong sense of life. The DengYun Street links the Neighborhood Center and the Silo Art Center with natural art to create a roaming forest floating block for the community.



Incorporating nature into the city, roam around in search of floating islands hidden in the woods and peek into the roaming neighborhoods deep in the greenery. Inspired by art and nature, a homecoming garden path to the future community is constructed, connecting the Silo Art Park and the Future Community Neighborhood Center, with many hidden time capsules to record the past and future of the site.

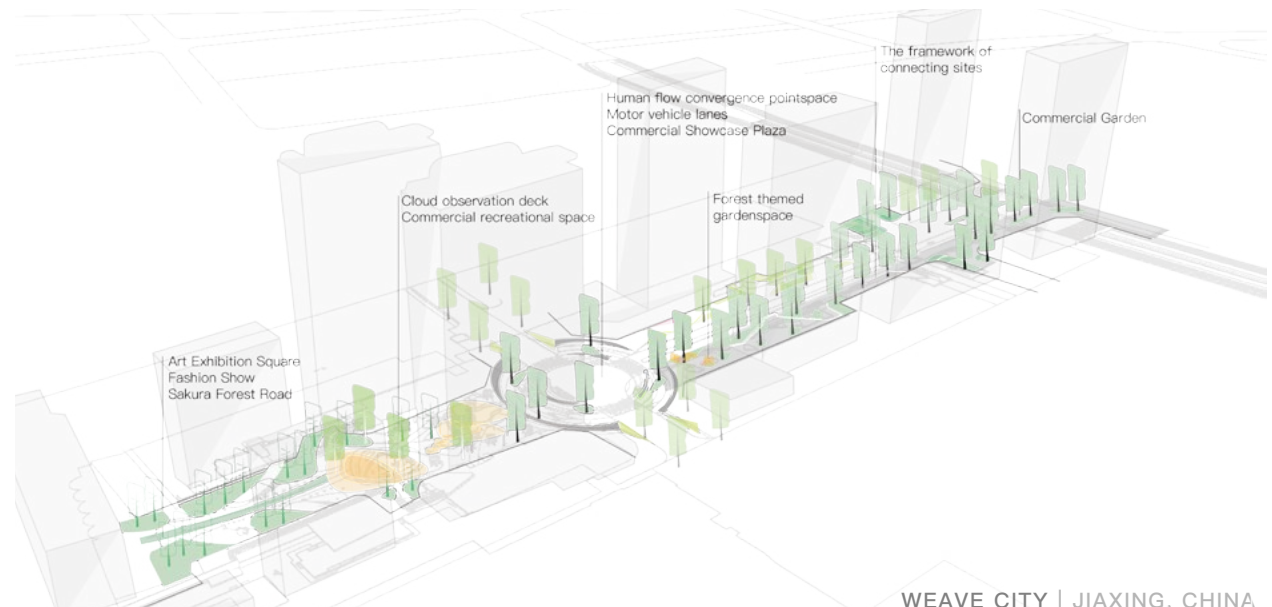

In order to improve the quality of life and enhance the vitality of the community, we have embedded modules such as the Pet Zones, Nature Classroom, Children's Wonderland, and Sports Warm-up Bins into the design of Dengyun Road, highlighting the artistic life of the street. People live, work, learn, and play here, integrating nature and art to create a new lifestyle that is different from traditional neighborhoods.

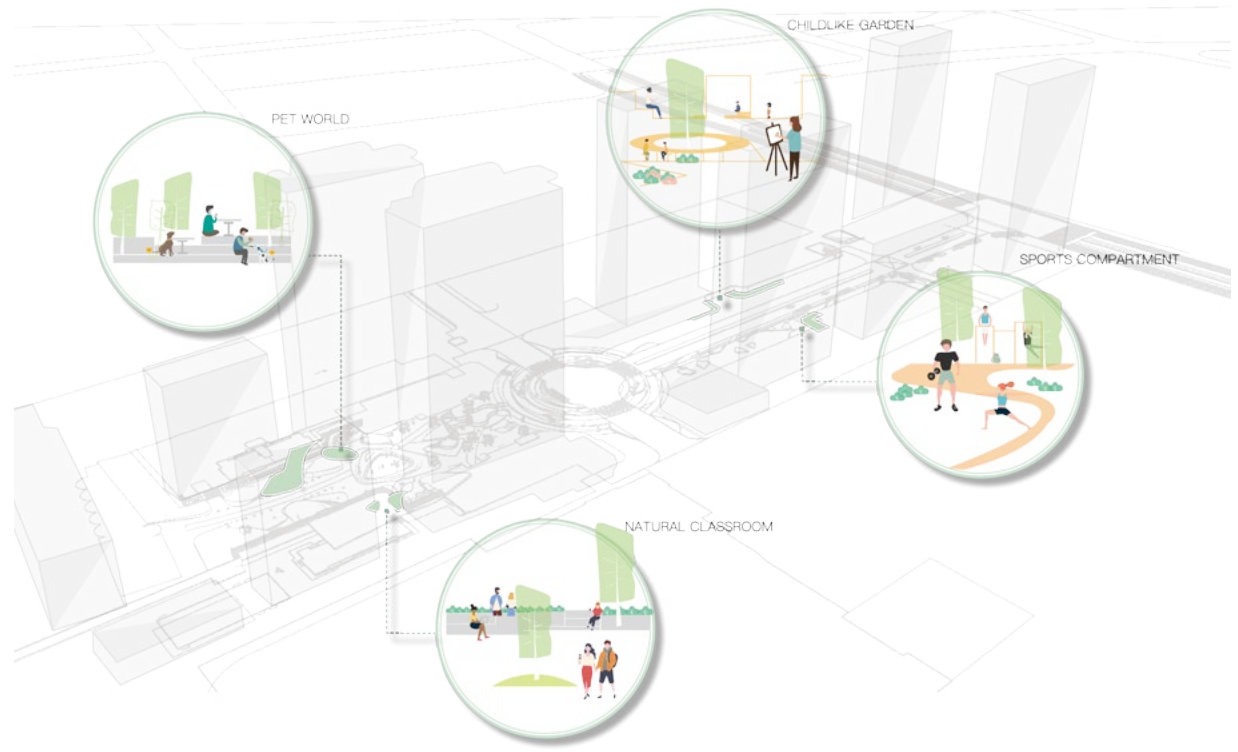

SECTION OF THE STREET



The cloud viewing platform where people can stay and relax to enjoy the surrounding scenery is open and inclusive. People can enjoy a panoramic view of the entire Dengyun Road and experience the beauty of nature as it changes from season to season. Under the sunlight, the platform stands like a white cloud in the woods, making it a unique landscape.





The sunken recreational plaza has a fountain in the center, which is combined with the surrounding landscaped seating to create a social place for the community. People can hold concerts, art exhibitions, weekend bazaars and a variety of other events here so that people can build community connections and find their own fun in city life. Surrounded by greenery at the border of the sunken plaza, the corner of the space features a number of pet recreation facilities, providing a place for pets to move around freely. The pet-friendly space is not only a place for pets to have fun but also for owners to share their experiences and stories.



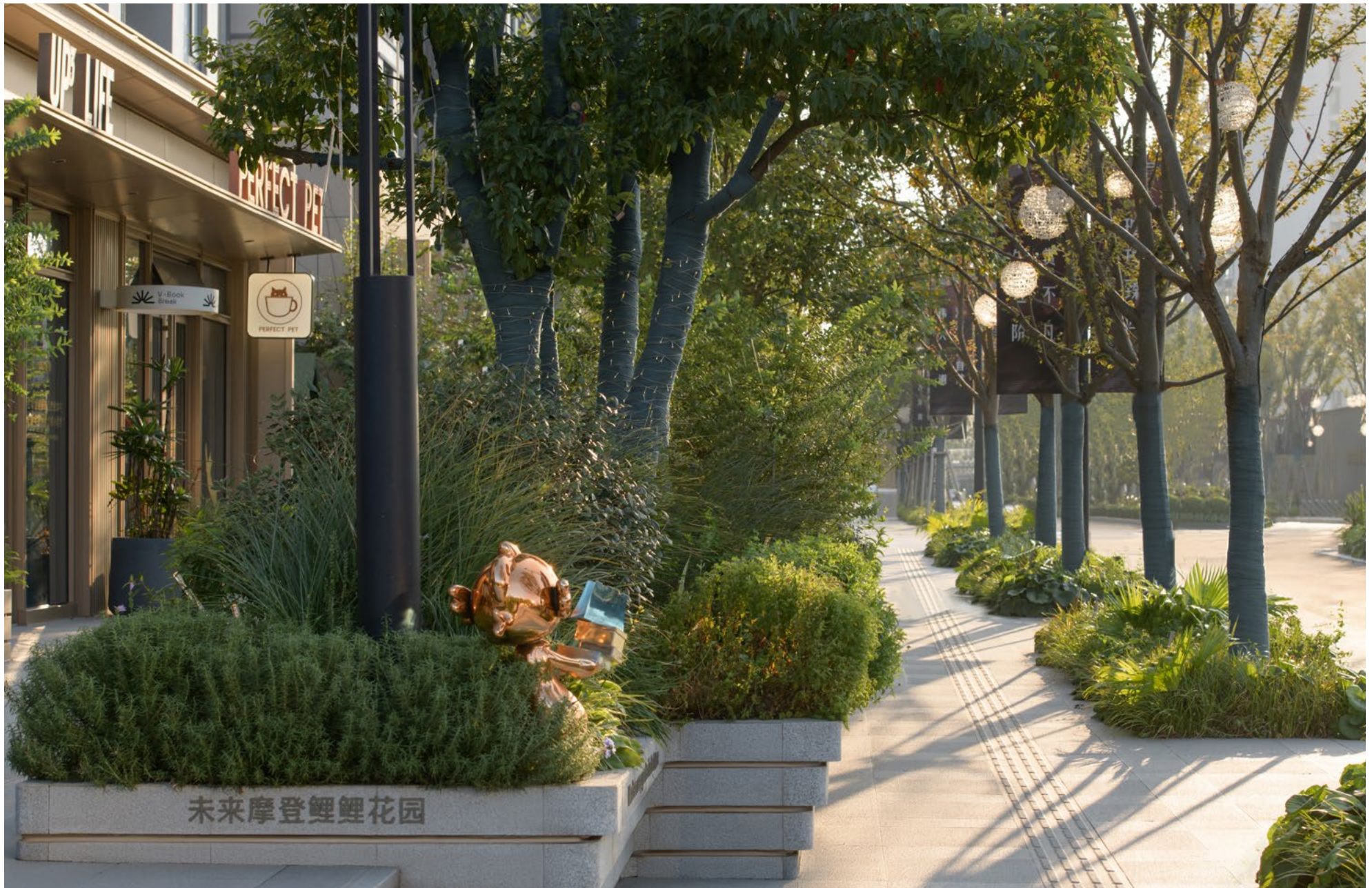

Stroll through the garden street to feel the tranquility and nature, the street is lined with lush trees, branches and leaves form a natural barrier, with a variety of wildflower meadow blooms in the flow of four seasons, adding rich color and vitality to the street.



The commercial storefronts along the street seem to be part of the forest under the cover of trees, where you can sit down with a cup of coffee and quietly enjoy the relaxed fashionable life of LOHAS.



Residential fences are set back to create corner pocket gardens and incorporate children's wonderland, sports warm-up bins, pet zones, and nature classrooms, allowing artistic living to brighten the streets and add interest.



THANKS