

# SINBANPO RAEMIAN



- Project location : Banpo-daero 333, Seocho-gu, Seoul, South Korea
- Landscape Area : 47,967.83m<sup>2</sup>
- Construction Period : 2020.04~2023.08



A modern apartment building with a large digital screen displaying a field of yellow flowers, surrounded by trees and a rocky landscape with a waterfall.

## Project Statement

Sinbanpo Raemian is a large apartment complex with 2,990 households and about 10,000 residents. It is located in Gangnam of Seoul, the center of Korea, in close proximity to Korea's representative park called Han River Park, making it a popular complex frequented by local residents.

Sinbanpo Raemian wanted to boost the vitality of the community by mitigating the disconnectedness within most apartments built in recent years and allowing various people to stay and interact with each other in an open space saluting everyone. Through such open landscaping of Sinbanpo Raemian, we have improved the complex residents' quality of life, while allowing all members of the community to experience various natural sceneries and communicate in them.

In this project, we tried to counteract the lingering issues of Korea's most common residential type – apartment complexes – the main culprit of disconnecting the local community through landscaping and thereby increasing the resiliency of the community.



# □ Project Narrative and Contents

## • Site Analysis

Sinbanpo Raemian is a residential complex common in Korea that borders several other apartment complexes. It is also adjacent to the Han River Park, which has about 25 million annual visitors. Sinbanpo Raemian has been here for a long time since its construction by demolishing and merging two dated apartment complexes into one. And it is also located in Gangnam, the center of Seoul.

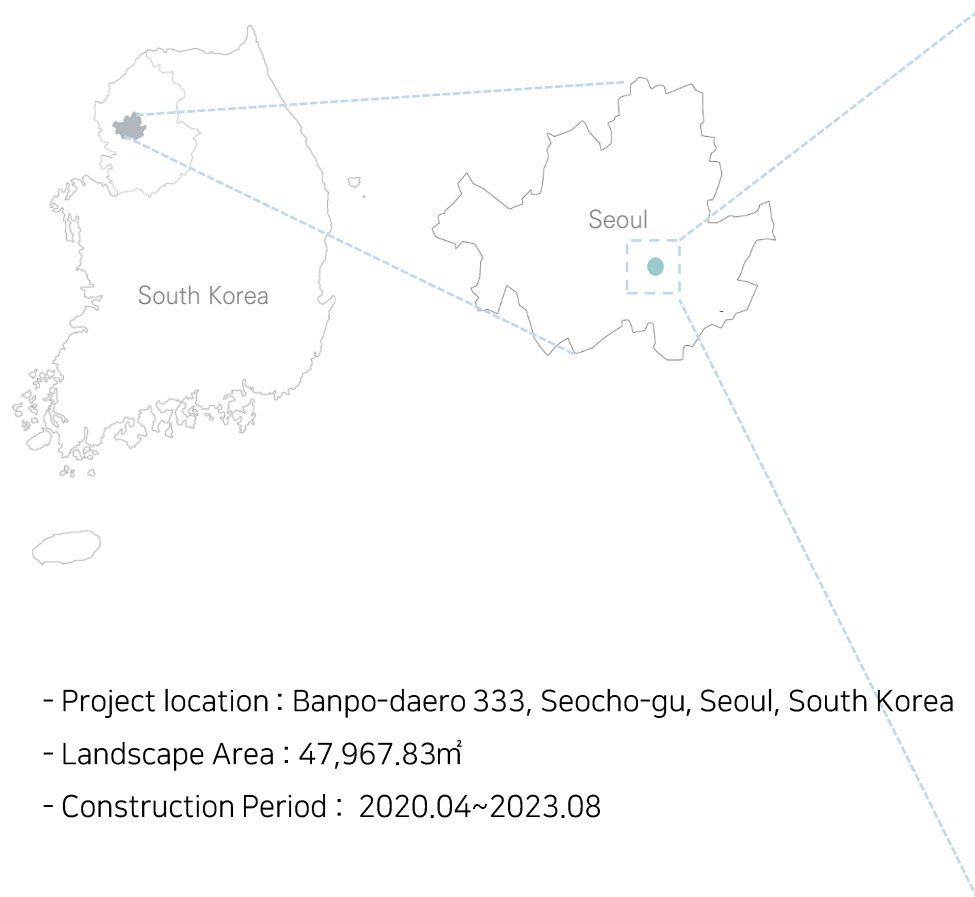

# Project Narrative and Contents

- Background

Seoul has one of the highest housing prices in the world. Gangnam in particular boasts the highest housing prices in Seoul. 30 percent of jobs in Seoul are present in Gangnam with numerous companies, large hospitals, and shopping centers, recording the largest floating population in Korea. For this reason, housing prices in Gangnam have been rising every year, and the gap with other regions has also been widening.

The high housing prices in Gangnam have made closed housing environment, restricting access to residents only. It has blocked the inflow of people into the complex and allowed only residents to use the facilities within it. This has cut off communication among residential complexes and blocked the movement of community in daily life. This has reduced the vitality of the community, hence the resilience of the society.



The street of Gangnam / People waiting for subway to go to work in Gangnam

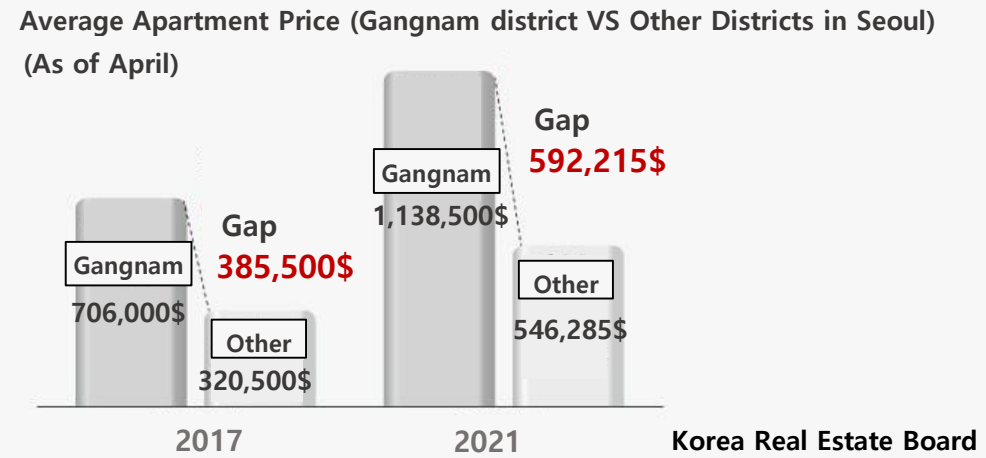

The gap between housing prices in Gangnam and other districts of Seoul is growing.

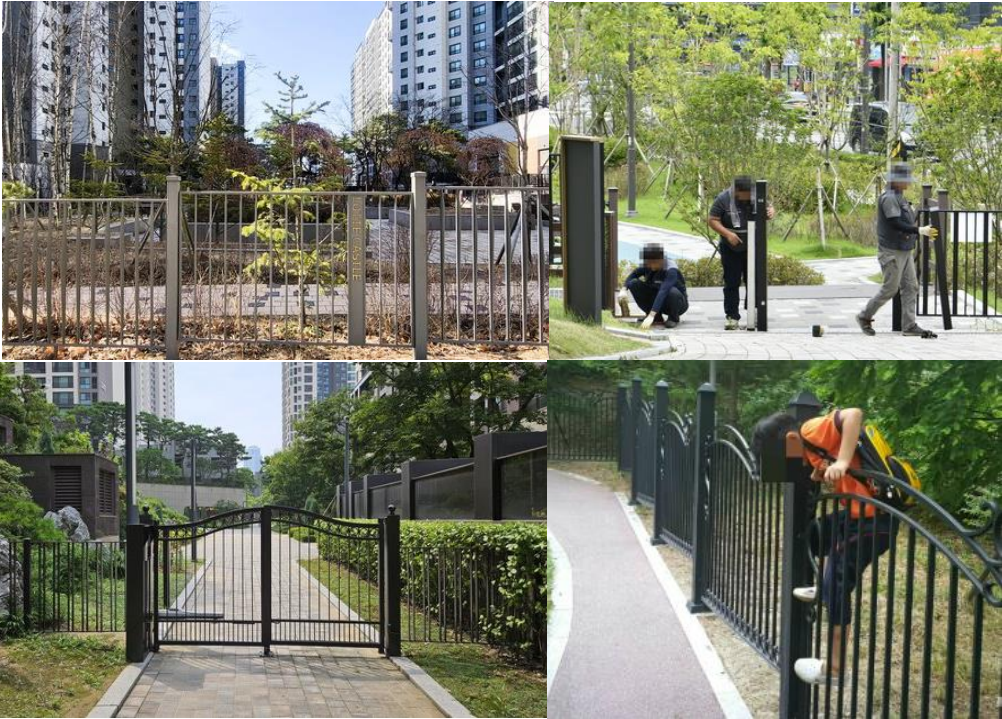

Apartment complexes are becoming a wall that cuts off community.



# □ Project Narrative and Contents

- Design Intent

Sinbanpo Raemian wanted to create an open space for everyone, instead of building yet another closed apartment residential complex, and to offer a place where anyone could stay and experience its various offerings. By opening the space to the public, we wanted to encourage the community interaction and boost its vitality.

Through this, we wanted to pave the way for a better residential culture in Seoul and show that apartment complexes can be spaces for nurturing healthy communities. Furthermore, we contemplated over how the common form of residential complex in Korea -apartments– could take part in increasing the resiliency of society.

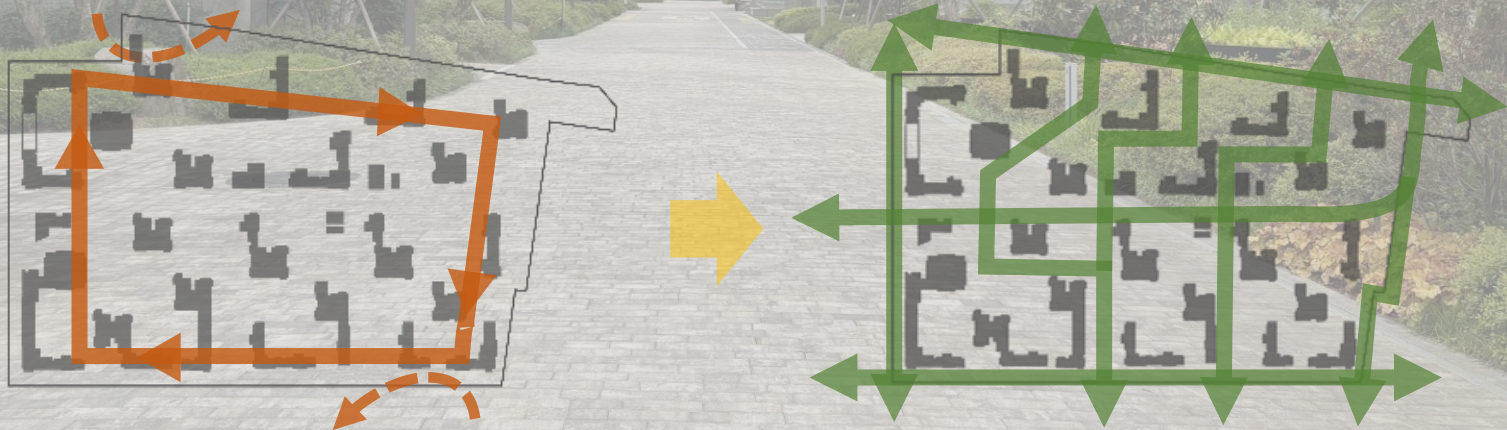



# □ Project Narrative and Contents

## • Plan

Residents of the apartment participated in the design stage in an effort to create an apartment complex indeed for the community.

In reflection of the demand, many public walkways were added in the complex to optimize the flow of movement throughout the passages.

In particular, not only the ground but also underground public walkways were designed – directly connected to local infrastructures such as subways and parks. In addition, by designing a space dedicated to landscaping right beside the walkway, it functions more than just a simple road but also a space where everyone could stay and relax in comfort.





# □ Project Narrative and Contents

- Design Strategy 1. Connection

To make Sinbanpo Raemian easily accessible to everyone, many public walkways have been installed both on and under the ground. It is designed to connect all roads inside and outside naturally so that all roads can function as public walkway. In addition, most of the public walkways were set to be less than 2% slope to make it more user friendly especially for the elderly and physically impaired people.

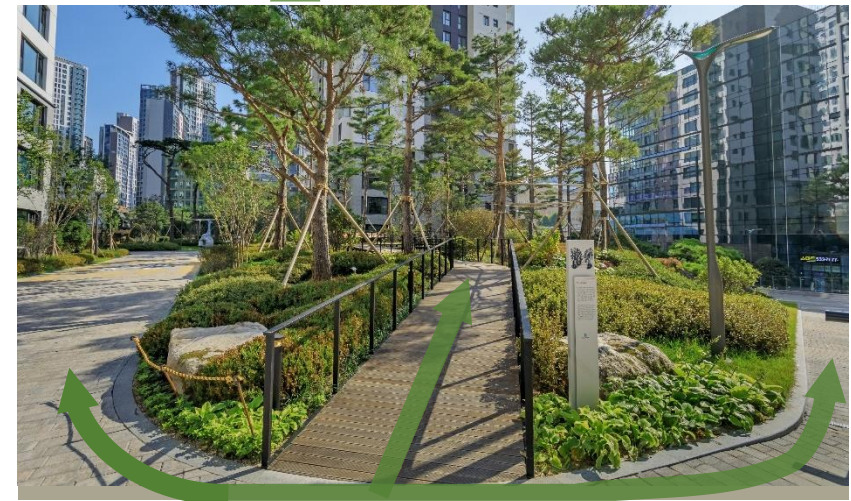
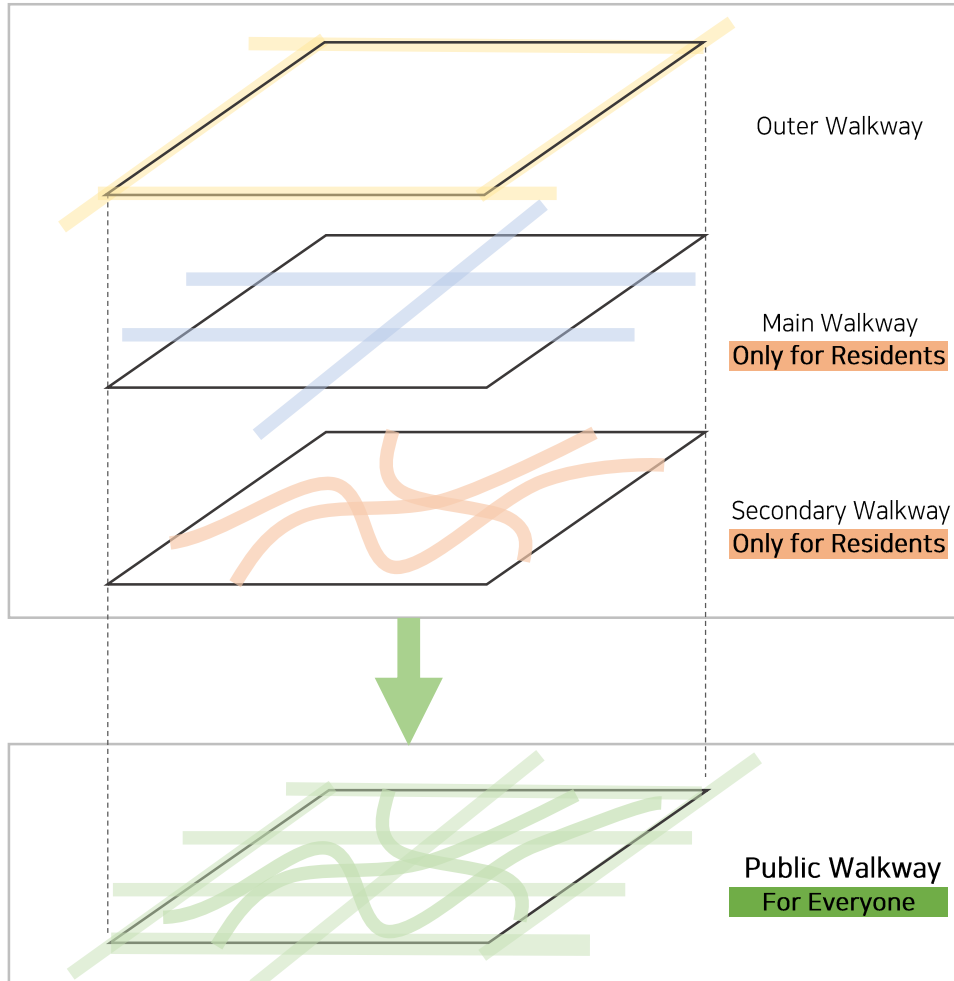



# Project Narrative and Contents

- Design Strategy 1. Connection

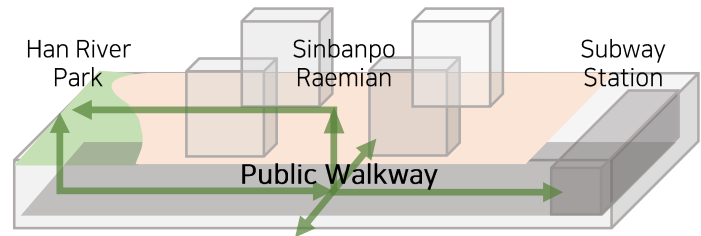
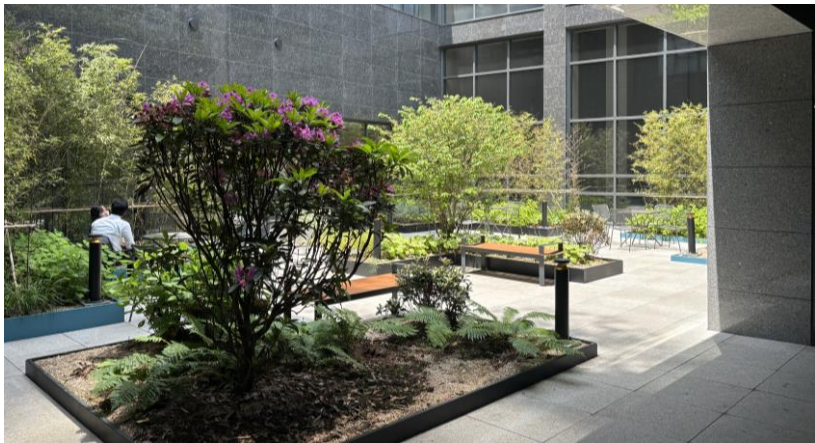
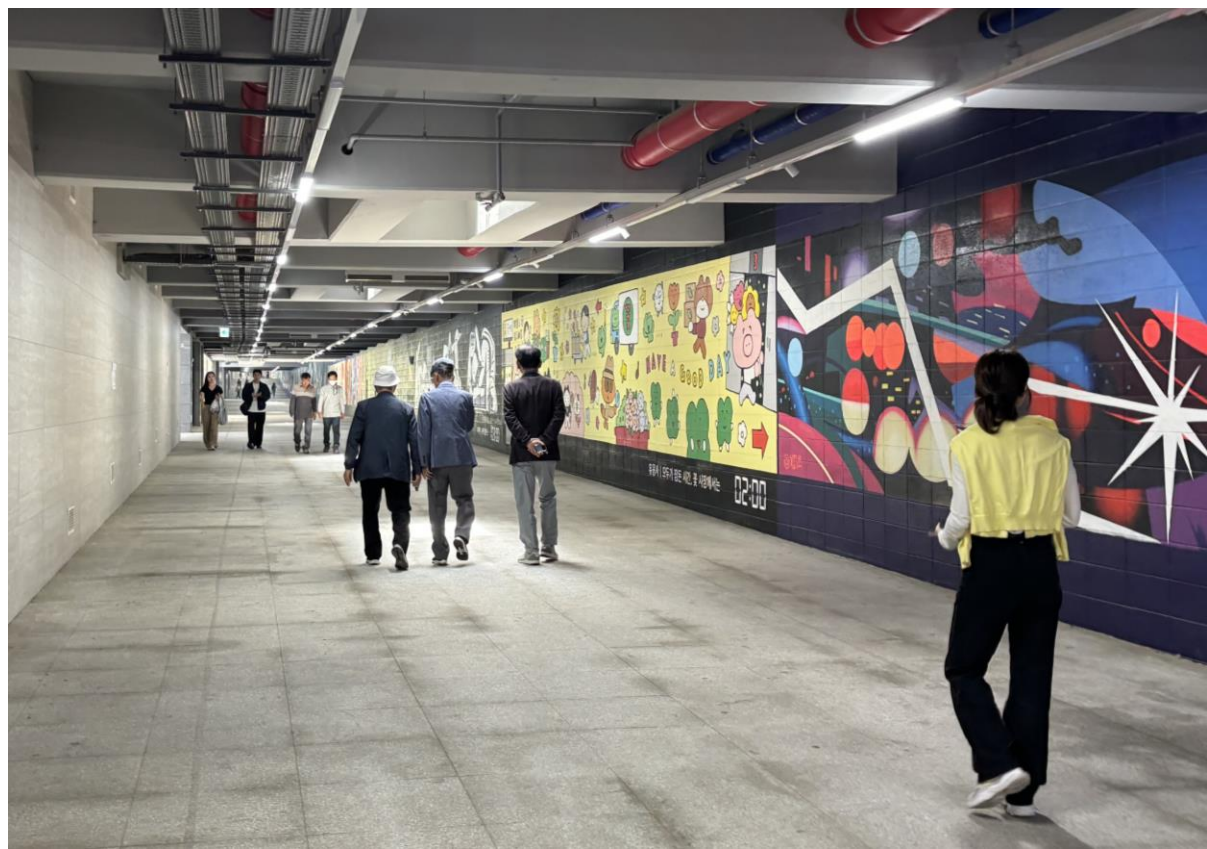

In the case of the underground passage, it was designed to connect from subway stations all the way to parks. By creating several resting areas in the middle of the walkway with many green spaces, we wanted people to enjoy the walk itself to the park. In addition, collaborating with 24 artists, we tried to provide artistic attractions to passengers by installing murals covering 24 hours of Seoul on the walls of the walkway.



# □ Project Narrative and Contents

- Design Strategy 2. Experience

This project aimed to make a public walkway into a space where people can have unexpected experience, unlike usual pathways to simply pass by.





# □ Project Narrative and Contents

## • Design Strategy 2. Experience

The Scape Sansu is designed by using the big space in the apartment complex. The Scape Sansu was created by a modern reinterpretation of Jin-gyeong Sansu, a traditional landscape depicting method of Korea. This is also the first of all apartment complexes in Korea to introduce a large display using LED module. Sinbanpo Raemian opens this space to everyone so that they could enjoy the media together, share memories, and bond more.

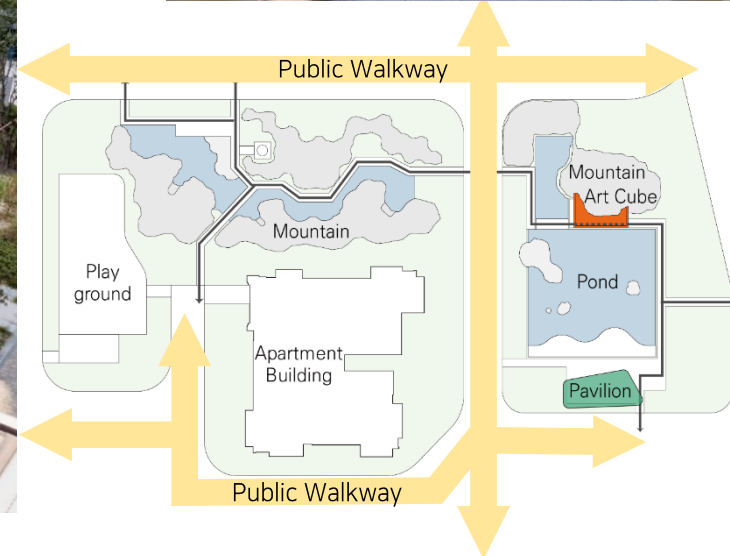



# Project Narrative and Contents

- Design Strategy 2. Experience

For more experience, we decided to utilize the geographically-derived elevation difference, which is usually seen in Korea, in an unforeseen way; we tried to apply various strategies on sites with elevation differences to create an unexpected space.

Before

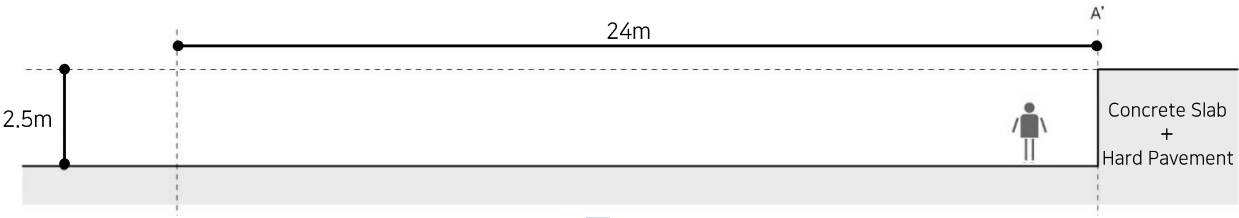

After

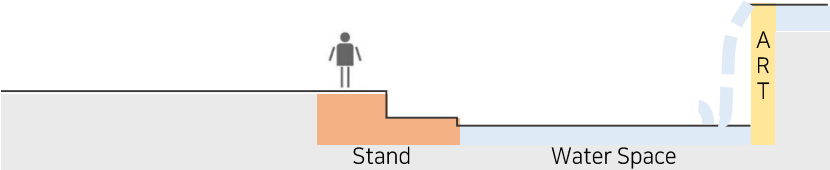
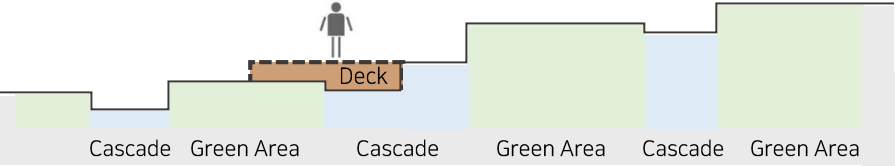

Green Cascade



Water Lounge



# □ Project Narrative and Contents

- Design Strategy 2. Experience

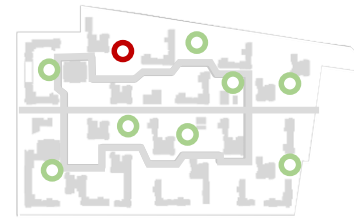

In Green Cascade, a large space of land with high elevation difference was divided into small units to create a small waterfall with mystical atmosphere using mist to manifest a small forest vibe in the city center.



# □ Project Narrative and Contents

- Design Strategy 2. Experience

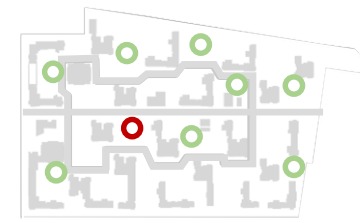

In Water Lounge, the high elevation difference was fully utilized to create a water fountain with an accentuated falling scene. Also, by installing artworks in the background of the water fountain, a special space was created to view static artworks in a new way.



# □ Project Narrative and Contents

- Design Strategy 3. Memory

Sinbanpo Raemian is a place where many people will live together for a long time. Therefore, we wanted to provide a space for everyone to communicate and interact with each other in comfort. To this end, many rest areas were created adjacent to public walkways so that any local resident could stay here with ease for a long time.





# □ Project Narrative and Contents

- Design Strategy 3. Memory

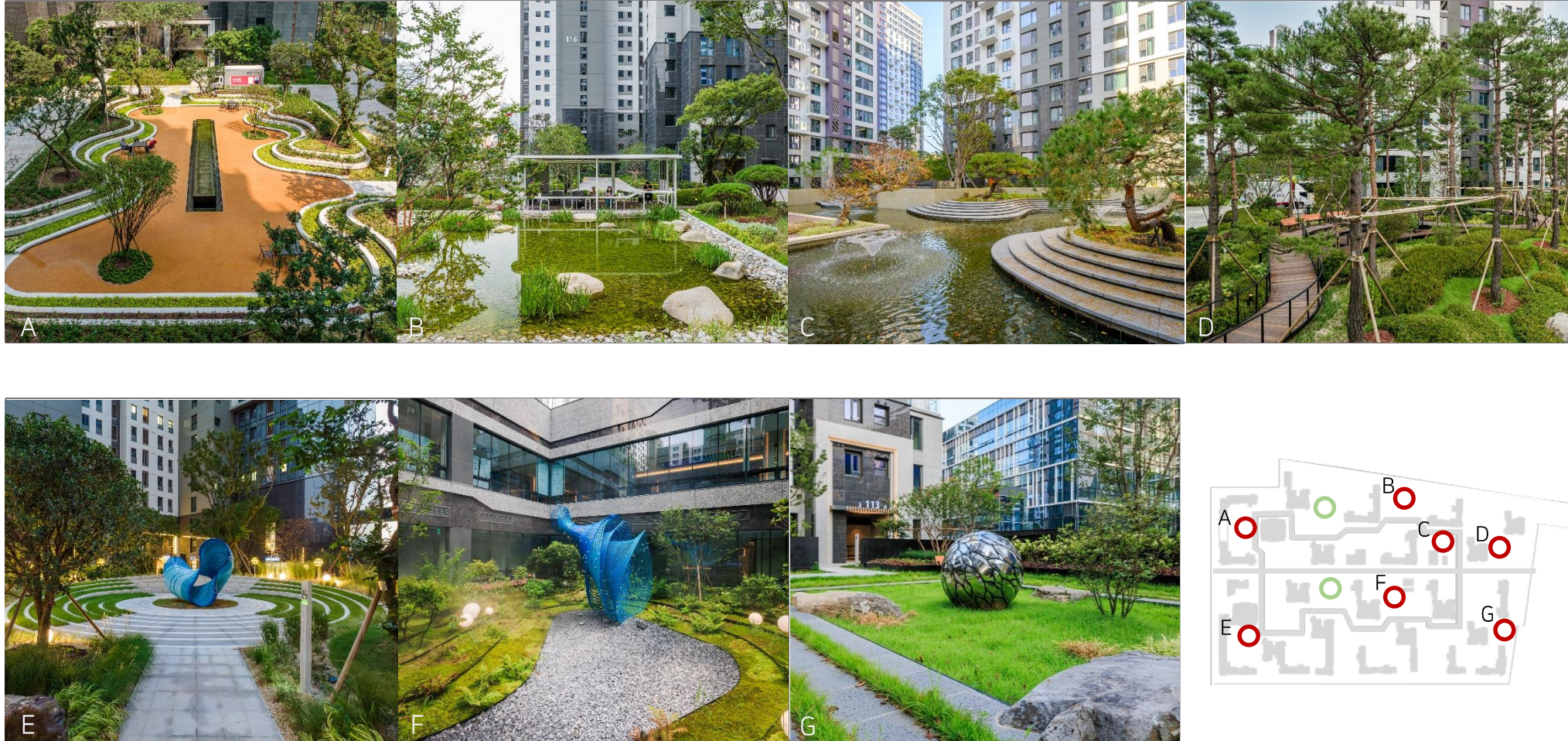

Through various spaces with natural elements as motifs, we tried to offer various ways to take a rest in nature from a different angles and amplify the vitality of everyday life.



# □ Project Narrative and Contents

- Design Strategy 3. Memory

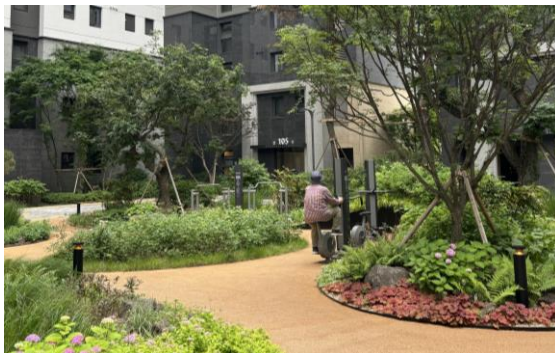
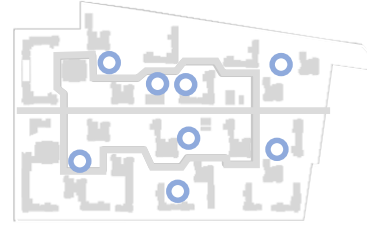

In addition to a simple break, three themed exercise areas were created so that local residents could exercise together and take care of their health.

Also, eight playgrounds were created so that children in the community could play and have a happy time together.





## □ Outro

Sinbanpo Raemian is a project in itself where local residents participated and worked together to ameliorate the negative image prevalent within the existing apartment community. It is a project in which we tried to ponder upon the direction to follow as an apartment complex in favor of the local community with a fresh attempt to open the complex for everyone. We hoped the landscaping of Sinbanpo Raemian could contribute toward improving health and happiness of the local community.