

Yanluo Sports Park

Transformation of Construction-Waste Dump in a Post-Industrial Context

Project Statement

Yanluo Sports Park is located at a triangular waterfront site in a certain bend of Maozhou River in Shenzhen. Elevated walkways enclose several depressions, where *plazas, sports fields, leisure cafes, sports stations, ecological wetlands and other functions are arranged.*

Corridors connect the main walking paths, providing shelter from the sun and rain, breaking the singular relationship between isolated buildings and the site. Instead, the design reinterprets the patchy landscape of mountains and rivers in the region while *establishing closer connections between urban functions and the site, also serving an ecological role in regulating stormwater.* The overlapping grid extends towards the city, providing service facilities such as plazas and parking lots; towards the river, it incorporates the wetland into the site, combining it with cantilevered platforms of the box culvert embankment *to create an inviting waterfront space.*

The design reshapes the terrain, creating ridges as the backbone of corridors traversing the site. Recessed areas formed by the terrain are *embedded with various urban functions according to different elevations and scales, providing multi-level ecological retention functions. The result is a green complex that opens up to the city.*



Site and Context Analysis

The site is located on a triangular piece of land by a bend in the Maozhou River in Shenzhen.

The riverbanks feature typical Pearl River Delta urban landscapes. Villages from the agricultural era rise in situ, surrounded by densely packed low-rise industrial factories and workers' dormitories. Mountains and rivers appear as patches and arteries on this base map. The *design employs an overlapping and interlocking layout pattern*, using elevated walkways to enclose a series of low-lying areas that inspired by the region's landscape of mountain ranges and river patches.

The site was originally a construction waste dump, surrounded by industrial factories and forgotten by the northern community. The complex terrain is concave overall and elevated on the western side.

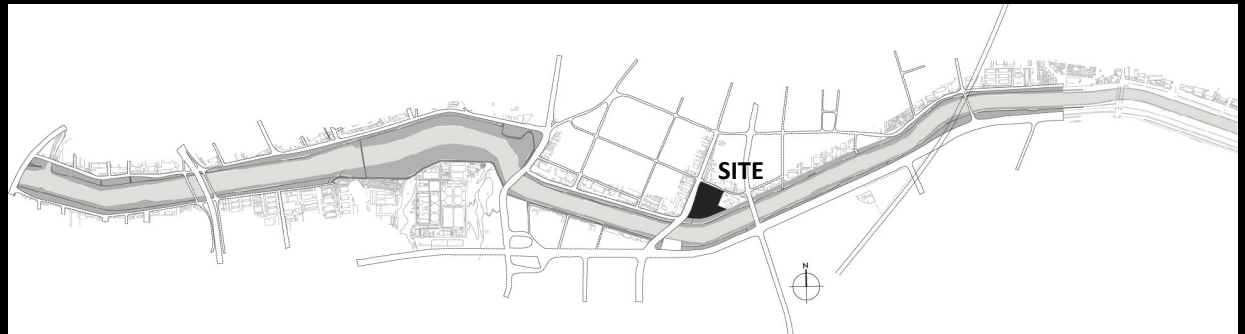



Project Significance: Post-Industrial Ecological Landscape Restoration

The Maozhou River is one of Shenzhen's mother rivers, with typical Pearl River Delta industrial urban landscapes along its banks. Yanluo Sports Park, formerly a riverside waste dump, is a typical example. The park is open to surrounding workers and other urban areas, providing *a high-quality public space for the local industrial workers and community residents.*



before



after

Concept

Ribbing and Duckweed

The site presents an overall concave state, defined by the northern mountain and the embankment road, while the western side features partially interrupted earth slopes due to garbage accumulation. The design reshapes the terrain, creating ridges as the backbone of corridors traversing the site. Recessed areas formed by the terrain are embedded with various urban functions according to different elevations and scales, providing multi-level ecological retention functions. This design resembles the ridges separating fields and duckweed floating on still water, constituting the distinctive site features of Yanluo Sports Park, a green complex.



Design Strategy

The design strategy, based on the concept of "Ridge and Duckweed" and emphasizing *"relationship-oriented"* prompts us to determine the spatial prototype: *forming "fields" in areas with sparse relationships and "gaps" in areas with dense relationships*. Diverse functional demands, complex elevation relationships, and convergence to "gaps" are considered. Given the park's water retention and purification functions, landscape structures are used to convey the intention of the "gaps," serving as structural horizontal components and *integrating considerations of urban relations, landscape form, and physical experience*.



Innovative Functions: Ecological function and typological innovation

Traditional sports parks often present a singular image, with scattered facilities surrounding a track. Yanluo Sports Park breaks this fixed typology by *grasping the site's terrain and creating an interwoven layout*. Ridges serve as the backbone of corridors traversing the site, and recessed areas formed by the terrain are embedded with various urban functions according to different elevations and scales, *contributing to the typology of sports parks while providing composite ecological functions*.



1. Former Mode of Sports Park

--Juxtaposition of Wet Land, Rest Station and Sports Yard

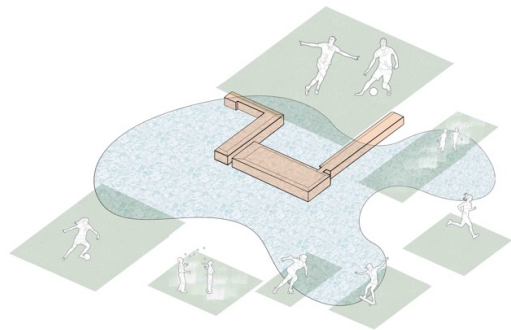

2. Staggered and Interwoven Mode

--Multi-Function, Landscape Penetration and Wandering Walk Paths



3. Ribbing and Duckweed

--A ridge as the Skeleton of the Corridor crossing the Site and enclosing Sunken Depressions

游廊 Wandering Corridor

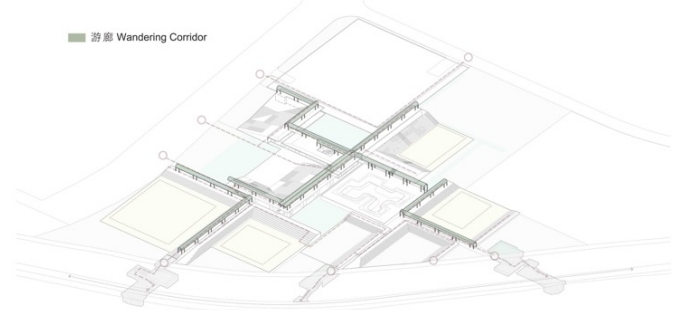

4. The Corridor System

水面 Water
滨水平台 Waterfront Platform
开放空间 Open Space

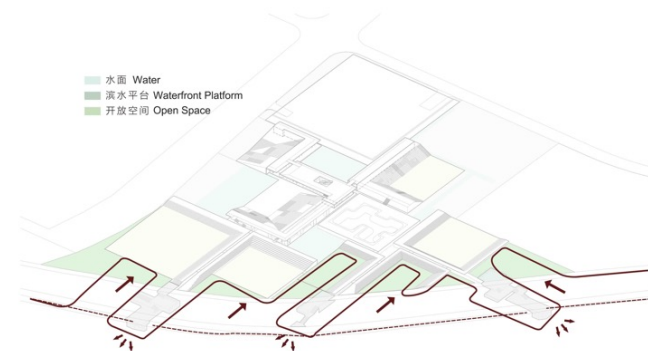

5. Waterfront Platforms connecting the Park with Mao Zhou River



Enhancing riverside landscape quality and improving the ecological environment

The design follows the site's existing conditions and enhances the riverside landscape by reshaping the terrain and embedding ecological retention ponds. The ponds not only serve as a natural water purification system but also improve the overall ecological environment of the park. The park's landscape design *prioritizes native plant species and the creation of diverse habitats, encouraging biodiversity and providing a haven for local wildlife.*





Utilizing local materials and recycling construction waste

The project seeks to *minimize its environmental impact by utilizing local materials and recycling construction waste* wherever possible. This approach not only reduces the need for transportation and the associated carbon emissions but also helps to reduce waste on site.



Providing high-quality public spaces for local community

Yanluo Sports Park is an urban park that encompasses a variety of sports facilities, urban squares, parking lots, and more. Industrial workers gather but lack public spaces for communication, interaction, and sports. The park provides them with *high-quality, dignified public spaces*.



Improving the ecological environment

Yanluo Sports Park includes a detention pond feature that purifies water quality, allowing urban rainwater to naturally infiltrate, thereby *improving the ecological environment* around the Maozhou River and promoting *the construction of sponge cities*.

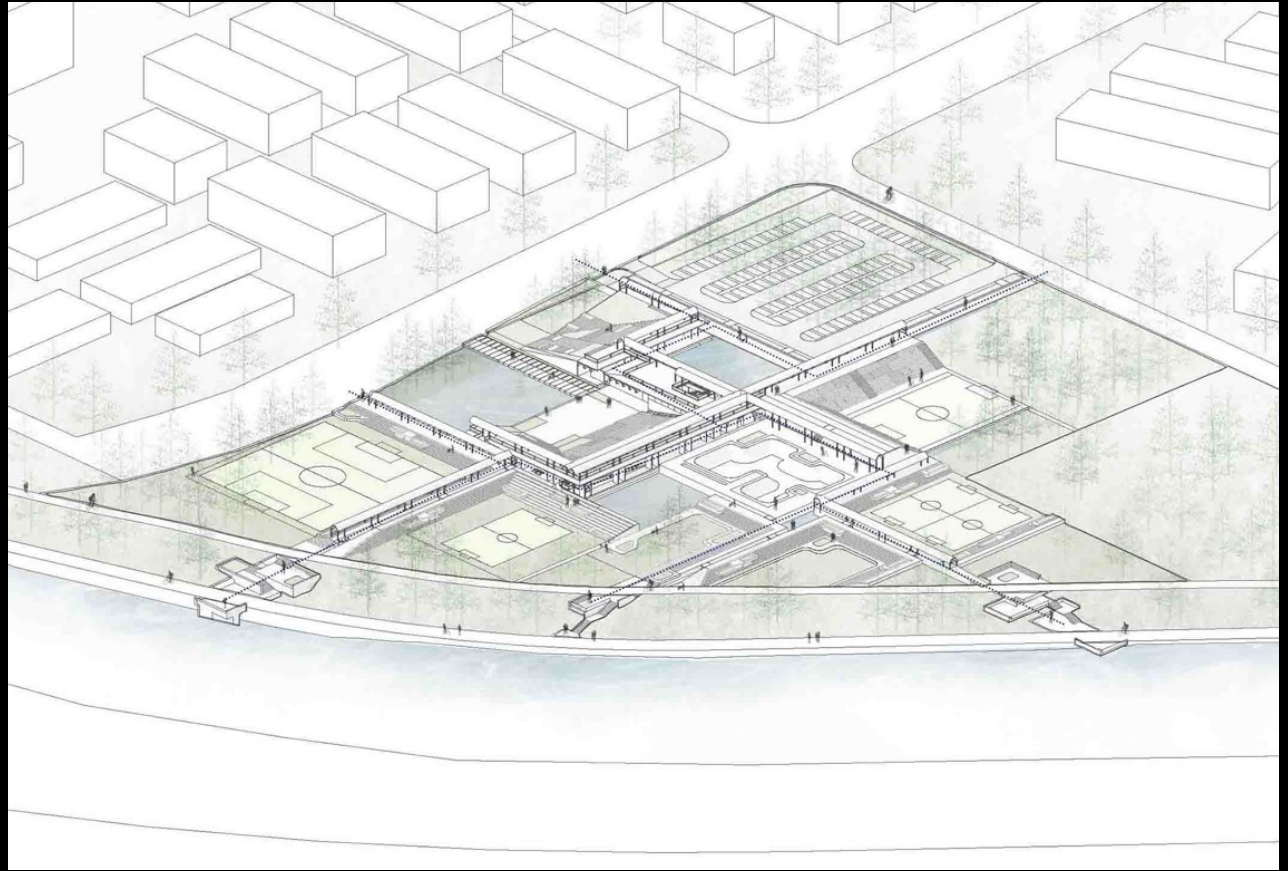

Less is more

Yanluo Sports Park adopts simple and unadorned structural language, *reducing construction costs and saving national resources* while forming spatial areas.





Multiple Functions

Different elevations and scales of depressions are *embedded with various urban functions* and wetland parks, including urban squares, sports fields, leisure coffee shops, sports stations, parking lots, etc., addressing the shortage of regional cultural and sports facilities and the demand for rainwater storage raised by the water authority. The raised field slopes form a corridor skeleton that connects all the facilities while allowing the entire sports park *to connect with waterfront spaces and urban spaces, making openness truly possible.*





User experiences and feedback

"Before, there was nothing here, and it was very inconvenient. Now with this sports park, we have a place to play ball and such. After dinner, taking a walk with my family feels great, the environment is good, and the Landscape is beautiful."

"This park is unique; it's a bit like *when we were kids running on the ridges of the fields*, up and down, very fun. There's a large square, a sports field, and a beautiful wetland park, which is *very welcoming to the public*."

