

SHUANGHE LAKE CENTRAL PARK

LEADING CITY CENTRAL PARK -- PROMOTING DEVELOPMENT OF SURROUNDING AND UNDERGROUND SPACE

PROJECT OPPORTUNITY

LEADING CITY CENTRAL PARK -- PROMOTING DEVELOPMENT OF SURROUNDING AND UNDERGROUND SPACE

IN 2017, ZHENGZHOU HELD THE 11TH CHINA INTERNATIONAL GARDEN EXPO. THE MAIN EXHIBITION AREA OF THE EXPO IS LOCATED IN THE AIR HARBOR AREA, CLOSING TO SHUANGHE LAKE. HENCE, IT PLANS TO DESIGN SHUANGHE LAKE PARK INTO THE EXHIBITION AREA B, ATTEMPTING TO LINK DOUBLE EXHIBITION AREAS THROUGH THE MEIHE RIVER AND ROADS. ZONE B IS CREATED INTO AN EXHIBITION AREA WITH REGIONAL CULTURAL CHARACTERISTICS AND IT IS USED FOR ENTERPRISE EXHIBITIONS AND PLANNING EXHIBITION HALLS. THE TOTAL PLANNED AREA OF ZONE B IN THE GARDEN EXPO IS 149.1HA, INCLUDING 104.3HA OF THE GREEN AREA AND 44.8HA OF WATER AREA. THE ACTUAL GREEN AREA OF LANDSCAPES IS AROUND 122.1HA. THE TOTAL INVESTMENT IS AROUND 1.01 BILLION RMB.

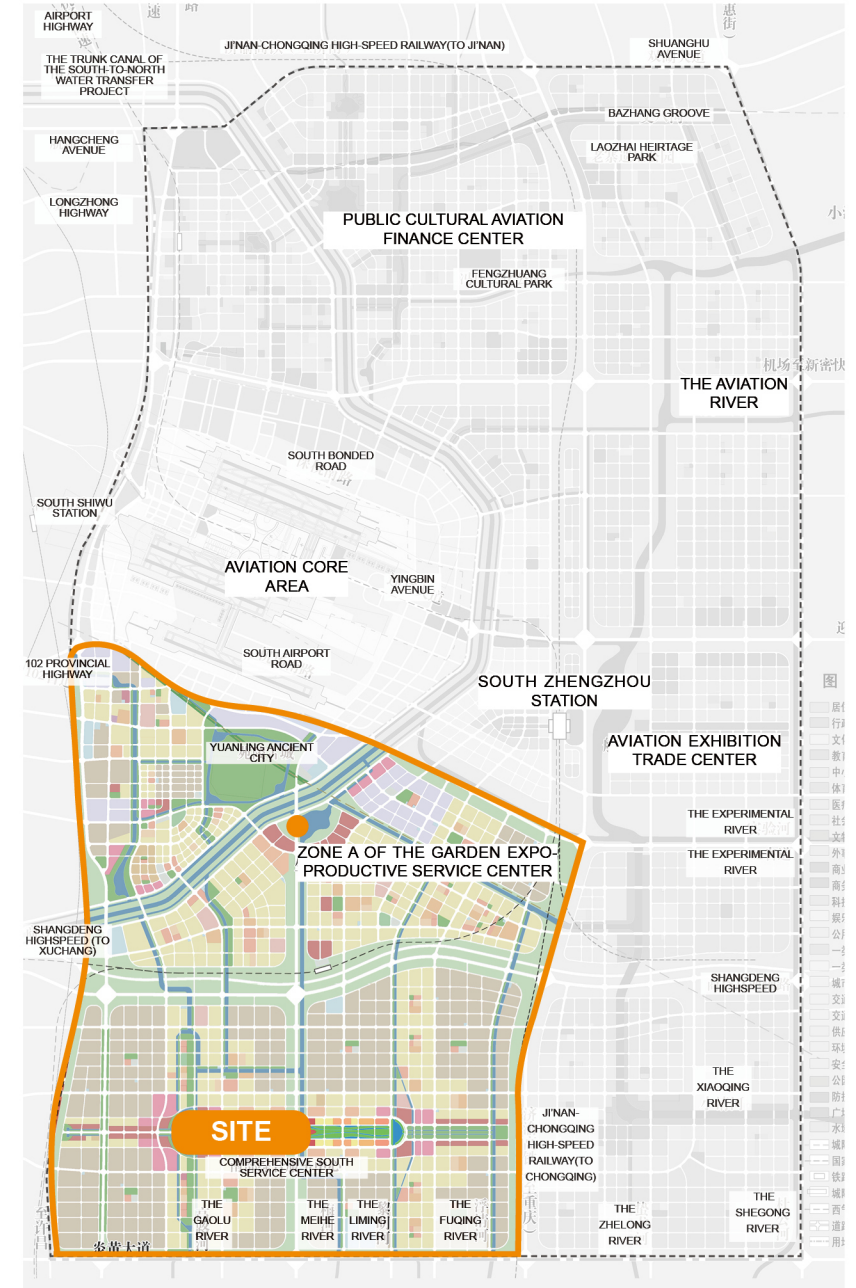
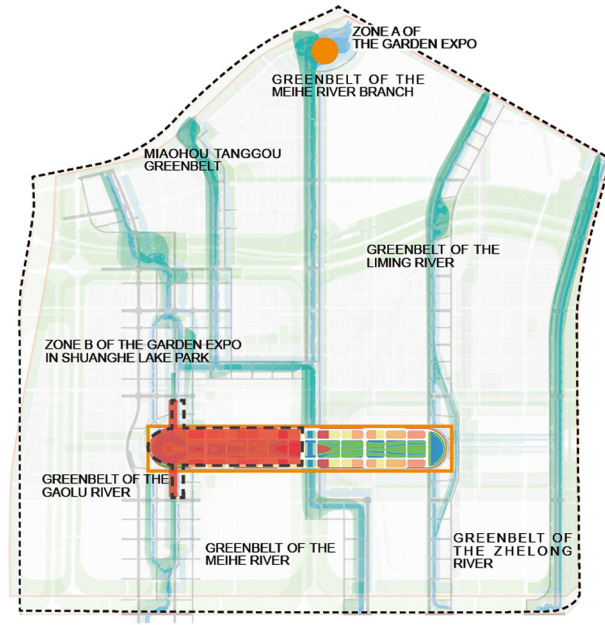
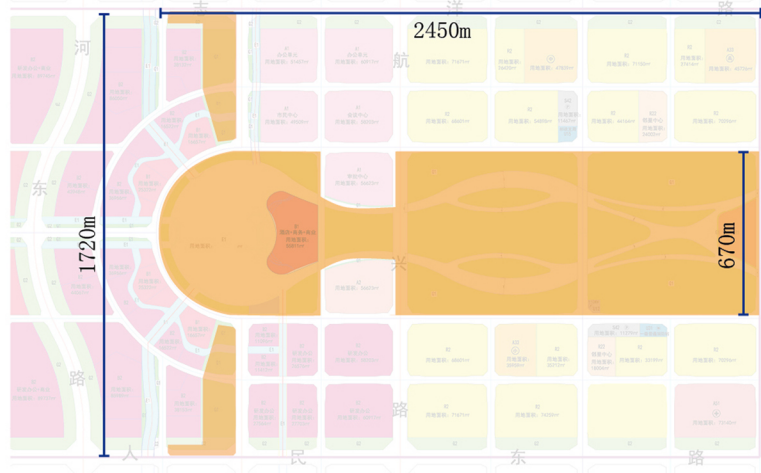

DESIGN FEATURES

THE GENERAL LAYOUT

The Crane Lake

The Crane Lake

THE CENTRAL PARK OF SHUANGHE LAKE FULLY EMBODIES LOCAL CULTURES DURING THE DESIGN PROCESS. THE DESIGN INSPIRATION OF THE “SHUANGHE LAKE” IS ORIGINATED FROM “LOTUS CRANE SQUARE POT”, THE TREASURE OF THE HENAN MUSEUM AND THE BRONZE WARE EARTHED FROM XINZHENG AREA, ZHENGZHOU. THE ABSTRACT MODELING OF THE “CRANE” IS COMBINED WITH WATER AND TERRAIN TO DESIGN THE PARK AS A WHOLE.

WISDOM SMART CITY

WISDOM SMART CITY

THE SITE’S TEXTURE IS ORIGINATED FROM THE EXTENSION OF LANDSCAPE RELATIONSHIP IN CENTRAL CHINA AND MAKES THE CENTRAL PLAINS’ TOPOGRAPHIC FEATURE ABSTRACT INTO A LANDSCAPE LANGUAGE. THE WATER TEXTURE EXPLAINS MUTUAL DEPENDENCY OF CITIES AND WATER; THE TEXTURE OF GARDENS AND HILLS CAN DISPLAY THE UNIQUE STYLE AND FEATURE OF HILLY LOESS TABLELAND; THE TEXTURE OF FLOWERS AND FIELDS SIMULATE NUMEROUS FOOTPATHS IN THE OPEN FIELD FROM THE VISION.

LOTUS CRANE SQUARE POT
[THE REPRESENTATIVE OF CENTRAL PLAIN SYMBOLS]



MORPHOLOGICAL IMPRESSION
[THE LANDSCAPE RELATIONSHIP IN CENTRAL CHINA IS EXPOUNDED INTO THE OVERALL TEXTURE]



INNOVATIVE PERFORMANCE
[INNOVATION OF FUNCTIONAL POSITIONING; CENTRAL BUSINESS PARK OF THE CITY]



INTERFACE EXTENSION
INTERFACE POSITIONING+ GUIDANCE CONNECTION

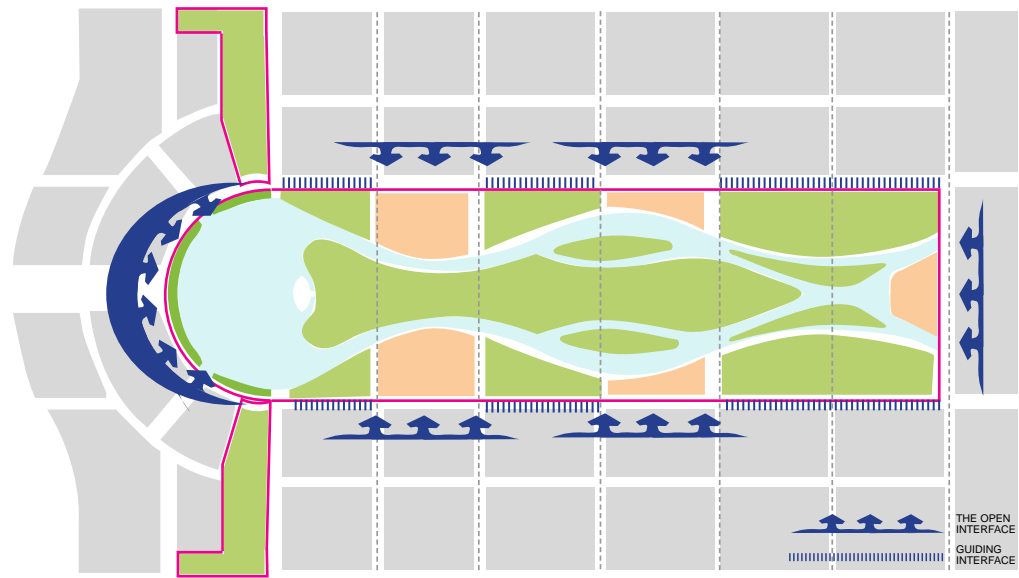

FUNCTION INTERACTION
MULTIPLE ACTIVITIES+ SUBSEQUENT UTILIZATION

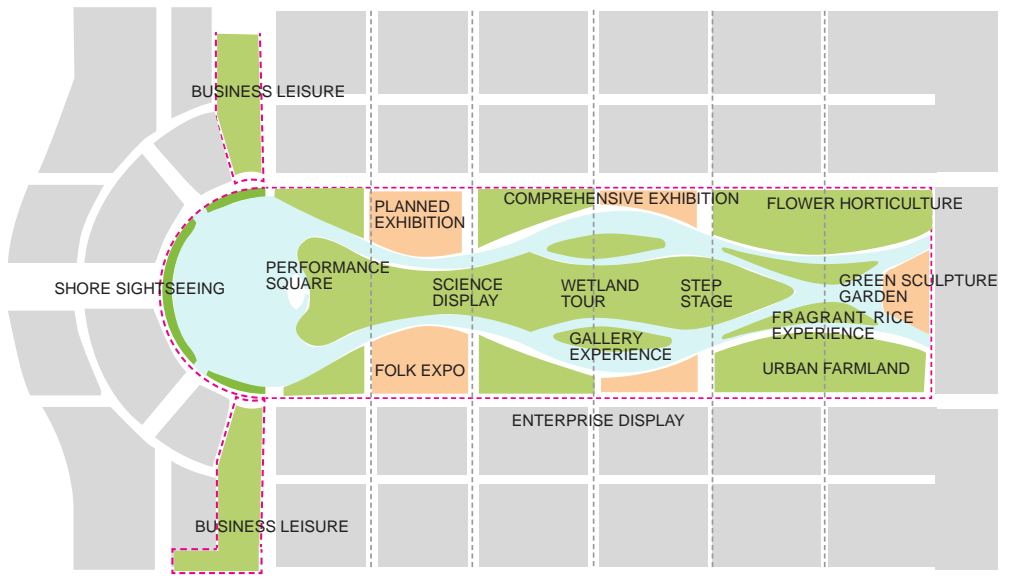

AXIAL EXTENSION
VIRTUAL-REAL SYNTHESIS+ VERTICAL ORDER

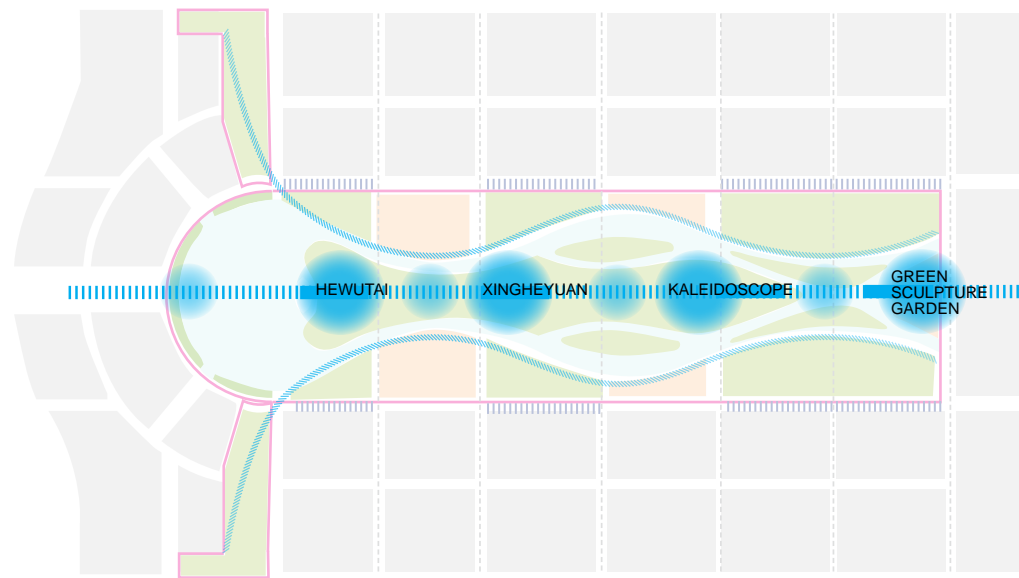

SUSTAINABLE ECOLOGY
URBAN SPONGE+ SMART RAINWATER

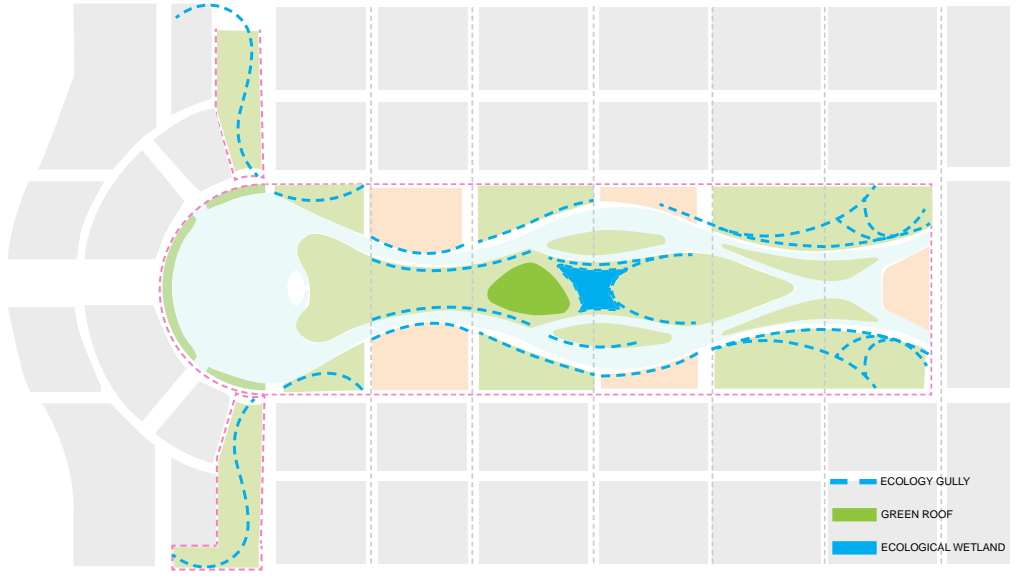

DESIGN FEATURES

SPACE LAYOUT

THE LANDSCAPE DESIGN IN THE CENTRAL PARK OF SHUANGHE LAKE STRONGLY RECOMMENDS THE AXIS ORDER. COMBINING WITH THE VERTICAL SPACE LEVEL OF VERTICAL GROWTH, THE AXIS IS CLEAR AND STRETCHING. IT IS A URBAN CENTRAL PARK WITH ORGANIC GROWTH TO MANIFEST FEATURES OF CENTRAL PLAINS.

TWO BELTS OF ONE AXIS

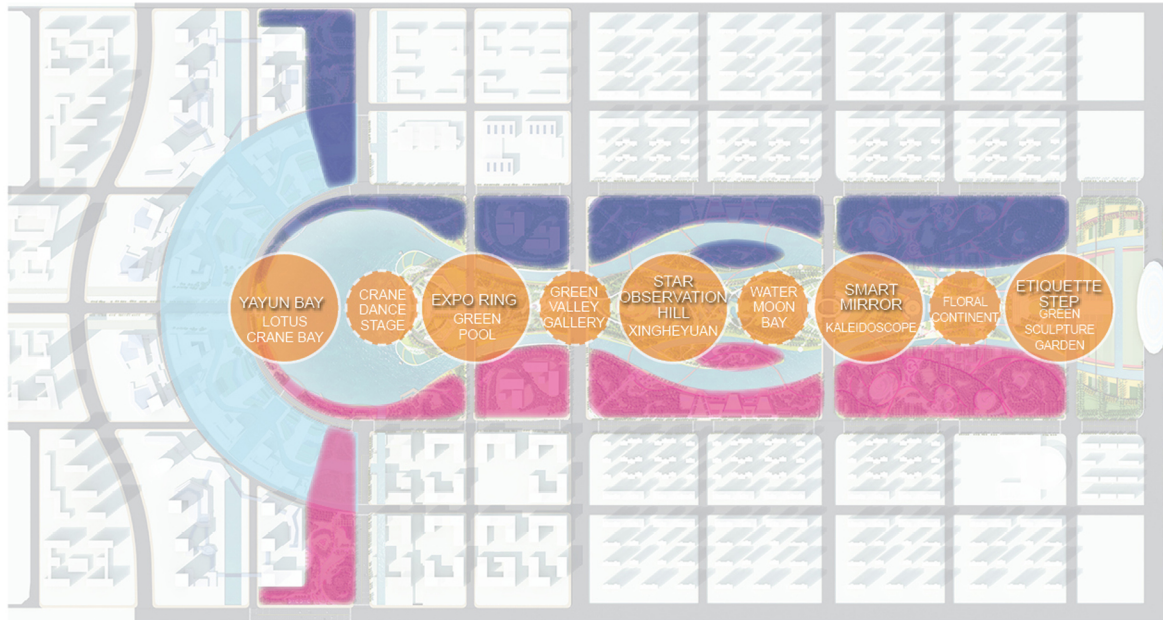

DIVERSIFIED FEATURES IN THREE ZONES

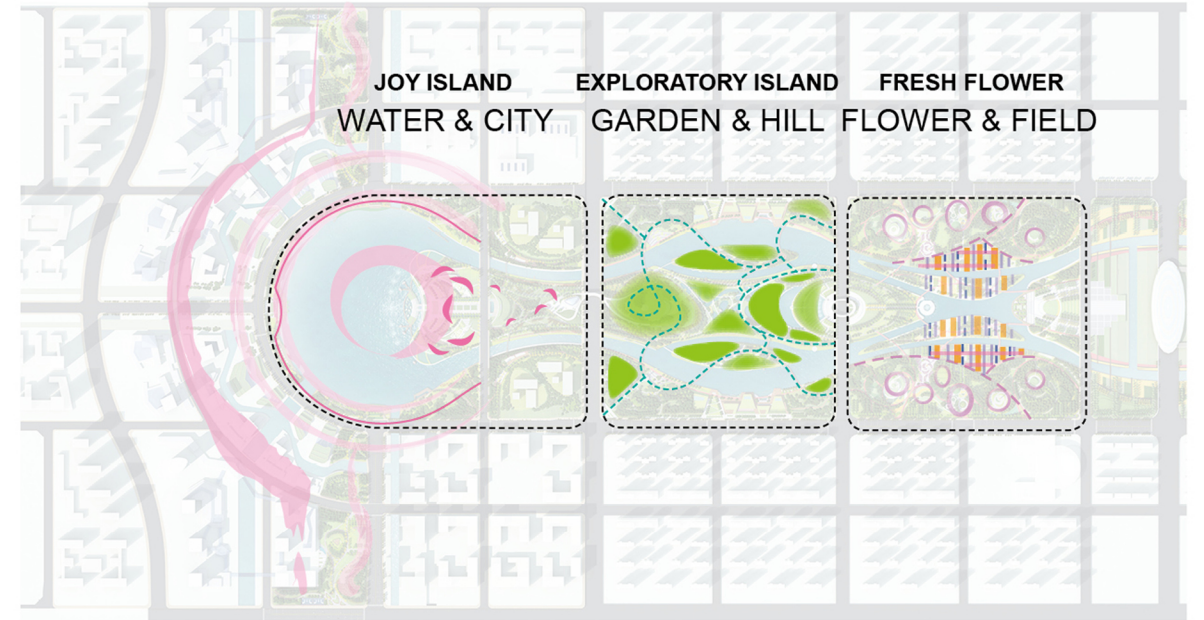

DESIGN FEATURES

SPACE LAYOUT

THIS SCHEME ADOPTS THE LAYOUT WITH SYMMETRIC BALANCE TO SET OFF THE PARK'S GRAND SCALE AND MAGNIFICENT CENTRAL PLAINS CULTURES. WITH THE AXIS, SERIES OF PARK AREAS ARE LINKED IN SERIES, SHOWING RHYTHMIC CHANGES. AT THE SAME TIME, THE SCHEME LOOKS FOR A BALANCE FROM BREAKING AND DESTROYS SYMMETRY IN MESOSCALE AND MICROCOSMIC DESIGN, NOT CONFINED TO THE STRICT SYMMETRIC CONTROL. THE SCHEME MAKES INNOVATIONS ON PERFORMING CENTRAL PLAINS' SYMMETRIC PARKS WITH THE LARGE-SCALE AXIS, UTILIZES THE AXIS RELATIONSHIP AND THE OPEN INTERFACE WITH VIRTUAL-REAL SYNTHESIS, AND CREATES A MODERN URBAN PARK WITH GREAT POWER AND LANDSCAPE URBANISM TEMPERAMENT.

VERTICAL DESIGN

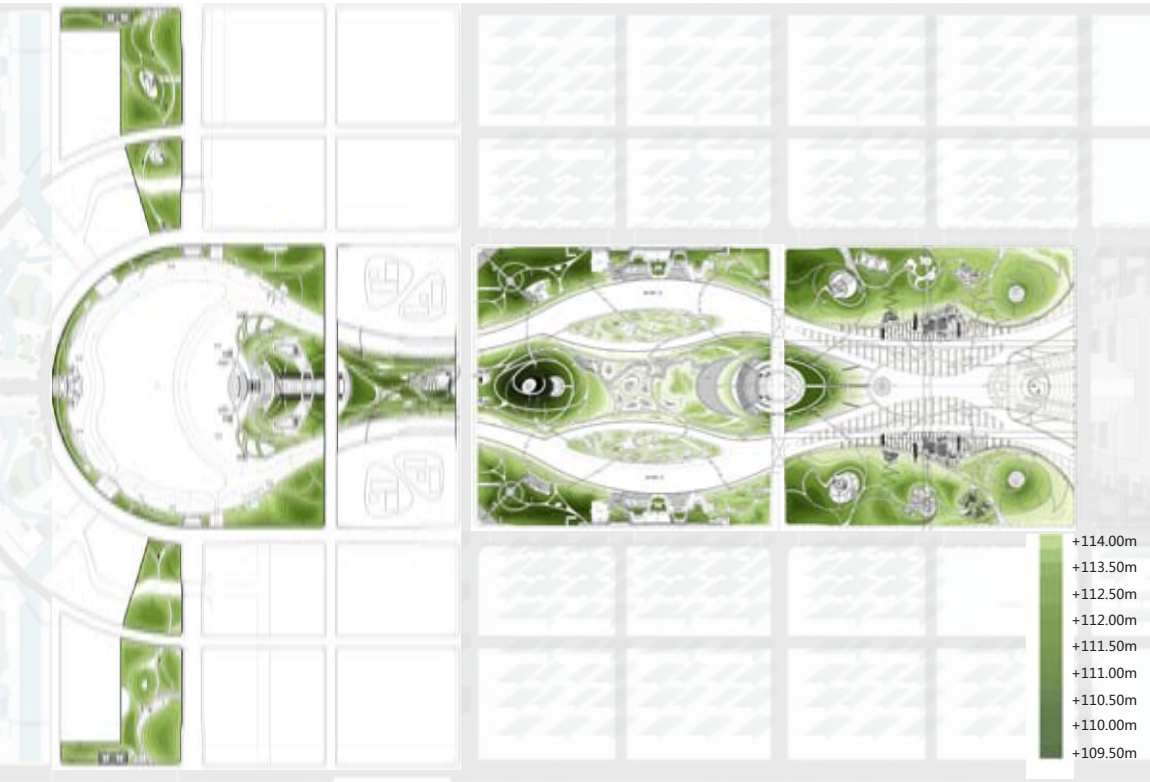

PLANTING DESIGN

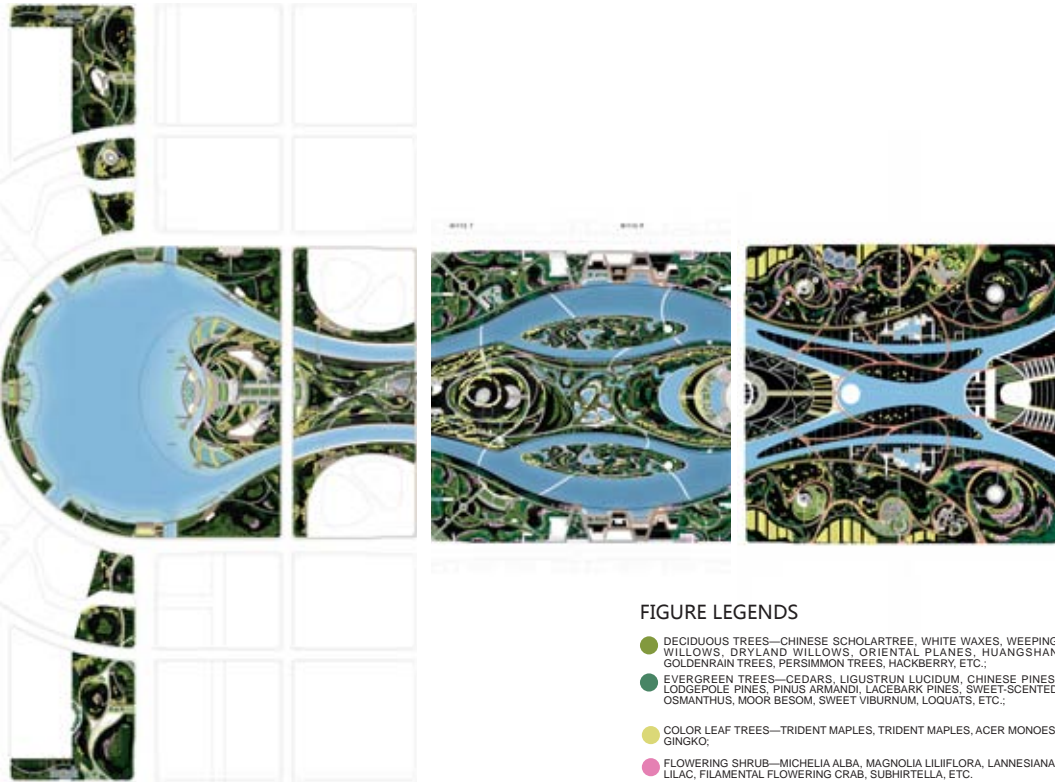

AERIAL VIEW



OVERALL AERIAL VIEW



DESIGN FEATURES

GREENWAY AND BRIDGE -- SUPERPOSITION OF THE HIGH LINE PARK AND THE CENTRAL PARK ON THE AXIS

THE PARK IS LINEAR SPACE STRETCHING TO THE EAST AND WEST DIRECTION, SHOWING THE LASTING WATER SYSTEM. THE ENTIRE SITE HAS THE ALTITUDE DIFFERENCE OF 13M FROM THE WEST TO THE EAST. THE CENTRAL GREEN HILL HAS THE MAXIMUM ALTITUDE DIFFERENCE OF 20M. TO COPE WITH ABUNDANT TOPOGRAPHY, THE GREENWAY AND BRIDGE ARE DESIGNED INTO THE COMPOUND AND STEREOSCOPIC GREENWAY SYSTEM TO REALIZE THE SUPERPOSITION OF THE HIGH LINE PARK AND THE CENTRAL PARK ON THE AXIS. THE BRIDGE SYSTEM IS CLOSELY COMBINED WITH THE PARK'S ABUNDANT VERTICAL DESIGN, INCLUDING THE URBAN MUNICIPAL BRIDGE, GREENWAY BRIDGE, AND THE LANDSCAPE BRIDGE. AS A PART OF THE PARK ROAD SYSTEM, THE BRIDGE WITH DIFFERENT STYLES AND FEATURES IS USED AS THE "POINT" TO LINK INTO THE "LINE" IN THE ROAD NETWORK STRUCTURE. BENEFITED FROM THE EARLY-STAGE PLANNING DESIGN AND CLOSE COORDINATION OF CONSTRUCTION, THE PROJECT HAS WITNESSED THE CONSTRUCTION PROCESS OF GOING WITH THE FLOW AND ACTING ACCORDING TO LOCAL CONDITIONS FROM THE DESIGN TO IMPLEMENTATION.





BIRDS' SONG FOREST







COGNITION EXPERIENCE PARK



COGNITION EXPERIENCE PARK





SPECIAL GARDEN DESIGN

THE BOTH SIDES OF THE AXIS IN THE CENTRAL PARK OF SHUANGHE LAKE IS ARRANGED WITH LOTS OF GARDENS AND EXHIBITION GARDENS, SUCH AS INTRODUCING THE AGRICULTURAL THEME GARDEN, AND EMBODYING LOCAL FEATURES OF HENAN AS THE AGRICULTURAL PROVINCE OF CHINA; THE ART GARDEN, THE PORCELAIN PARK, AND FRAGRANT RICE SOURCE CAN BE SUPPLEMENTED FOR THE FUNCTIONS AND EXPERIENCE OF THE CENTRAL PARK.

THE FRAGRANT RICE SOURCE UTILIZES THE GRID TEXTURE OF FARMLANDS, GUIDES WATER TO THE GARDEN, AND CREATES THE CHARACTERISTIC FARMLAND WETLAND MIXED WITH WATER, ROAD, FIELD, AND GARDEN, MAKING A BENEFICIAL ATTEMPT TO IMPROVE AND ENHANCE THE ENVIRONMENT IN CENTRAL PLAINS.

THE CHILD EXPERIENCE GARDEN IS FEATURED WITH FIVE-SENSE EXPERIENCE OF PLANTS. CHILDREN SHUTTLE BACK AND FORTH IN THE HEDGEROW LABYRINTH AND THE VANILLA GARDEN TO SMELL FLOWERY FRAGRANCE AND LISTEN TO BIRDS' SOUND. THE EXHIBITION HALL GARDEN WITH NEW TECHNIQUES IS CENTERED ON THE SEMI-OPEN BUILDING AND CAN CARRY OUT FRESH AND FUNNY PLANT EDUCATION EXPERIENCE IN IT.

A BIRD'S-EYE VIEW OF THE ART GARDEN



THE LIVE-ACTION PHOTO OF THE ART GARDEN



A BIRD'S-EYE VIEW OF THE FRAGRANT RICE SOURCE





A REAL-LIFE BIRD'S-EYE VIEW OF THE CHILDREN'S EXPERIENCE PARK



A BIRD'S-EYE VIEW OF THE NEW TECHNOLOGY EXHIBITION HALL



A BIRD'S-EYE VIEW OF THE PORCELAIN GARDEN



LANDSCAPE SKETCH DESIGN

SHUANGHE LAKE PARK HAS A LARGE COVERED AREA. MANY GARDEN AND SERVICE FACILITIES ARE CONSTANTLY IMPROVING AND UPDATING. IT WILL PROVIDE BETTER SERVICE EXPERIENCE FOR CITIZENS IN THE FUTURE.

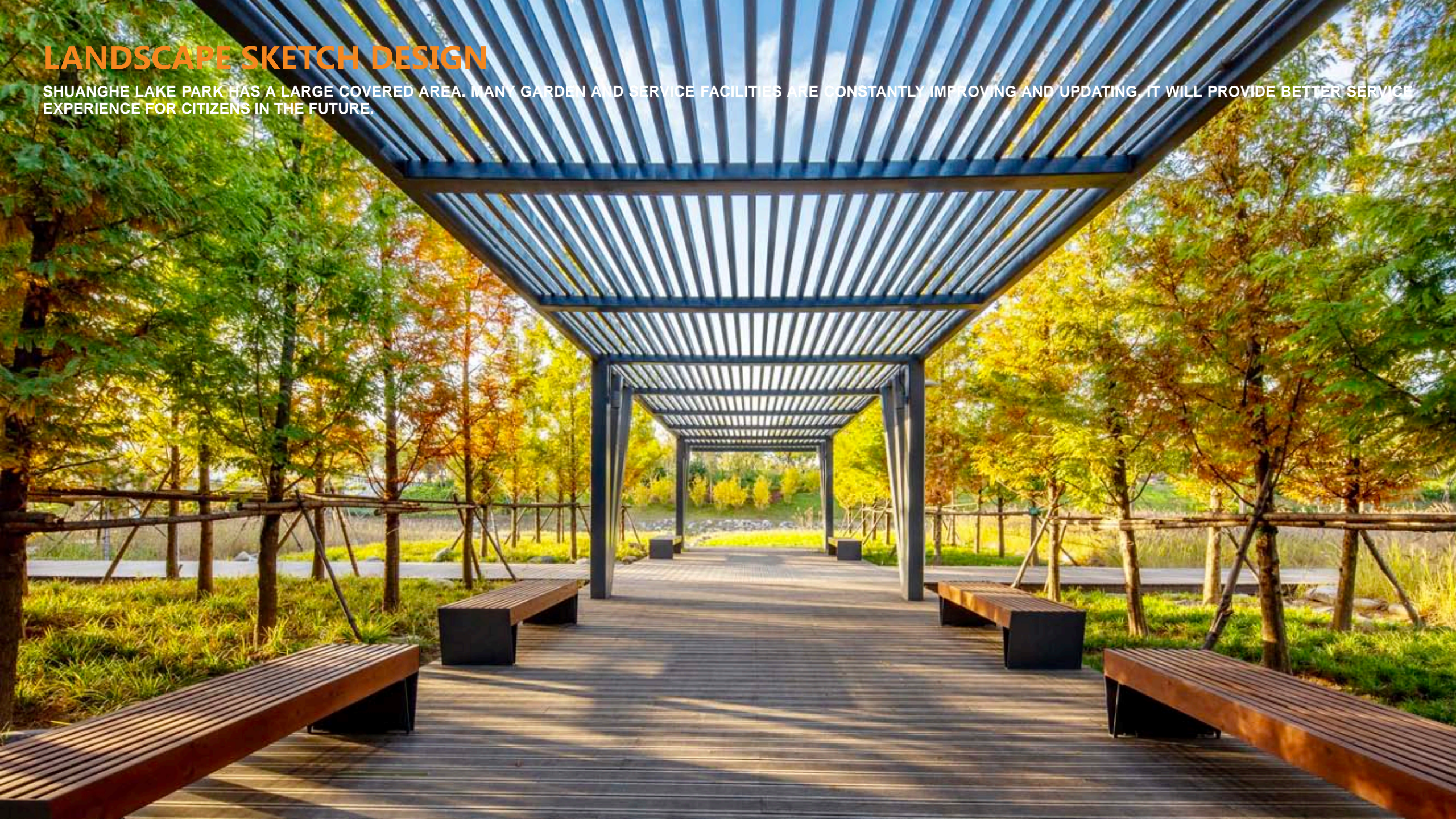



ECOLOGICAL DESIGN

RESTRICTED BY REGIONS, IN ORDER TO REALIZE THE BETTER LANDSCAPE EFFECT, PLANTING DESIGN MAKES A BREAKTHROUGH AND APPLIES NEW EXCELLENT VARIETIES AND THE NEW COMBINED PLANTING MODE. ALSO, IT COMBINES WITH RAINWATER GARDENS, WETLANDS, ECOLOGICAL REVETMENT, GRASS DITCHES, AND GREEN ROOFS OR OTHER SPONGE CITIES' FACILITIES, USES WATER-PERMEABLE PAVING MATERIALS IN A LARGE SCALE, AND FEASIBLY IMPLEMENTS THE GREEN DESIGN PHILOSOPHY OF SPONGE CITIES AND ECOLOGICAL CITIES.



THE LIVE-ACTION PHOTO OF WATERFRONT PLANT SPACE



FEATURED WATERSCAPE DESIGN

THE LARGE-SCALE SHADOW WATER CURTAIN COMBINES WITH THE AQUATIC LIVE-ACTION STAGE TO CONSTITUTE IN THE SYMBOLIC URBAN ENTERTAINMENT SPACE. AQUATIC LAMPLIGHT SHOW AND THEME PERFORMANCE OF SHUANGHE LAKE CAN ADD GORGEOUS MAGNIFICENCE TO THE CITY.



THE LIVE-ACTION PHOTO OF THE "KALEIDOSCOPE" ACTUAL-WATER THEATER

THE LIVE-ACTION PHOTO OF THE FOUNTAIN



ARCHITECTURAL DESIGN

THE PLANNING EXHIBITION HALL
THE ARCHITECTURAL FORM: COVERED BY THE LAND LANDSCAPE ARCHITECTURE, IT COMBINES WITH THE LIGHTING VENTILATION OPENING, UTILIZES THE UPWARD HOVERING OF TOPOGRAPHY FOR SIDELIGHTING, AND CREATES THE ARCHITECTURAL FORM GROWN FROM THE NATURAL ENVIRONMENT. DURING THE EXHIBITION PROCESS: PLANT IMAGE HALL AND CULTURAL EXHIBITION, AND BUSINESS EXPERIENCE CENTER. LATE-PERIOD UTILIZATION: THROUGH THE COMBINATION WITH THE UNDERGROUND SPACE, IT CREATES THE NATIONAL FITNESS CENTER OR THEATER AND BUSINESS CENTER.

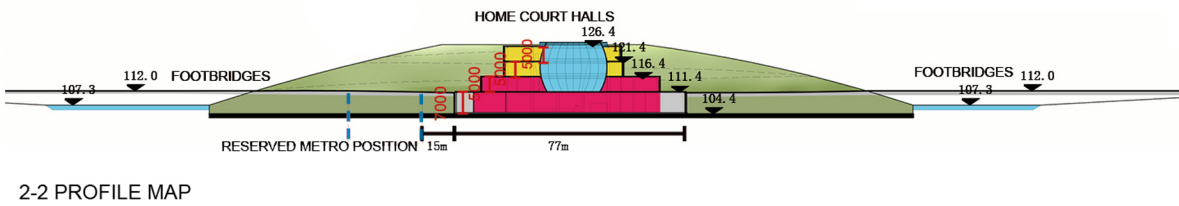
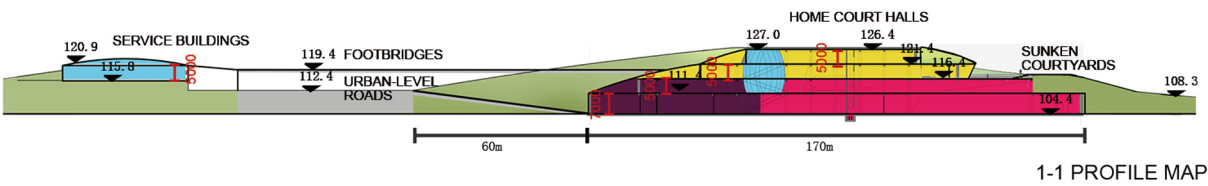

INDOOR LIVE-ACTION PHOTOS IN THE PLANNING EXHIBITION HALL

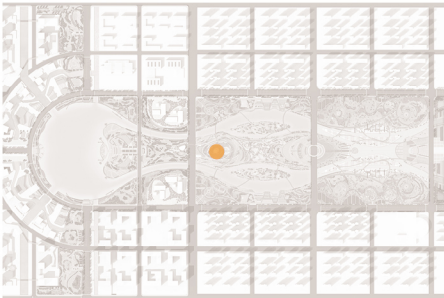

ARCHITECTURAL DESIGN

THE ENTERPRISE EXHIBITION HALL

THE ENTERPRISE HALL BREAKS THE SINGLE FORM OF REVETMENT TO PULL BACK OR STRETCH OUT IN LOCAL AREAS, ASSISTED BY ROCKY MOUNTAINS TO CONSTRUCT THE SKETCH, CREATES FUNNY CHANGES IN A TANGLED MESS, AND FORMS BENIGN INTERACTION WITH THE CITY AND THE WATERFRONT INTERFACE.

