

PROJECT TITLE

FROM AN AIRPORT TO AN EARTHPORT

A SUPER PARK COMPLEX IN THE CITY HUB – HEFEI LUOGANG CENTRAL PARK

JINGXIU LAKE AREA



HEFEI, CHINA

PROJECT STATEMENT

/

Hefei Luogang Central Park, the renovation site of Luogang Airport, is currently the world's largest urban park and located in the transitional zone between the new and old urban areas. The total area in planning stage was 12.7 square kilometers, which is approximately equivalent to four New York Central Parks.

The design has maximized the preservation of existing water and forest systems, purified the water entered from Chaohu Lake, and improved the microclimate environment of the city. With a self-purification, self-circulation, and self-balance water ecology, it became a green engine for gathering ecological civilization and urban vitality.



LANDMARK TOWER VIEWED FROM THE PARK WITH THE BACKGROUND OF HEFEI CITY SKY LINE



CENTRAL LAWN AXIS VIEWED WITH JINXIU LAKE AREA AND GARDEN EXPO PARK ON BOTH SIDE.
THE ECOLOGICAL CONSERVATION FOREST EXPERIENCE ZONE IN THE DISTANCE IS STILL IN THE PLANNING AND DESIGN STAGE.

An aerial photograph of a modern park. The park features a network of winding paths, some of which are paved in blue. There are large green lawns, numerous trees, and a prominent white circular structure with a curved roof. The park is situated next to a road with white lane markings. The overall scene is vibrant and green, with many people walking and playing in the park.

PROJECT STATEMENT

/

The reasonable integration of these functions throughout the entire park is a unique feature. It is not only an ecological urban park, but also a comprehensive urban complex that includes forest conservation, urban stage, food market, hotel accommodation, art exhibition halls, etc.

After its completion, the park became a new central ecological vitality zone in Hefei. It has reorganized the transportation system within the site, improved the environment quality for surrounding residents, brought more developments and opportunities to the city and played a demonstrative role in exploring the future development of the city in the fields of ecological construction and urban renewal.

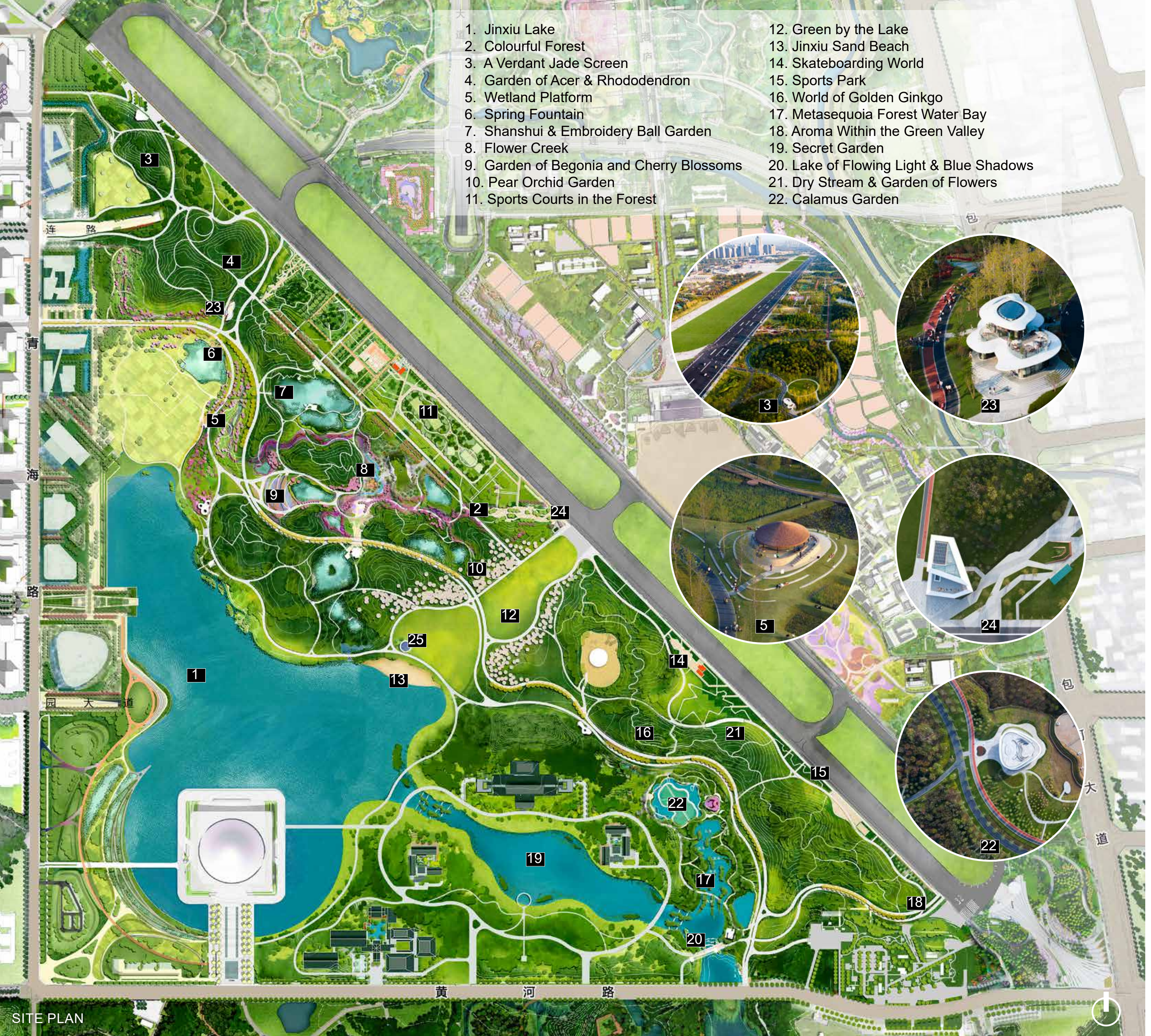

- | | |
|--|--|
| 1. Jinxiu Lake | 12. Green by the Lake |
| 2. Colourful Forest | 13. Jinxiu Sand Beach |
| 3. A Verdant Jade Screen | 14. Skateboarding World |
| 4. Garden of Acer & Rhododendron | 15. Sports Park |
| 5. Wetland Platform | 16. World of Golden Ginkgo |
| 6. Spring Fountain | 17. Metasequoia Forest Water Bay |
| 7. Shanshui & Embroidery Ball Garden | 18. Aroma Within the Green Valley |
| 8. Flower Creek | 19. Secret Garden |
| 9. Garden of Begonia and Cherry Blossoms | 20. Lake of Flowing Light & Blue Shadows |
| 10. Pear Orchid Garden | 21. Dry Stream & Garden of Flowers |
| 11. Sports Courts in the Forest | 22. Calamus Garden |

PROJECT NARRATIVE
/
Background + Vision

The project is located in Baohe District, Hefei City, with a total planned area of 12.7 square kilometers, connecting to the Hefei South Railway Station on the north. It was renovated from the abandoned Luogang Airport and the government hopes it will be “the window of Anhui, the heart of the provincial capital, and the lung of the city”.

The whole planning park contains four major zones: Jinxiu Lake Area, Garden Expo Park, Science and Technology Innovation CBD, and Ecological Conservation Forest Experience Zone. The Garden Expo Park and Jinxiu Lake Area have been basically completed at present.

In the design process of Jinxiu Lake Area (2,280,000sqm in total), the design team hopes to establish a stable and sustainable ecosystem through a pure ecological and large-scale restoration strategy, thereby forming diversified waterfront new spaces, high-quality stable new habitats, and sustainable new parks for the people. They aim to build a green living room in the city center for citizens, bringing new ecological and natural development opportunities to the city.

PROJECT NARRATIVE

/

Transformation of City Hub

From an airport to a central park

The original site of the park was Luogang Airport in Hefei. The urban development has led to the former airport being phased out of the historical stage, but the “hub” feature remains the core attribute of this project. The design team hopes to showcase the role of the hub through ecological methods, and via multiple design measures to transform the old site into a new park, and upgrade transportation hub into an ecological multi-function hub.

The entire project planning is divided into four sections: two parts are finished, which are Jinxiu Lake area, mainly composed of citizen activity and leisure areas; the Garden Expo Park area, which utilizes the existing legacy buildings of the airport for urban renewal. The ecological conservation area in the southern part (currently a forest) and the composite function led CBD are still under design & construction.



**LUOGANG AIRPORT HELPS HEFEI GO
GLOBAL, AS IT WAS THE PLACE WHERE
AIRPLANES TAKE OFF AND LAND**

AIRPORT



**NOW, THIS PLACE WILL TRANSFORM
INTO A THRIVING LAND, GIVING THE CITY
NEW OPPORTUNITIES**

EARTHPORT

ACCESSIBLE + CONNECTED TO THE CITY

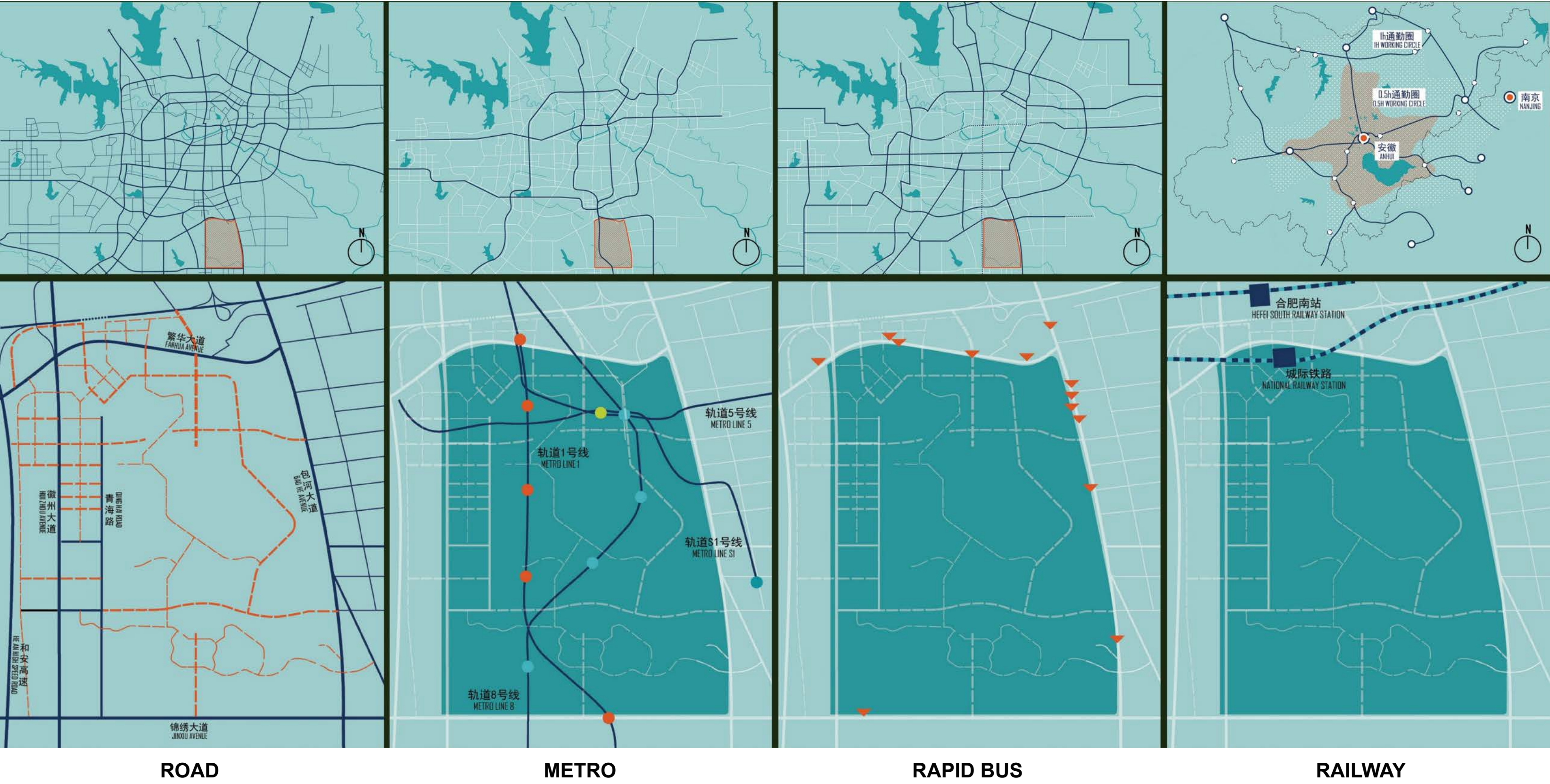

PROJECT NARRATIVE
/
Transformation of City Hub
From an airport to a central park

After its completion, the park became a new central ecological vitality zone in Hefei. It has reorganized the transportation system within the site, improved the environment quality for surrounding residents, and brought more developments and opportunities to the city. Since Jinxiu Lake area & Garden Expo finished the construction, it has attracted thousands of citizens and tourists to come here to visit, explore and relax. Revitalizing the attraction of the venue to the city has special significance for Hefei city.



HILLS + FOREST + WETLANDS
OPEN BOUNDLESS RUNWAY - READY TO TAKE OFF



BIG BOLD LANDSCAPE



WATER PLAY VALLEY



FOREST + HILLS PATH

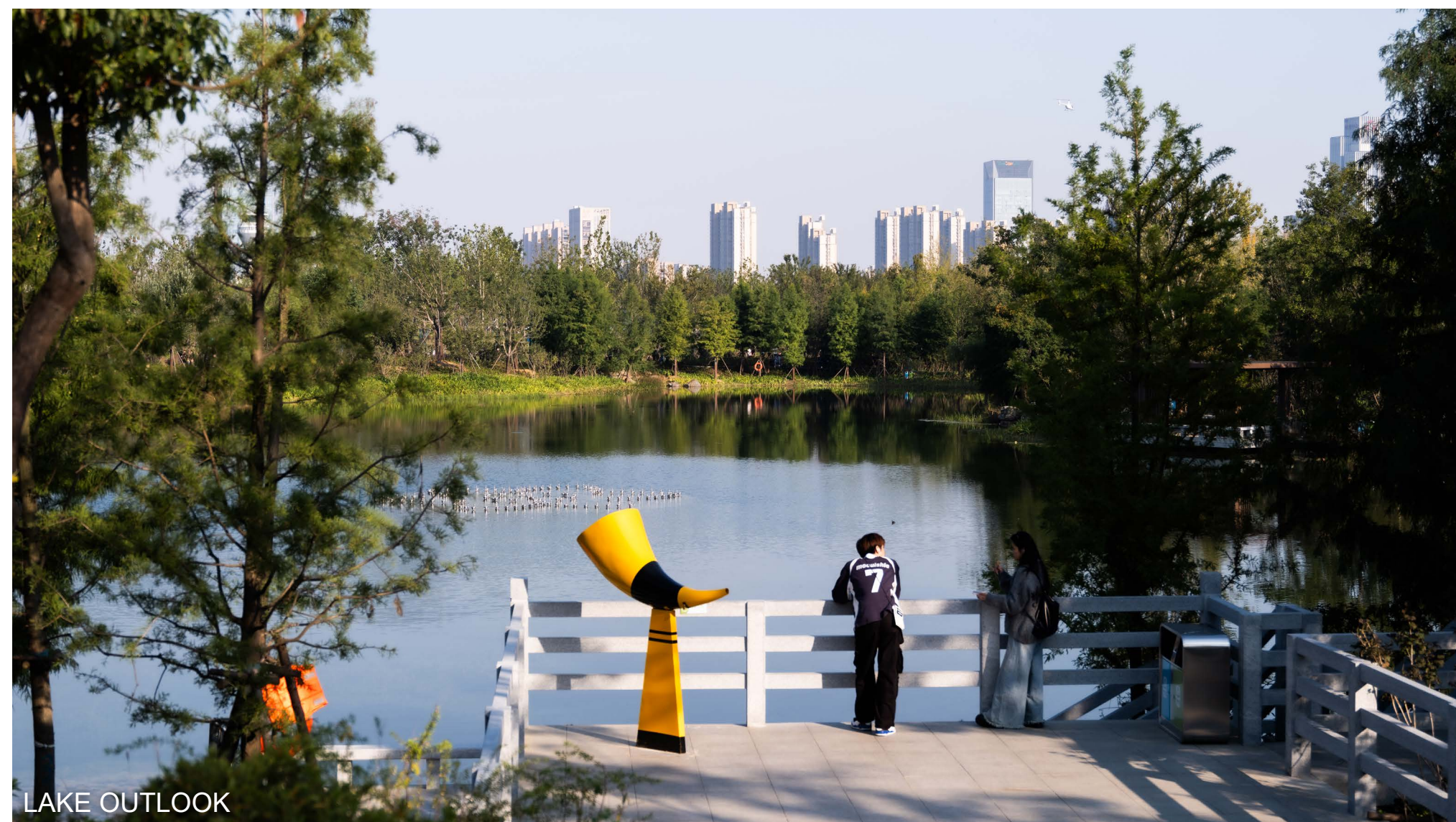

LAKE OUTLOOK

PROJECT NARRATIVE
/
Complementarity and Re-Circulation
From Airport to Earth Port

The super large scale of the project has led the design team to think about how to incorporate the characteristics of it at the initial stage of conception, to form a strongly recognizable site feature.

After its completion, the slow paced activity space that allows for walking, running, and bike riding, as well as the supporting buildings designed based on various characteristic activity venues, have made it a famous tourist destination in Hefei after its completion, as well as a citizen reception hall and children’s amusement park.

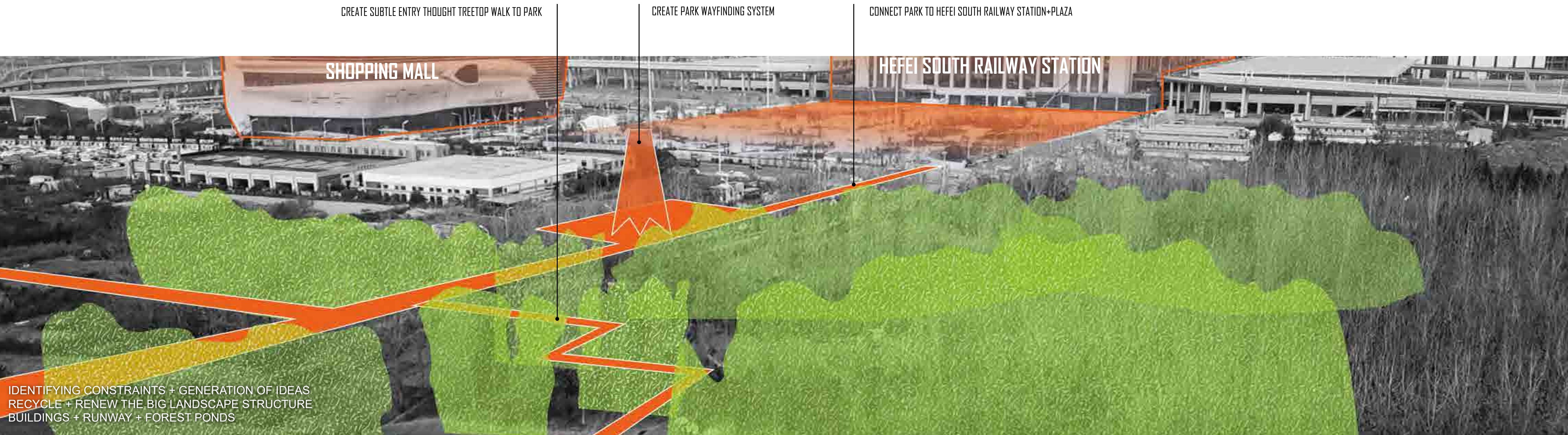



AFTER ITS COMPLETION, IT BECAME ONE OF THE MOST POPULAR DESTINATIONS IN THE CITY.

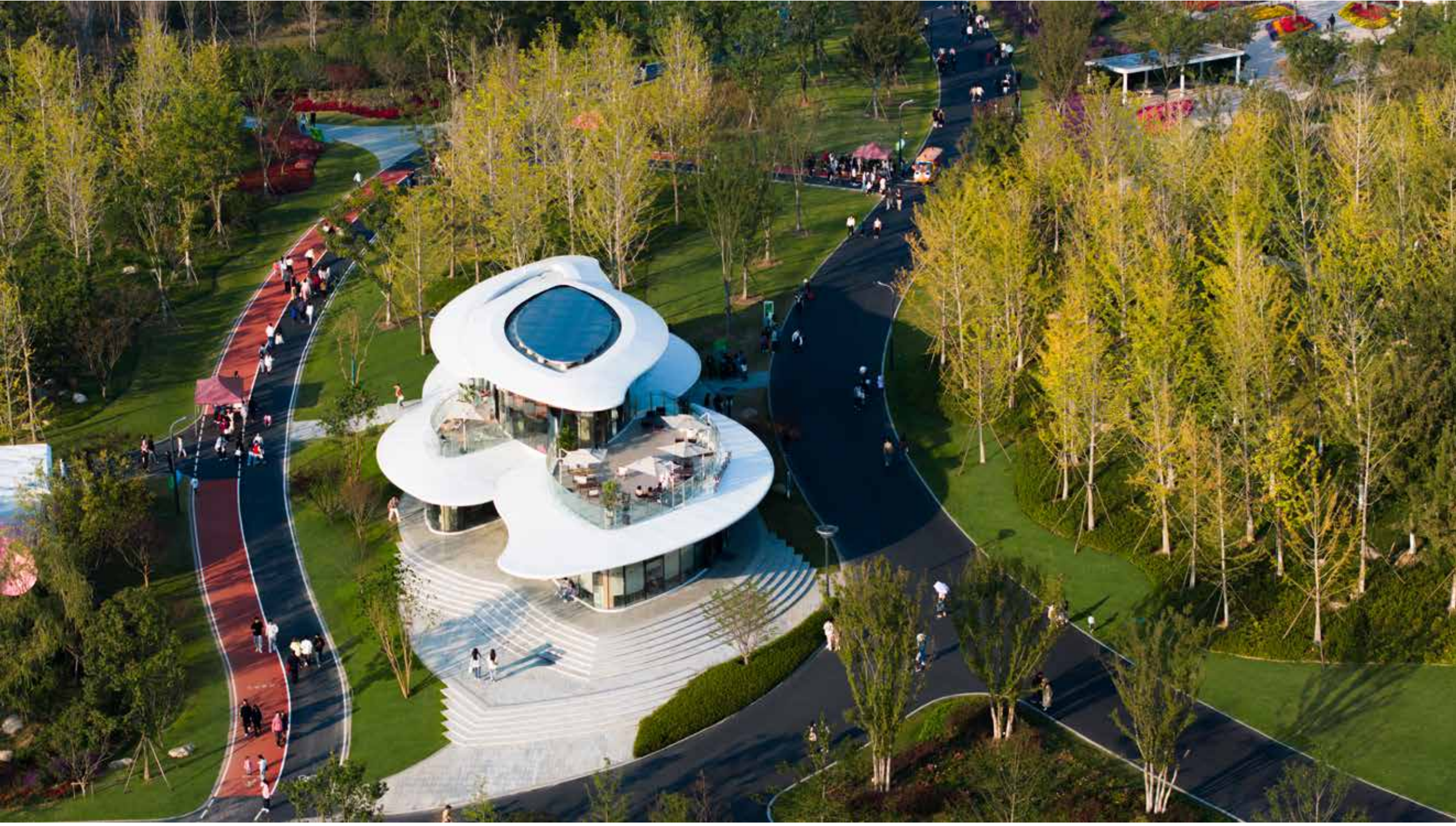

PROJECT NARRATIVE

/

Complementarity and Re-Circulation From Airport to Earth Port

Through axis determination, zoning arrangement and re-shaping, two large-scale seasonal forest landscapes are formed with the central large-scale lawn as the main axis. Design team also added children's playgrounds, sports spaces, and various small-scale activity venues with characteristic gardens along the roadside under the forest. In order to achieve a landscape spatial pattern of large, medium, small with buildings, runways, forests, ponds, etc. to meet the various needs of citizens & tourists for taking photos and doing leisure activities.

Since its construction, its composite and comprehensive functions have been fully demonstrated, and multiple civic activities and high-level sports competitions have been held, such as:

September 2023, the Hefei International Park Expo Park opened, receiving a total of over 5 million tourists during two months;

October 2023, Luogang Park in Hefei was listed as one of the top 20 popular tourist attractions during the National Day holiday in China. During the holiday period, approximately 2.25 million tourists were received, ranking among the top ten in the country.;

End of October 2023, the Hefei LMF Music Festival has been held;

Starting from the autumn of 2023, multiple public events for citizens has been held, such as marathon races, group weddings, kite camping events, fire safety promotion, university student autonomous driving formula competitions, etc;

During the Labor Day holiday in May 2024, the cumulative number of visitors exceeded 1 million, with 46% coming from outside of the province;

From September 26, 2023 to April 23, 2024, the cumulative number of visitors to Luogang Park has reached 10.007 million.

TBC

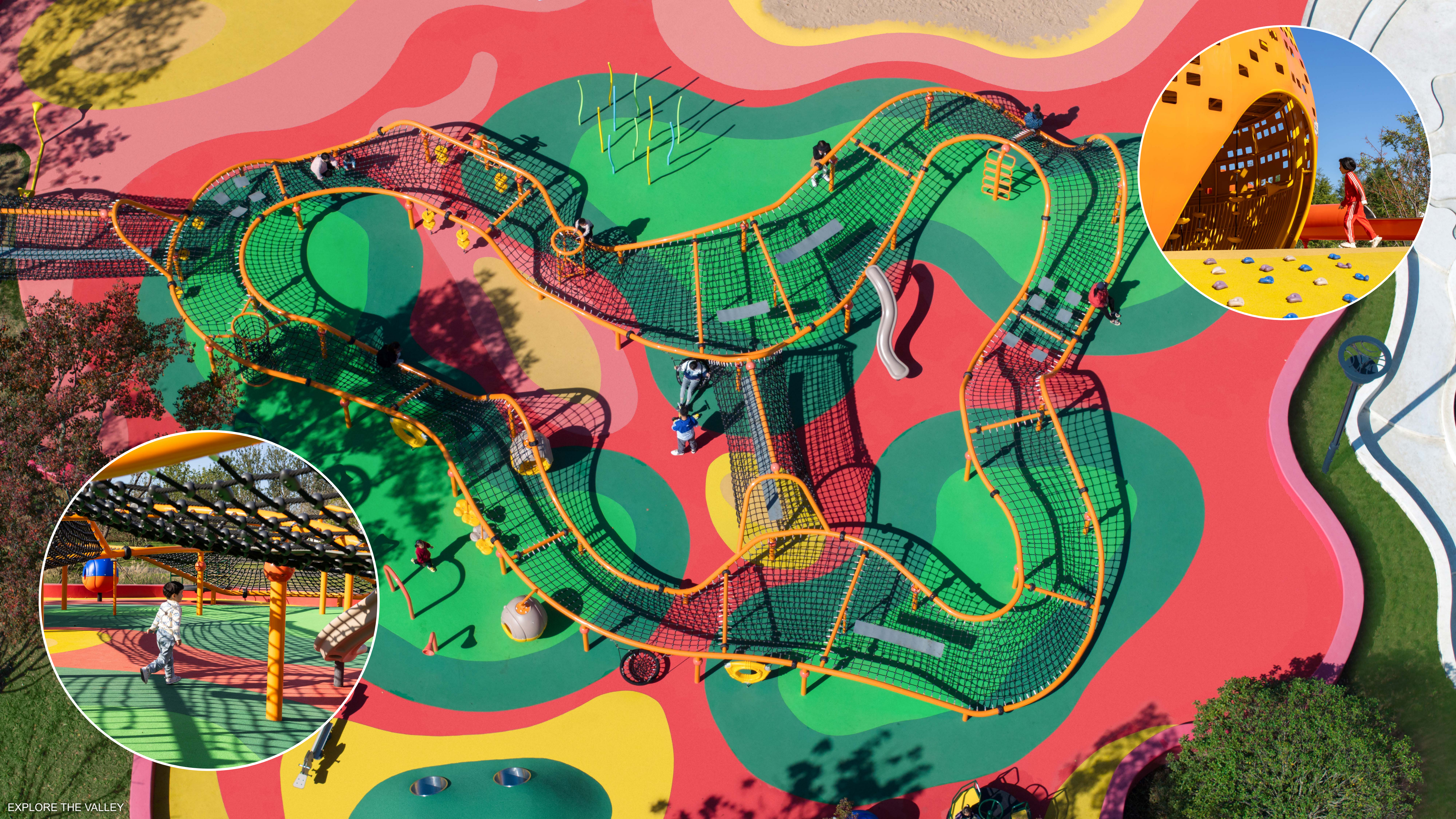





CHARACTERISTIC CAFE & ARCHITECTURE TO PROVIDE RESTING AREA, FUN AND RELAXATION



WATER PLAY VALLEY



WATER CLEANING ECOSYSTEMS APPLIED WITH ELEGANTLY DESIGNED PLATFORM



EXPERIENCE ALONG THE WALKWAY

An aerial photograph of a park landscape. A winding stream flows through the center, surrounded by lush greenery and trees with vibrant autumn foliage in shades of red, orange, and yellow. The stream is bordered by grassy banks and some reeds. The overall scene is a harmonious blend of natural elements and human-made landscaping.

PROJECT NARRATIVE

/

Natural Sustainability

Retain Ponds, Filter and Cleanse Water; Create Hills + Grow New Forest

The use of ecological methods for construction is the foundation for maintaining long-term stability of the park after its completion. The design aims to establish a comprehensive ecological system architecture, focusing on various aspects such as terrain creation, ecological afforestation, sponge construction, and biological community construction.

It provides ecological support for multi-dimensional landscape creation and extensively uses natural and primitive ecological construction materials to provide a long-term and durable operating foundation for the park ecosystem.

UTILISE GREEN SPACE AS LONG SPONGE PARK

CREATE NATURE REGENERATING SOAK IN THE HEART OF THE CITY

RETAIN REGROWTH FOREST

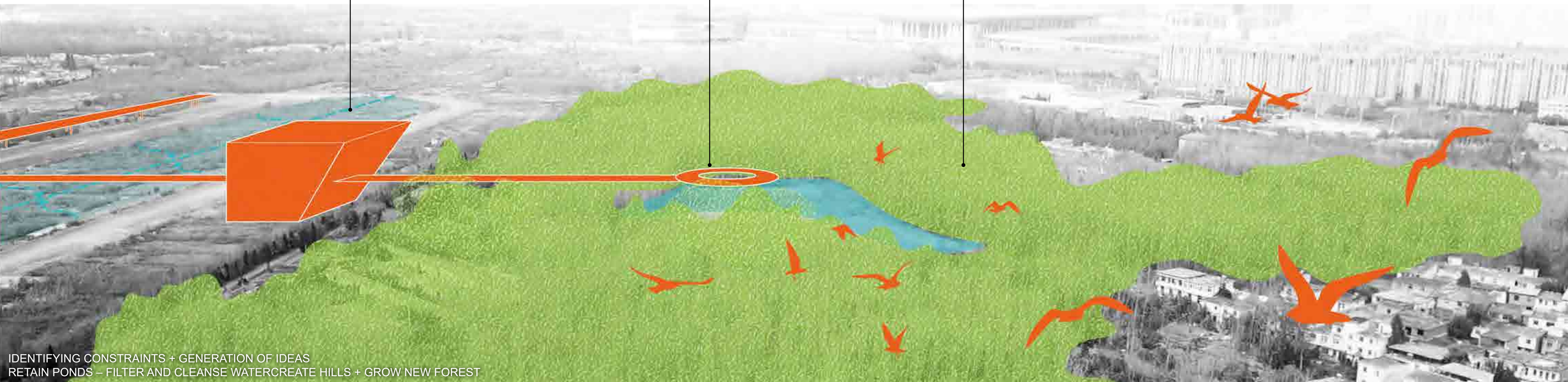

IDENTIFYING CONSTRAINTS + GENERATION OF IDEAS
RETAIN PONDS – FILTER AND CLEANSE WATER
CREATE HILLS + GROW NEW FOREST

USE SITE SLOPES TO CREATE WATER PURIFYING CANALS

CAPTURE RUNWAY RUNOFF

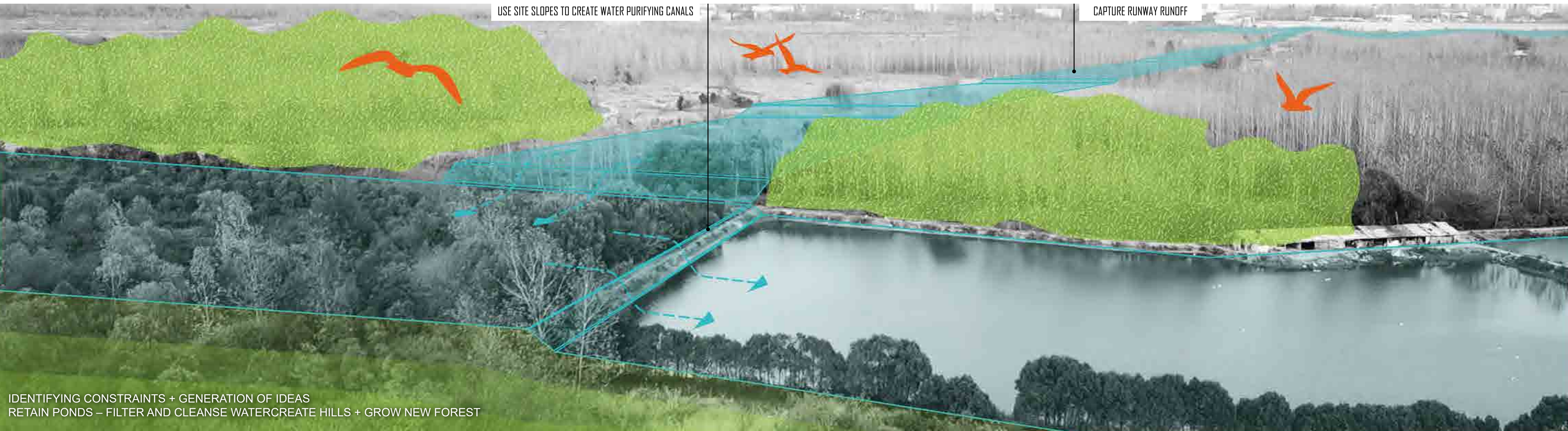

IDENTIFYING CONSTRAINTS + GENERATION OF IDEAS
RETAIN PONDS – FILTER AND CLEANSE WATER
CREATE HILLS + GROW NEW FOREST

SOFTEN FIFTY MILE RIVER AND PURIFY WATER THROUGH PARALLEL CHANNELS



MATINTAIN REGROWTH FORESTS

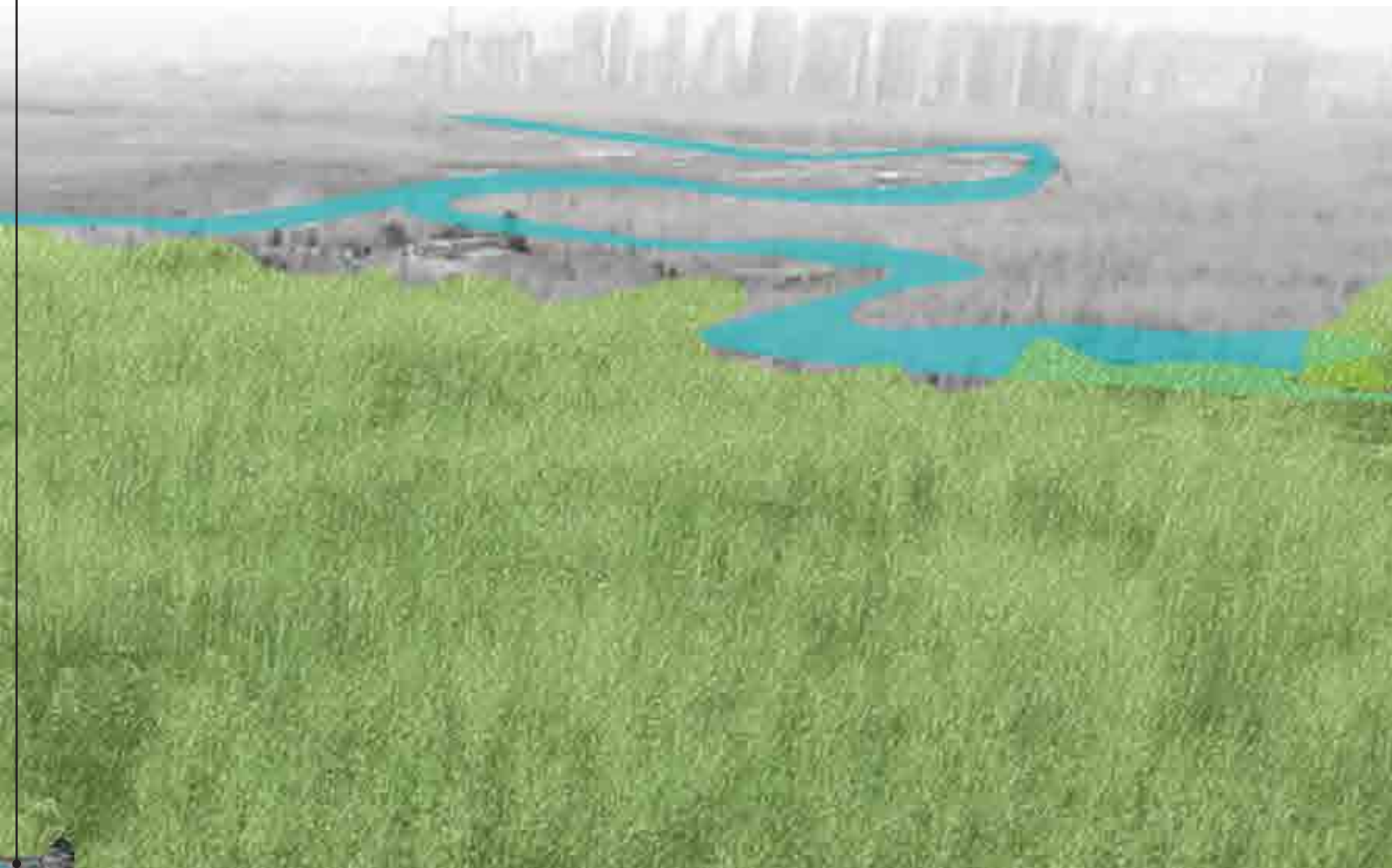

IDENTIFYING CONSTRAINTS + GENERATION OF IDEAS
RETAIN PONDS – FILTER AND CLEANSE WATER
CREATE HILLS + GROW NEW FOREST

NATURAL PLANTING TO DRAINAGE SOAK AREAS

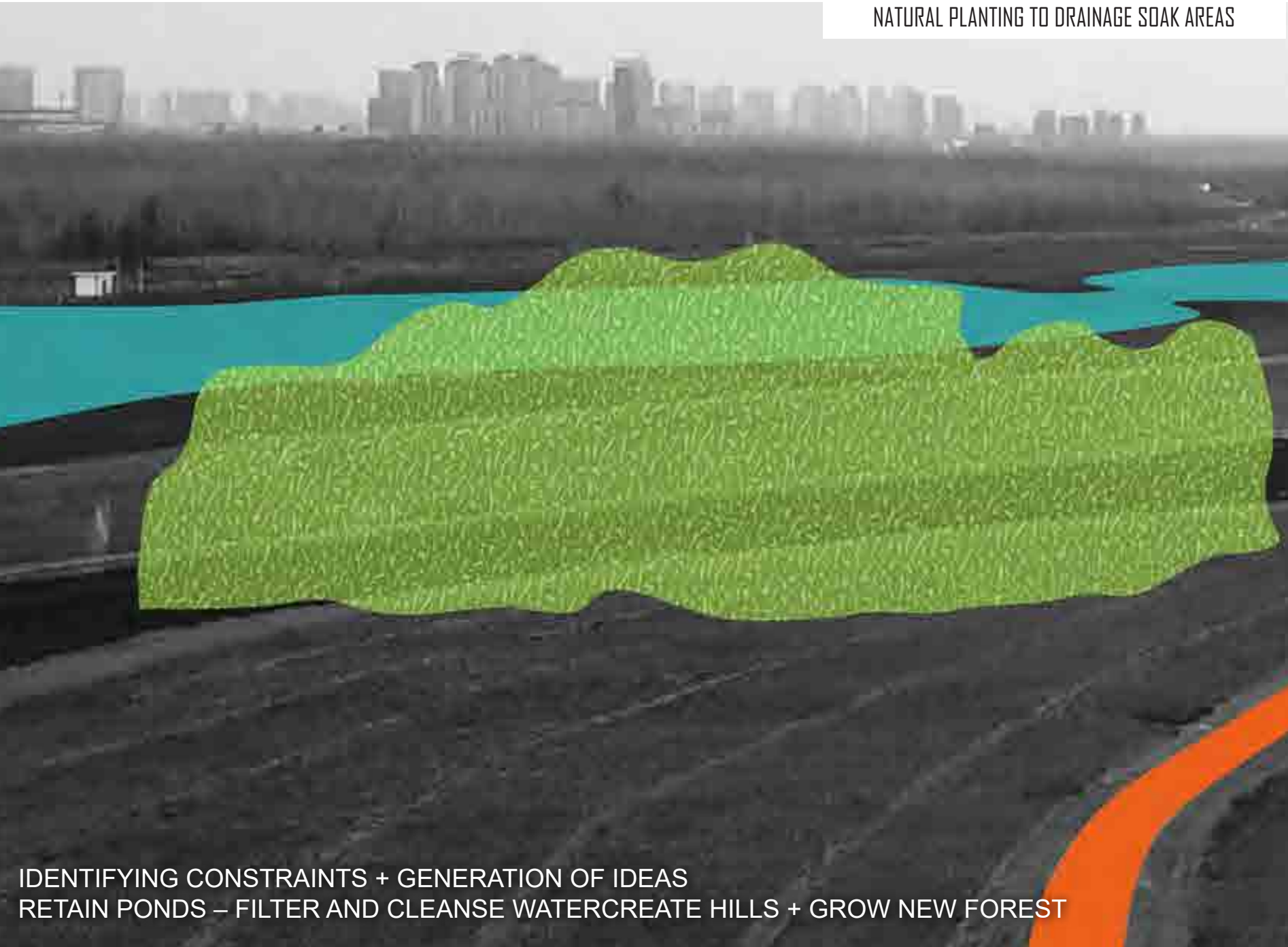

PROVIDE TREE GROUPS TO BREAK UP OPENESS + CREAT
ECOLOGICAL DIVERSITY

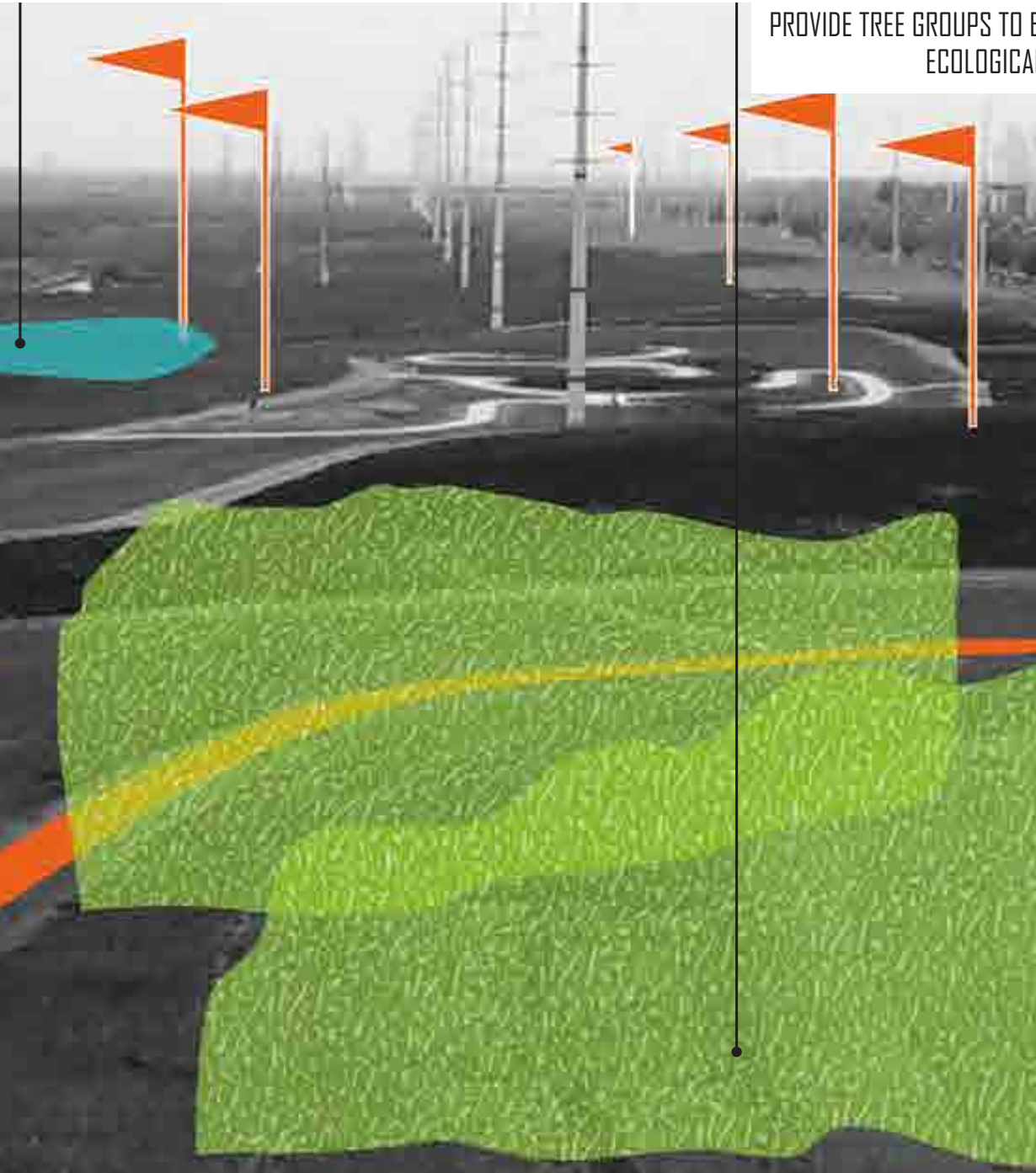

USE ECO-ART TO INTEGRATE POWER LINE TOWERS



IDENTIFYING CONSTRAINTS + GENERATION OF IDEAS
RETAIN PONDS – FILTER AND CLEANSE WATER
CREATE HILLS + GROW NEW FOREST

An aerial photograph of a park landscape. The park features a series of interconnected ponds and a network of winding paths. The paths are color-coded, with sections in red, blue, and green. A modern, white, circular building with a flat roof is situated on a grassy area to the right. The surrounding area is densely forested with green trees. The overall design emphasizes natural sustainability and ecological balance.

PROJECT NARRATIVE

Natural Sustainability

Retain Ponds, Filter and Cleanse Water; Create Hills + Grow New Forest

Drawing on the concept of Chinese gardening, design aims to create a landscape from small landscapes to large landscapes, to form a layered and rich terrain and landforms, providing effective natural barrier protection for the ecological space of the park. Planting strategy also proposed various ornamental flower trees, fruit trees, and color leaf trees to create a forest ecological system with rich layers and distinct seasonal features. Strolling along the park, plants such as dwarf reeds, blue sage, iris, and purple wolf tail grass can be seen everywhere along the creek. When tourists enjoy the unique natural scenery, these flowers and plants play an important role in filtering solid suspended solids and removing organic pollutants from water.

An aerial photograph of a lush park. A prominent red running path winds through the landscape, passing a large, calm pond. The park is filled with various types of trees, some with autumn-colored foliage. In the background, there are more ponds and a small white building. The overall scene is vibrant and green.

PROJECT NARRATIVE

Natural Sustainability

Retain Ponds, Filter and Cleanse Water; Create Hills + Grow New Forest

According to the concept of “sponge city”, a three-level sponge system of large, medium, and small sizes is established. Low carbon submerged ecological restoration technology is applied to construct an underwater ecosystem, and sponge facilities such as grass planting ditches, sunken green spaces, rainwater gardens, and ecological retaining walls are added. While improving the landscape effect, the self purification, self circulation, and self balance of the water environment in the park are achieved. By strengthening infiltration, purification, and retention (delayed and limited discharge), comprehensive control of rainwater from small regions to the entire basin is achieved, creating an ecological model for the construction of urban sponge systems.

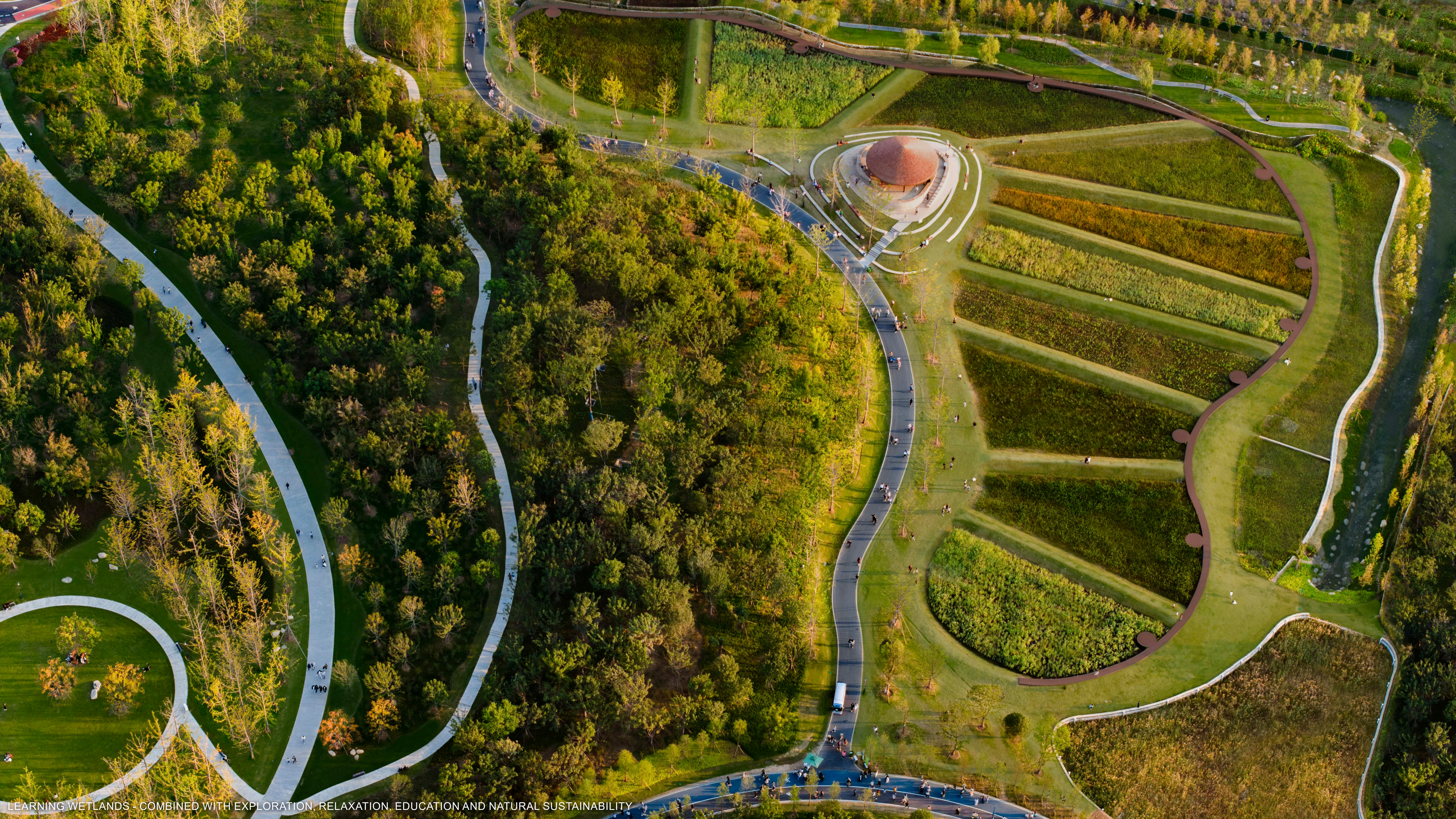

LEARNING WETLANDS - COMBINED WITH EXPLORATION, RELAXATION, EDUCATION AND NATURAL SUSTAINABILITY



WATER CLEANING ECOSYSTEMS



WATER CLEANSING ENGINE

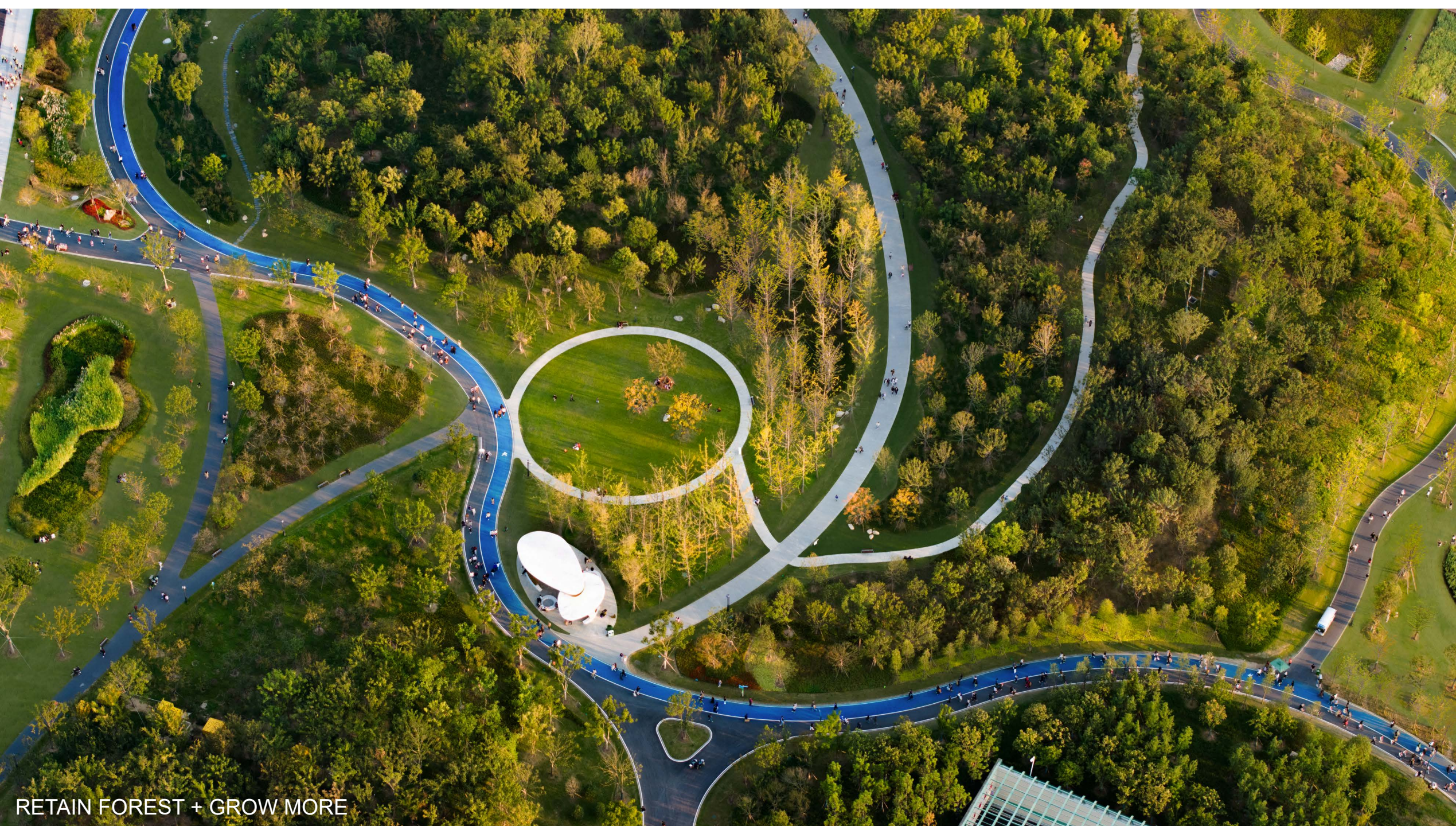

RETAIN FOREST + GROW MORE



CREEK BEDS



PROJECT NARRATIVE
/
Summary

As a rapidly developing city in China, Hefei Luogang Central Park developed like a shining business card, attracting people from all over the country and even the world to come and visit. The abandoned airport where the project is located has a unique site history and core regional location, innovatively integrating the characteristics of urban parks and commercial operations for coordinated design. With the dual support of ecology and operation, the entire project has become a new reception hall and an urban IP for Hefei City.

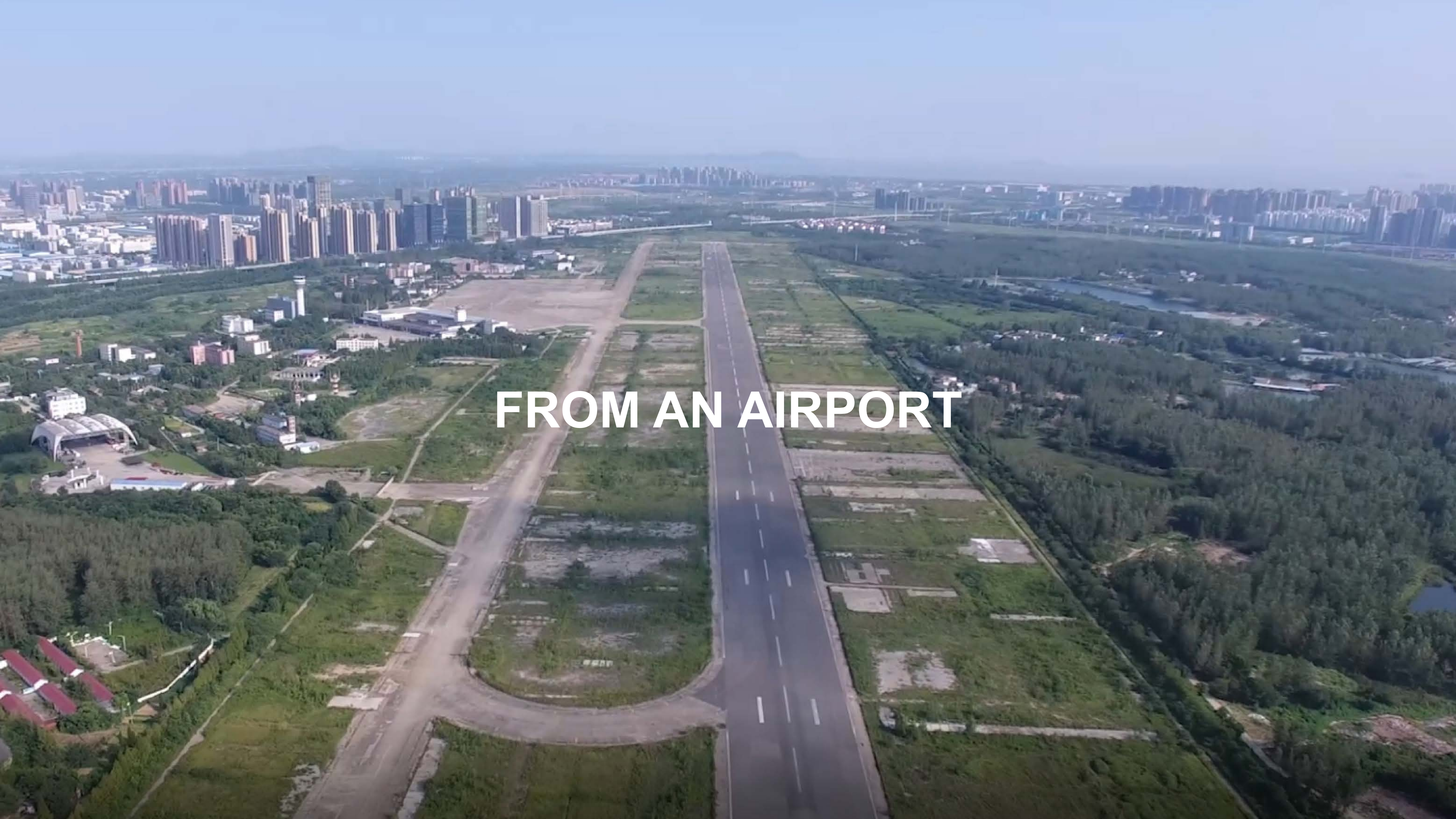
An aerial photograph showing a long, straight asphalt runway and a parallel taxiway. The runway has white dashed center lines and solid edge lines. To the left of the runway, there's a grassy area with some buildings, including a hangar-like structure. In the background, a dense urban skyline with many high-rise buildings is visible under a clear blue sky. The foreground shows a mix of green grass and some patches of bare earth or construction areas.

FROM AN AIRPORT

FROM AN AIRPORT TO AN EARTHPORT

A SUPER PARK COMPLEX IN THE CITY HUB – HEFEI LUOGANG CENTRAL PARK
JINGXIU LAKE AREA

