

PROJECT TITLE

WAN CHAI PROMENADE

FROM TAMAR TO HONG KONG CONVENTION AND EXHIBITION CENTRE

HONG KONG

PROJECT STATEMENT

Wan Chai Promenade from Tamar to Hong Kong Convention and Exhibition Centre incorporates a human-friendly green space along the Wan Chai waterfront for appreciating the Victoria Harbour. It's easy to reach and connects the harbor front of Central District and Wan Chai. It completes a crucial link of the Victoria Harbour promenade, which is by far the longest promenade in Hong Kong. The space is largely a lawn for strolling and playing. It also provides different forms of sitting-out area and topography landscaping, allowing visitors to sit back and relax while enjoying the panoramic view of the Victoria Harbour. “Play with Nature” strategy was introduced with an aim to provide a dynamic outdoor experience with naturalistic landscape.

The project by the landscape team has made profound contribution to the landscape profession with inviting the ecosystem of natural forest into the prosperous urban promenade; cultivating dynamic and flexible outdoor spaces with imaginative children's play; creating a colourful landscape year-round and providing environment education experiences to general public.



As a waterfront with multifunctional and distinctive characters, the relation with the harbor, cultural and historical context of local District and surrounding environment is emphasized.



HONG KONG CONVENTION AND EXHIBITION CENTER

TAMAR

1 FEATURE CANOPY

2 "FUNSCAPE"

2 "FUNSCAPE"

3 CONSERVATION AREA

4 ENTRANCE PLAZA

5 RESTING STOP

6 LANDING STEPS

5 RESTING STOP

7 SUNKEN SEATING

8 MEANDERING RAMBLE

9 ART SEATS

9 ART SEATS

10 GREEN ARTERY

CENTRAL WAN CHAI BYPASS

WAN CHAI PROMENADE SITE PLAN
FROM TAMAR TO HONG KONG CONVENTION AND EXHIBITION CENTRE

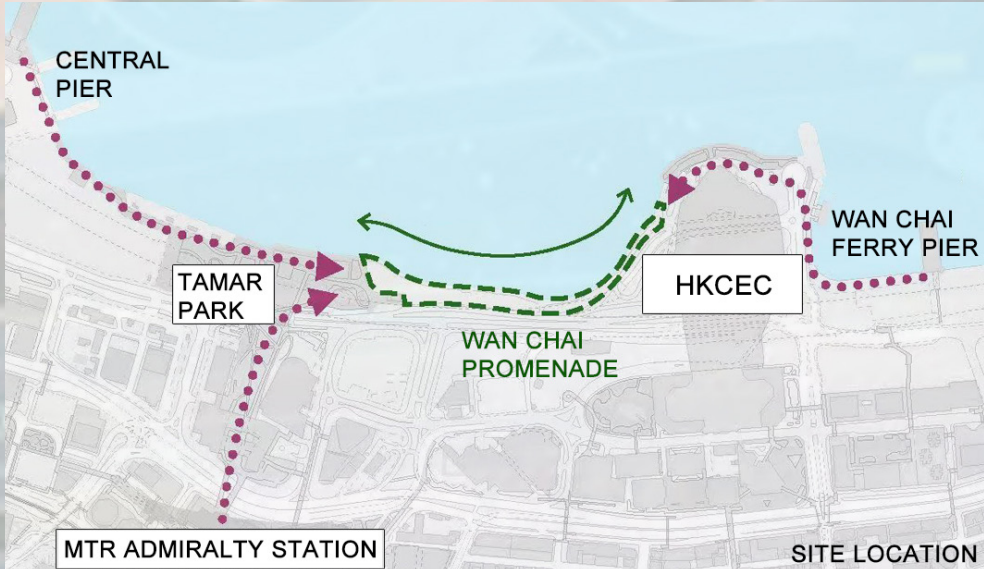



PROJECT NARRATIVE

Project Summary

Wan Chai promenade landscape (from Tamar to the Hong Kong Convention and Exhibition Centre) was officially opened to the public in early May 2021. The majority area of 7,800m² is to provide relaxation facilities, sitting-out area, outdoor space for public strolling and playing and allowing visitors to sit back and relax while enjoying the panoramic view of Victoria Harbour. The promenade created a pedestrian walkway with a length of about 560m and a width of about 6m, connecting the harbor front area of Central and Wan Chai. It is part of the Victoria Harbour promenade, which has a total length of 5.5km and is by far the longest promenade in Hong Kong.

The design aims to create a waterfront with multifunctional and distinctive characters with the help of emphasising the relation with the harbour, cultural and historical context of Wan Chai District and the surrounding environment.





“ FunScape ”

Exploring an unconventional approach cultivating a free space for improvised games or group activities by way of horticulture design.



PROJECT NARRATIVE

“FunScape”

The activity space at the end near Tamar Park is designed with a “FunScape” theme.

“FunScape” explores an unconventional approach cultivating a free space for improvised games or group activities by way of horticulture design and undulating grass berms with colorful pipes tunneling through the berms. This open lawn setting not only offers children an inclusive play experience, but it also aims at encouraging children to use their imagination to create their own play space and enjoy a creative play journey at the harbor front. This experimental approach aims to bring new ideas for more and more innovative children's play experiences along the waterfront in the future.



PROJECT NARRATIVE

Planting Strategy - Naturalistic Urban Landscape Scenario

Different planting strategy is designed for each activity area to match with its atmosphere. Yellow and orange are mainly used for children’s play area which gives an energetic and colourful scenery. For the amphitheatre, pink and purple color are considered as the main colour theme, with romantic atmosphere which may potentially become one of the popular photo taking hotspots. Trees and shrubs with seasonal flowers were selected to provide a different pallet throughout the year. Two lawn species were adopted aiming to differentiate the green corridor for circulation and the remaining open space for sitting out and play.

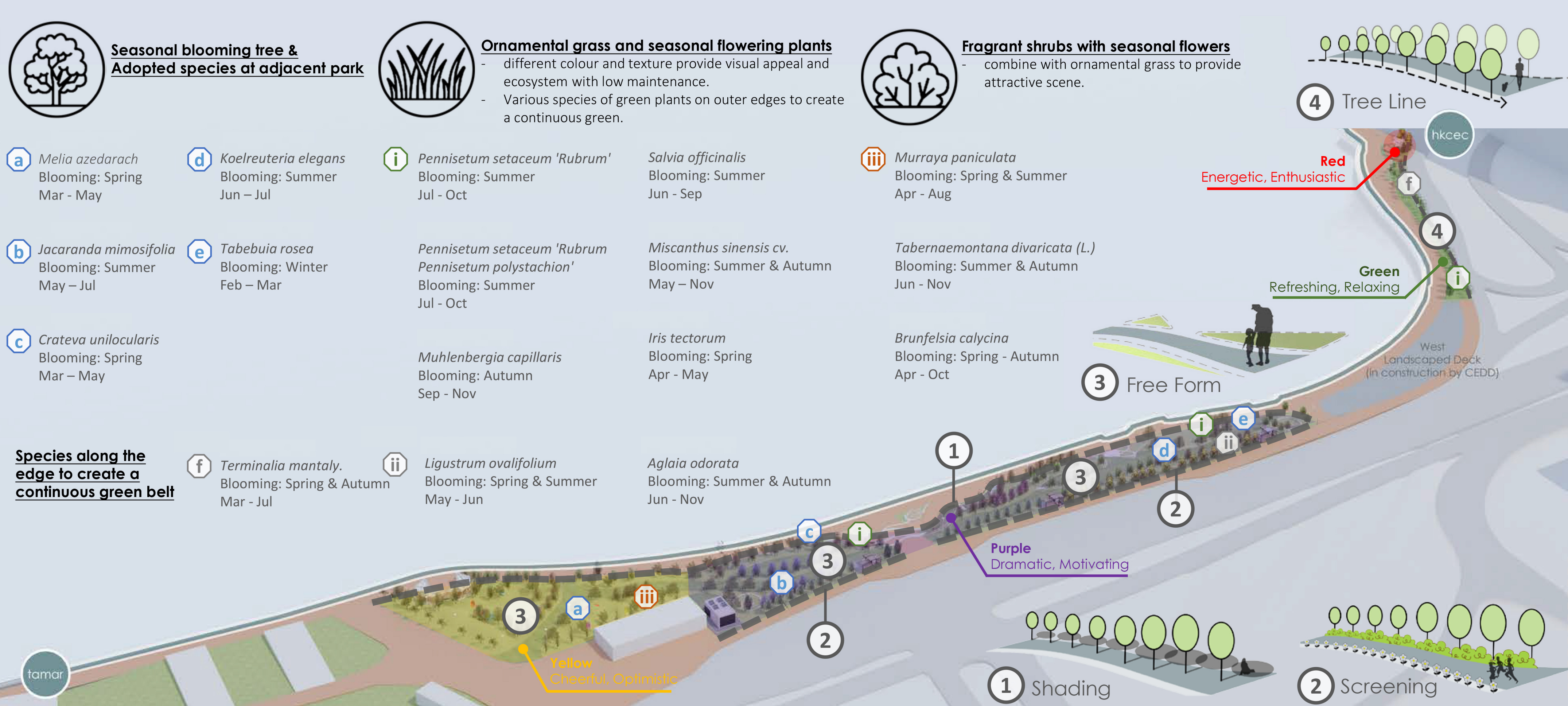



PROJECT NARRATIVE

Balancing Urban Micro-biology

To maintain and enrich the local biodiversity, wildlife-friendly plant species was included to provide food and shelter as well as to create a favourable habitat in the urban context. Trees provide shelter and resting place for birds, shrubs provides food resources e.g. fleshy fruits and nectar for birds and insect pollinators, and facilitate the pol-
lination/seed dispersion of plant species results in biodiversity.







PROJECT NARRATIVE

Entrance Plaza & Sustainability Design

A number of sustainable elements have been added to the promenade, including a wind-powered lighting system and solar-powered lamps along the footpaths. As a photogenic hotspot, an artist from Hong Kong Timberbank has made use of trees that fell during typhoons in the past few years and fabricated a set of public art seats named “A Little Rest in this Tiny Island”. The designs of these facilities are not only practical and aesthetically pleasant, but also environmentally friendly. The park also provides pavilions with various designs, tables, and chairs, allowing visitors to sit back and relax while enjoying the panoramic view of Victoria Harbour.



