

Urban Renewal of Yunji Road



Project Statement: The overall renewal of Yunji Road brings new power into the city. This power comes from the continuous open city corners, the open spaces under the trees, the rhythmic street rest corridors, the street space full of stories and history, and the dynamic interactive social space. These spaces turn the core axis of the city into a continuous ribbon-shaped garden full of possibilities and acceptance so that various people in the city can find their living places here, thus, activating the self-healing power of the power.



Background

As one of the most significant streets in Yichang, China, Yunji Road is dominant because of its unique geographic position and long history. Since its launch in 1917, the road has become the core of transportation and business. As the central axis of urban politics, economics, and culture, it is also the spiritual axis for life matters.



Dangerous Steps



Broken Infrastructure

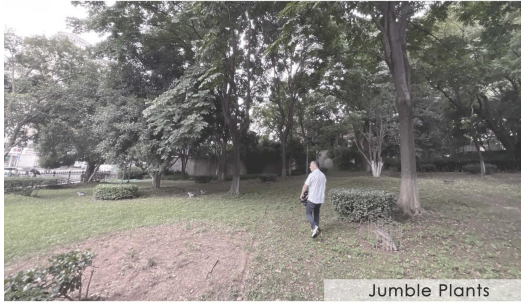

Jumble Plants



Unsafe Railing



Deactivated Space



Closed Park Boundary

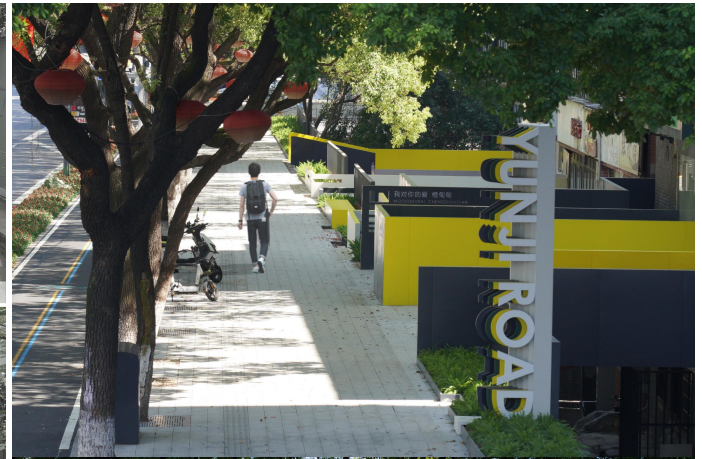

Design Brief

After decades of urban development, the road had become old-fashioned and could no longer meet the current urban functional requirements with poor road conditions and broken outdoor facilities. The road renewal aims to present the city spirit rationally and concisely, integrated into the daily life of urban citizens. The spirit includes, but is not limited to, the historical changes and the cultural contexts of the site, the changes in plants, landscape, and functions, the organizational adjustment of the urban road traffic, and the ever-changing customer group. Such spirit is dynamic, traceable, and reproducible. In this design process, the block of Yunji Road is regarded as an activated self-healing container, which transforms the city spirit into the daily routine life that citizens can perceive, to rejuvenate the road and make it back to the core functional axis of the city.

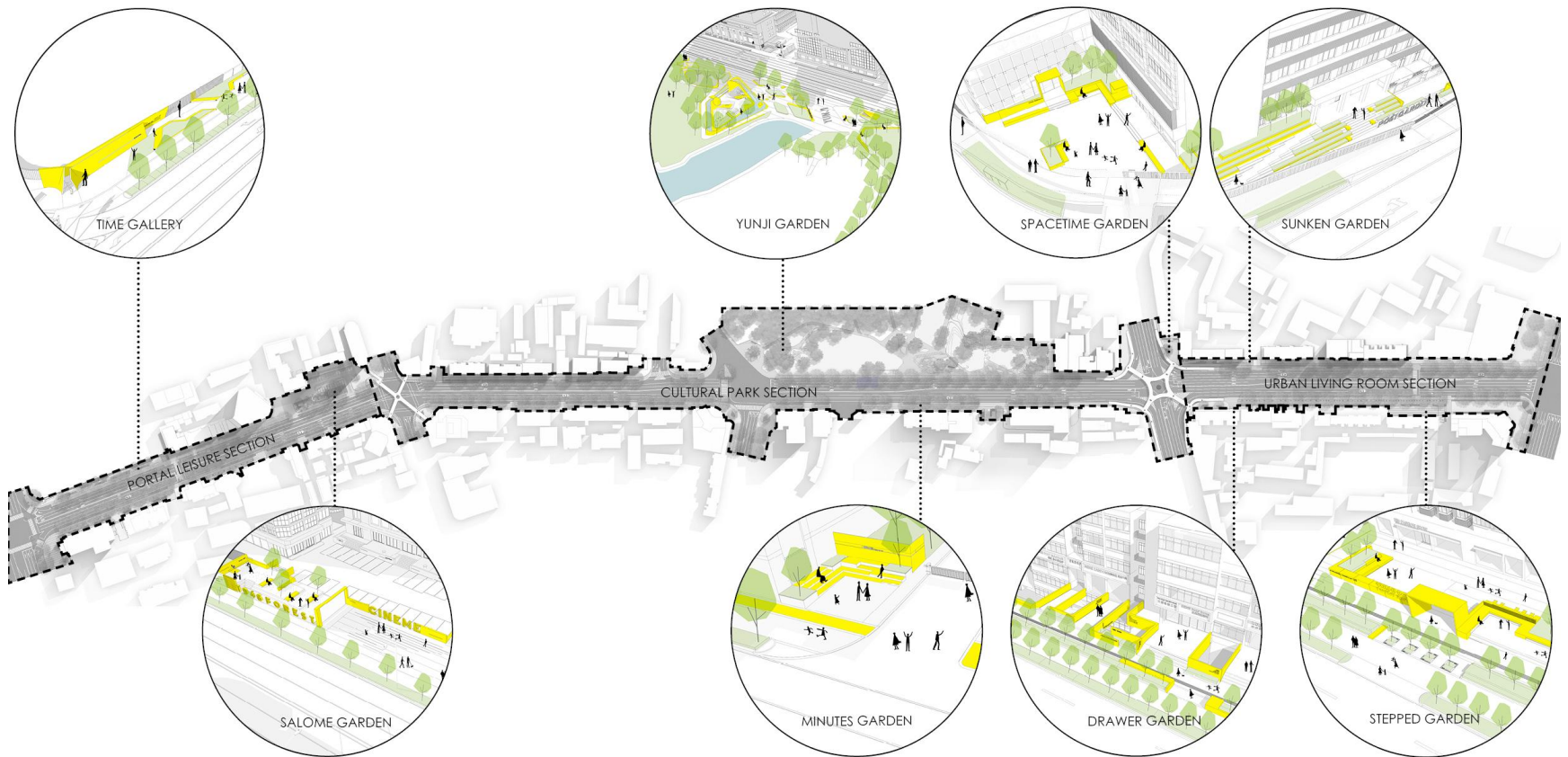

Solution

Highlighting the openness and internationalization of Yichang as a riverside port city, the landscape renovation reconstructs the overall space to reflect the spirituality of the contemporary city of Yichang. The color scheme of black, white, and gray is matched with exquisite cold gray and gray-blue steel plates, dotted with bright yellow steel plates to highlight the vitality of urban blocks, in line with the functions of surrounding blocks, highlighting the unique charm of CBD in the core area of the city through overall modern texture.



Integrating urban life and reshaping the functions and values of streets and corners, the landscape design creates the city image of an urban elite and makes the urban public function back to the road. Both sides of the road are full of unique textures with continuous changes in the road system, architectural styles, business format, users, and even the growth of trees. Every corner is full of unique textures, stories, and humanistic cores. Such a road full of history can only adopt an acupuncture-style method, which analyzes specific problems, excavates the cultural memory of the site, studies the composition of the space boundary in detail, and proposes upgrade strategies to each detailed fragment. After site surveys, meeting discussions and design integration, the entire Yunji Road includes three pocket gardens, five street gardens, and multiple corner and nodes. All these contents make the city life centered on Yunji Road more attractive. Such a Yunji Road is a part of daily life, and it will integrate into the life of the city residents through the urban functions.



The design started with functions, focused on culture, sorted the spatial structure and the context of the site, and realized the dialogue between the past and the present with the innovative design language and modern interaction technology, so as to create an urban space connecting the historical memories of the sites, full of distinct style of Yunji Road, which is fashionable, open and vibrant. Such a Yunji Road is not daily, and its unique charm is nowhere to be found on other roads. This redesign of culture has made history and memory reappear on the stage in front of people, made it possible to become the collective memory of the city, and made the road of the diversification of redesign of the culture, thus, activating the city's self-healing power in the cultural sense. The three pocket gardens include the Salome Garden, Yuji Park, and Drawer Garden, and the five street gardens are the Time Gallery, Space-time Garden, Three-minute Garden, Step Garden, and Sunken Garden. Each independently depends on the surrounding environment with different boundaries, content, and problems to be solved.

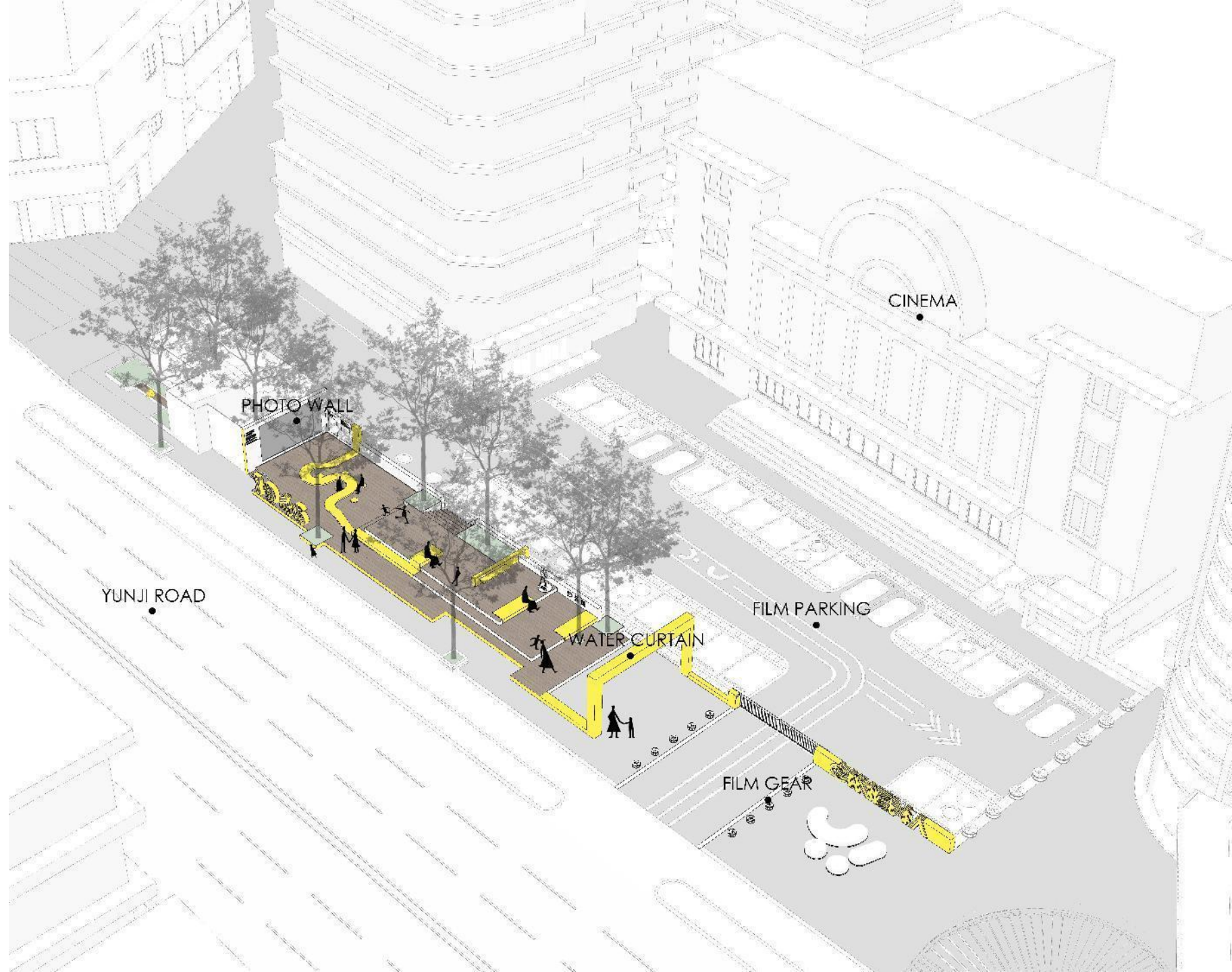

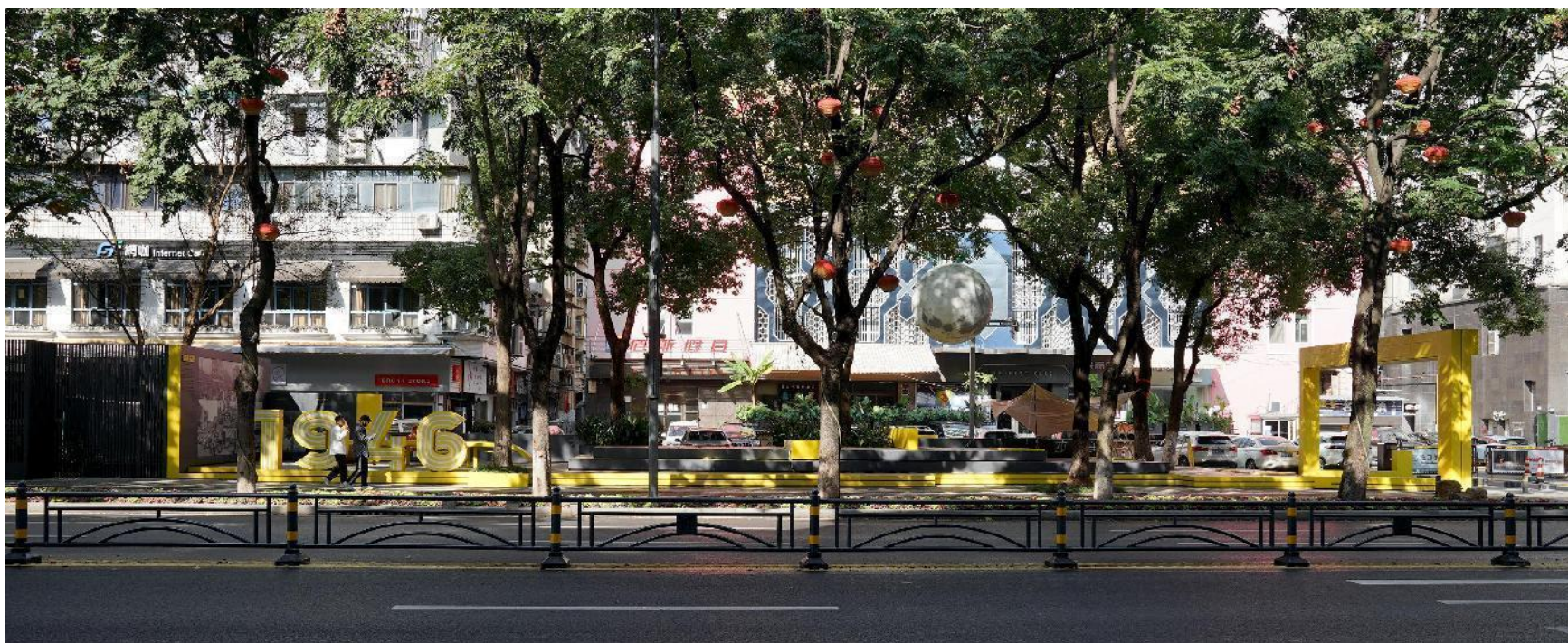



The Salome Garden is named after the Salome Cinema built there in 1946, which used to be the collective memory of the previous generation of Yichang citizens. Now, the cinema has become a bar, and the things left are ten high old camphor trees that witnessed history in front of the bar, and the collective memories of the past have been old photos and posters displayed in the city museum. Combined with surrounding urban leisure blocks, fragments of memories about the cinema are excavated and presented in the open space under the old camphor trees through brand-new design means, such as ground caving and paving, cultural wall, light and shadow device, old projector, and interactive movie water curtain device. This space will become a mixed-use urban open space integrating public entertainment under the forest, outdoor night bars, and meeting and waiting places.







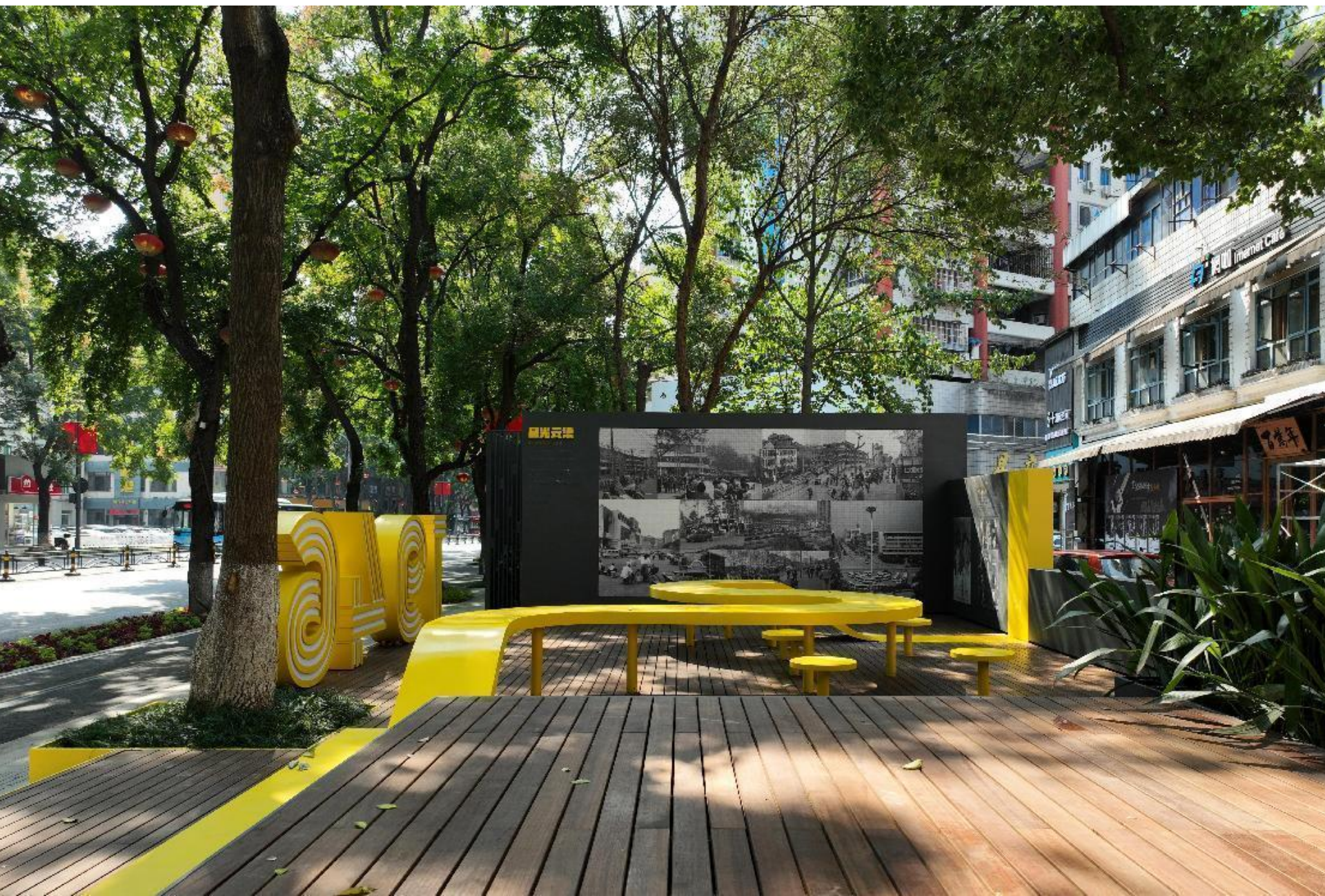





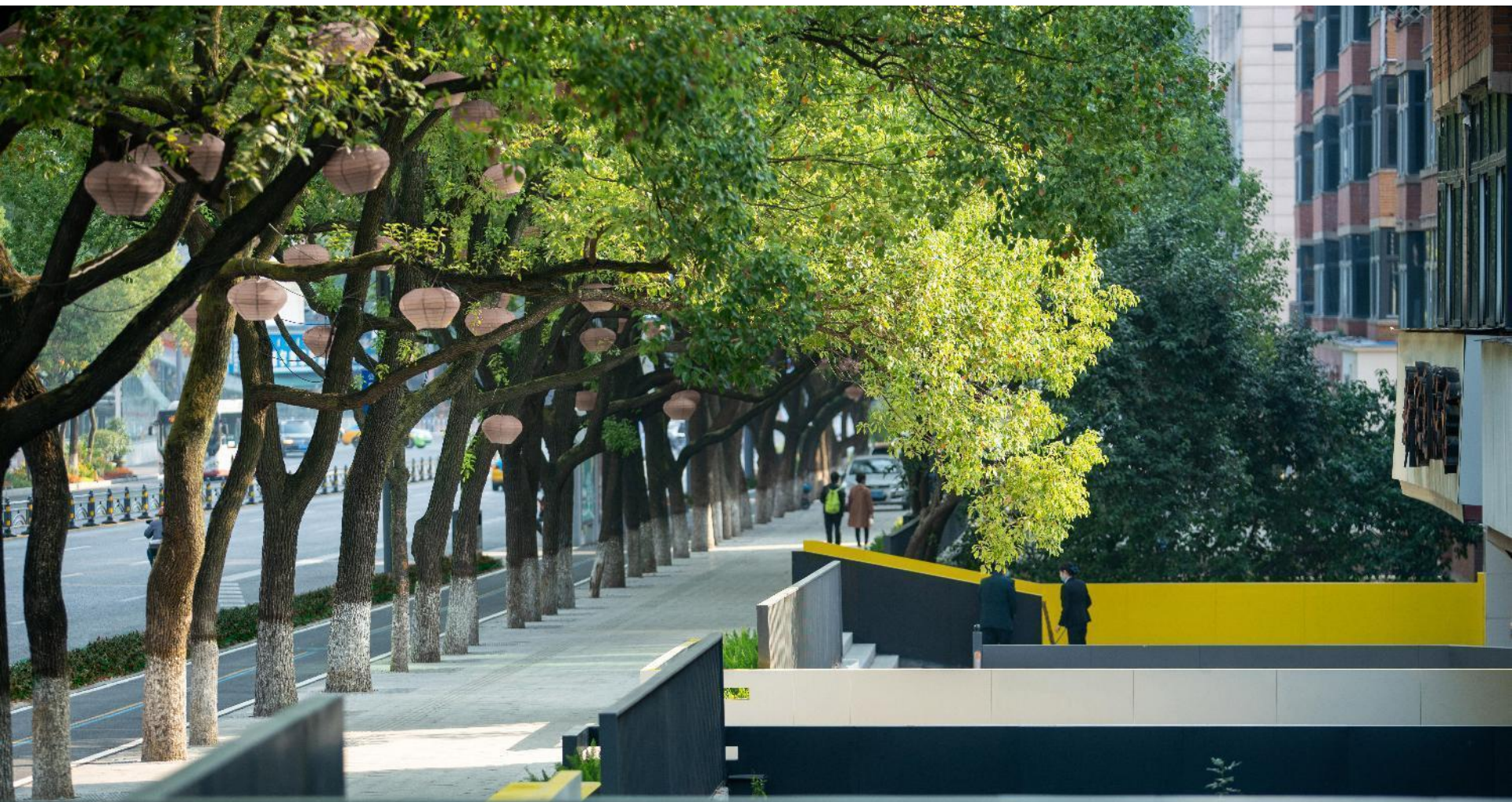

ODUINIDEAL CHENGDIANDIAN

The Drawer Garden takes advantage of the small bridges connected to the second floor of the street-facing building to form the roads into the community. With a unique small three-dimensional traffic style, the garden provides extensive space possibilities to the sidewalk boundary, which is flexible for shops and citizens. The 50-degree gray steel plates wrap the bridge railings along Yunji Road, creating row upon row of space interfaces while blocking the messy interface on the first floor of the buildings. With carefully configured perennial flower borders, it forms unique drawer gardens.



OUTDOOR FURNITURE

SUNKEN SPACE

DRAWER SPACE

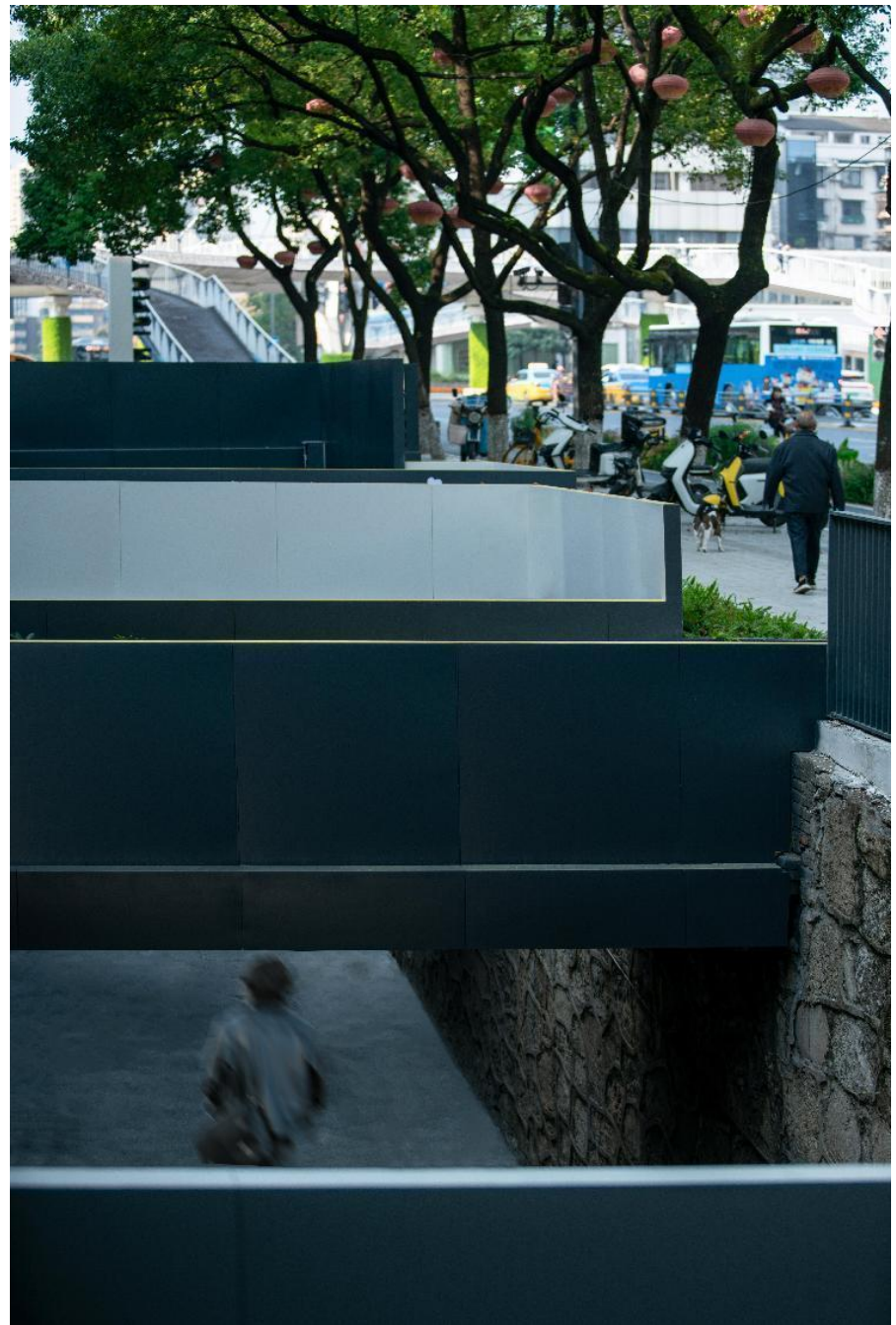





阳光很暖，电量很满

YANGGUAN GHENNUAN DIANLIANGHENMAN

WODUINIDEAI CHENGDIAND



As the first node at the west end of Yunji Road, the Time Gallery features a wall carved with characters and light corridors as a carrier of a long cultural scroll spread outdoors so that citizens can read past and present lives on Yunji Road in their leisure time while walking there.













The overall renewal of Yunji Road brings new power into the city. This power comes from the continuous open city corners, the open spaces under the trees, the rhythmic street rest corridors, the street space full of stories and history, and the dynamic interactive social space. These spaces turn the core axis of the city into a continuous ribbon-shaped garden full of possibilities and acceptance so that various people in the city can find their living places here, thus, activating the self-healing power of the power. After all, a generation will eventually grow old, and there will always be young people in the city.

The urban renewal of Yunji Road takes city spirit and memory as the blueprint. By sorting the original urban space organization and contexts, redistributing road functions and boundaries, blanking space, creating park scenes, structuring smart transportation, reappearing historical memory, and motivating commercial vitality, the project has brought direct social benefits, such as improvement of traffic efficiency, smooth low-carbon, and slow-traffic system, an increase of public activity space and activation of commercial activities along the street. The indirect social benefits include an increase in employment and medium-and-long term tax revenue, maximumly meeting the increasing material and cultural demands. The project has stimulated the old space, and activated the cultural self-healing power of the city, therefore, making the core axis back to the daily life of citizens.