

IFLA AAPME Awards 2024
Built Category : Culture and Traditions

GUANGZHOU YUNZHU HOTEL
GUANGZHOU, GUANGDONG, CHINA

Project Name : Guangzhou Yunzhu Hotel
Project Address : Baiyun District
City & Country : Guangzhou City, Guangdong Province, China
Area (sq.m) : 80,000 m²
Year of Design : March, 2021
Year of Completion : April, 2022

PROJECT STATEMENT

The hotel's overall layout resembles of a garden: flexible, open, with carefully arranged water features and stones, where every room enjoys a serene water view amidst the backdrop of mountains and rivers. Positioned as the future largest Lingnan garden-style "national hotel," its landscape design seeks to reconnect with the roots of traditional Lingnan culture while celebrating its rich history.

The hotel's overarching theme, "Yunzhu Xin Yuan, the Epitome of Lingnan" is divided into three distinct regions: East, Middle, and West. These areas—namely, "Vibrant Lake and Mountain," "Impression of Water Town," and "The Jade Chamer and the Scent of Books"—blend Guangzhou's most captivating natural landscapes, cultural traditions, and historical elements. They serve as a testament to the fusion of Lingnan's innate beauty, cultural heritage, and garden aesthetics. By utilizing an abstract design language, the hotel aims to eloquently capture and recreate Lingnan's garden landscapes and cultural legacies, resonating with both rationality and artistic expression across varying dimensions of interpretation.

Project Narrative and Contents

01 PROJECT BACKGROUND

The Yunzhu Hotel is located on the banks of Baiyun Mountain in Baiyun District, Guangzhou, on the Baiyun New Axis, adjacent to the Baiyun Mountain Scenic Area, with high-quality mountain and forest landscape resources.The total land area of the project is 115455.93 square meters, of which 73725.7 square meters can be used for construction and approximately 80000 square meters for landscaping.

The hotel boasts architecture and landscaping that adhere to international standards, showcasing the grandeur of a leading nation. It is poised to become the largest urban garden-style hotel group in the province. Positioned as the primary international culture communication center and foreign affairs hub in South China, the hotel's main function is to host representatives, government officials, and esteemed foreign guests from various nations who are attending international summits or global forums in Guangzhou. It serves as a venue for business negotiations, industrial introductions, government-enterprise discussions, exhibitions, trade training, and other important events.

02 PROJECT DESIGN HIGHLIGHTS

The six courtyards of Yunzhu Hotel are meticulously crafted to evoke the cultural essence of Lingnan Artistic School of Painting and Lingnan Calligraphy, while seamlessly integrating the craftsmanship techniques of Lingnan “Three Carvings and One Sculpture”. Through the application of modern landscape techniques, materials, and craftsmanship, they have successfully created modern hotel courtyards imbued with traditional Lingnan style. These courtyards have evolved into a Lingnan New Park, characterized by continuous innovation, inclusivity, and a pursuit of change and novelty within traditional Lingnan culture.

In the construction of the east courtyard, the artistic conception borrowed from the painting "Lake and Mountains Stretch Far" sets the tone for the Five-Star Courtyard, vividly depicting the warm spring scenery of Lingnan. The Yushan Garden, Juxian Garden, and Mingyin Garden, inspired by the picturesque scenery of " Vibrant Lake and Mountain", are intricately designed within the courtyard. These gardens, divided into entrance landscape, courtyard, and waterfront leisure trail areas, form a harmonious continuum. Moving from the lake in the north courtyard to the mountain in the middle courtyard, and finally to the forest in the south pavilion, visitors experience a transition from sparse to dense landscapes, creating a captivating New Lingnan panorama.

In contrast, the cultural creation of the western courtyard is rooted in the renowned Guangdong style of "One Stone, three Inkstones" showcasing rare treasures such as the Qianjin Monkey King inkstone, Yanhua Four Elephant inkstone, and Jiuyun Tai Chi inkstone. Inspired by the artistic conception of "the fragrance of books in the jade hall, three inkstones in one pool," the courtyard features Bonsai Garden, Inkstone Pond Garden, and Ink Painting Garden. As visitors meander through the courtyard, they will encounter a progression from the Inkstone Pond Garden in the side courtyard to the characteristic Ink Painting Garden and the Bonsai Garden, the view transitions from dense to sparse. Strolling amidst the sparse forest and flower shadows, one can experience the charm and comfort of mountain and water bonsai, appreciating the rich Lingnan culture.

Location Analysis



Yuncheng Central 2nd Rd

Yuncheng West Rd

Design Scope

Yuncheng Central 1st Rd

Master Plan

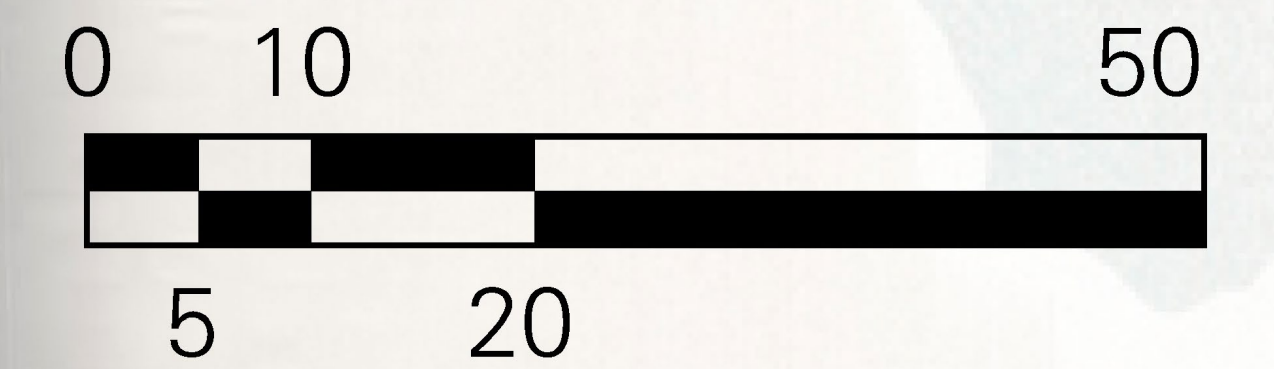
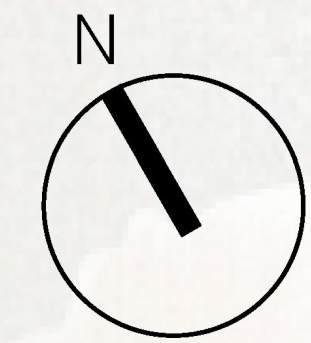

Design Ideas

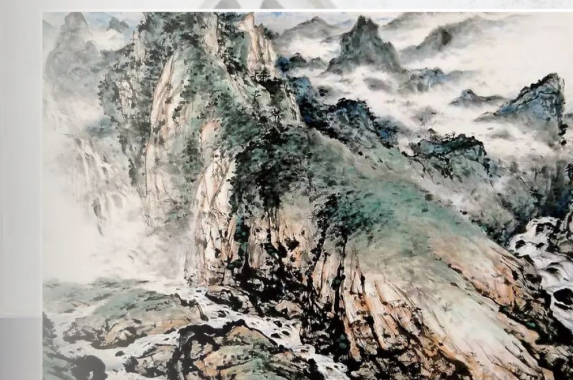

Lingnan School of Painting



Lingnan Calligraphy

LEGEND

- 01 Five Star Hotel Entrance
- 02 View of the Entrance to the Five Star Hotel
- 03 Five Star Hotel North Courtyard
- 04 Five Star Hotel Middle Courtyard
- 05 Five Star Hotel South Courtyard
- 06 VIP Private Room
- 07 Four Star Hotel Courtyard
- 08 Corridor Water Court
- 09 Specialty Hotel Courtyard
- 10 Four Star Hotel Entrance
- 11 Waterfront Leisure Trail



Yushan Garden:

With the help of modern Mirror Water Feature Craftsmanship Standards and patented technology for thin pool walls, ensure the successful implementation of Yushan Garden's water feature construction. The green island, inlaid with black mountain stones, has a dignified and elegant color scheme, paired with the winding and vigorous branches of Holly, filled with poetic essence and becomes the finishing touch and soul of the scenery in the "One Pool, Three Mountains" space.



Juxian Garden:

It adopts a zigzag pedestrian flow line, with a ratio of 1:2 between greenery and water features. The water body simulates multiple streams passing through the green island and finally converges into a complete pool of water, fully reflecting the interdependence between the water body and natural terrain, as well as the cleverly coordinated layout relationship.



Mingyin Garden:

The pond is surrounded by modular cutting to create a free and dynamic pond shore, combined with natural black paving stones with textures resembling traces of water flow, to enhance the dynamic and aesthetic of the water.

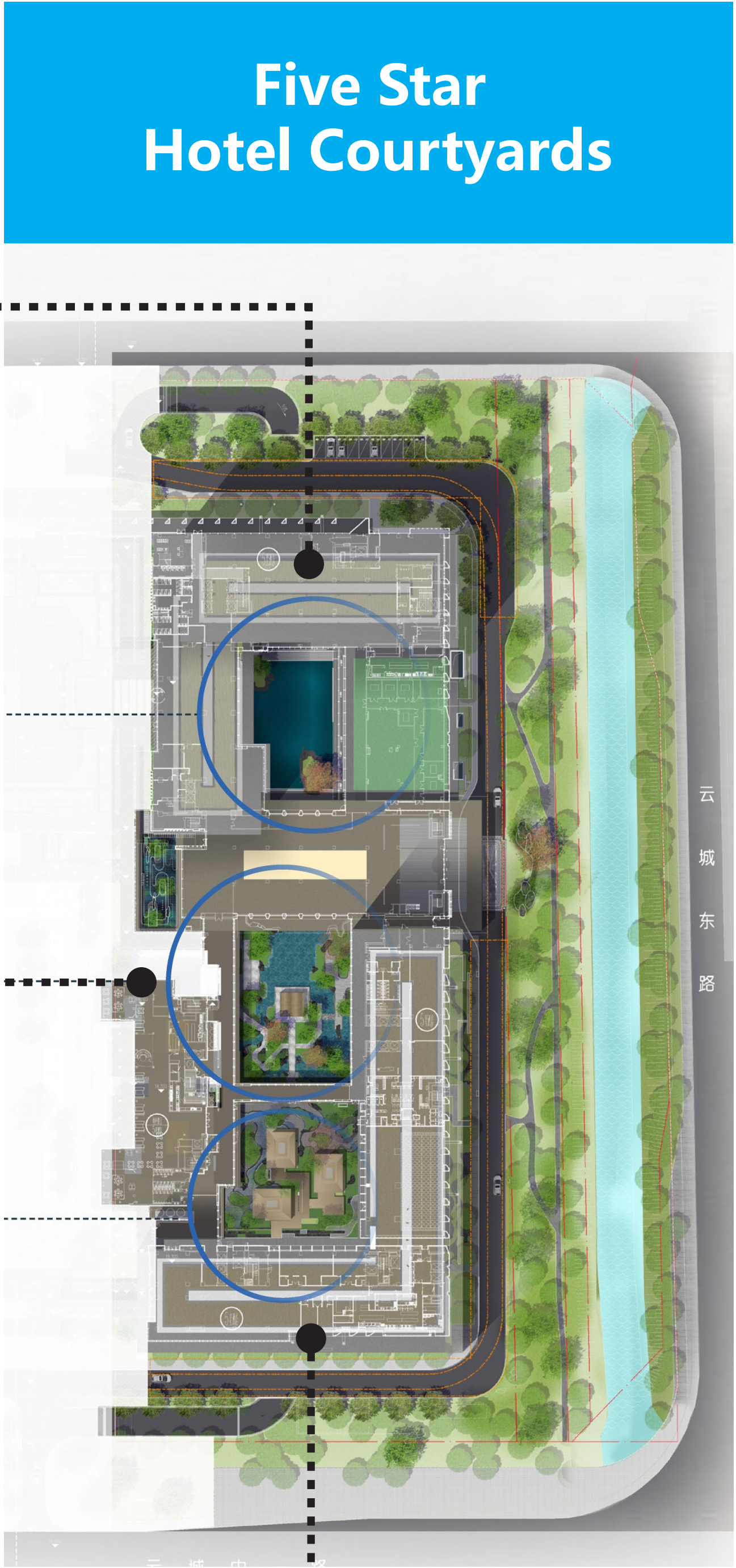

Yushan Graden—— Five Star Hotel North Courtyard

Yushan Garden combines the traditional garden layout of "One Pool, Three Mountains" in the Palace of Nanyue Kingdom to form a secretive and luxurious scenery. In the creation of the details and artistic conception of the garden, people can see a pine forest and a green pool when sitting on the terrace of the pool. The surface of the pool reflects the tree shadows in the morning light, echoing the rise and fall of clouds and fog, carrying countless changing auras. The spatial circulation line of Yushan Garden adopts a closed-loop flow line. When people look out from the indoor to the garden, the view becomes wider, and the poolside path could guide them deeper into the garden.



Yushan Garden
Night View

Yushan Garden
Interior View

Yushan Garden
Partial View





Juxian Garden—— Five Star Hotel Middle Courtyard

Juxian Garden serves the middle courtyard. The conception of the garden aiming to restore the scene from *Lake and Mountain Panorama*, where the Juxian Pavilion is situated in the realm of mountains, misty waves, and clouds. In the meaning of Juxian, it refers to a place where wise and talented people gather through the music, experiencing either the leisure of white clouds or the joy of green mountains. Therefore, in this design, a pavilion and corridor are positioned in the center of the pond, utilizing curved pavilions, gazebos, rockeries, and stones to create a naturally beautiful and elegant landscape. The entire space is planned with a zigzag pedestrian flow line, with a ratio of 1:2 between greenery and water features. The pavilion and corridor adopt a palace lantern shape, featuring eaves decorated with Cantonese carving patterns of phoenixes and dragons, as well as motifs of jade pendants with overlapping rings. The central atrium, adorned with a serene water feature promenade, are surrounded by a seamless glass facade to allow natural light and scenic views enter the interior.



Juxian Garden Night View

Juxian Garden
Aerial View

Juxian Garden
Human View



Mingyin Garden—— Five Star Hotel Middle Courtyard

The landscape of Mingyin Garden is designed with the artistic conception of "The Sound of Strings Beneath the Forest" as the theme. Different levels of plant landscapes are used to intertwine among three pavilions and corridors. In this garden, water and rock are closely integrated to create a landscape of mountains and lakes, providing a sense of leisure and elegance. Among the corridors, the drizzling rain on the old pine trees brings the natural scenery into the room, blurring the boundary between indoors and outdoors, just like falling into a fairyland on earth.



Mingyin Garden
Partial View

Mingyin Garden
Human View

Four Star Hotel
&
Specialty Hotel Courtyards

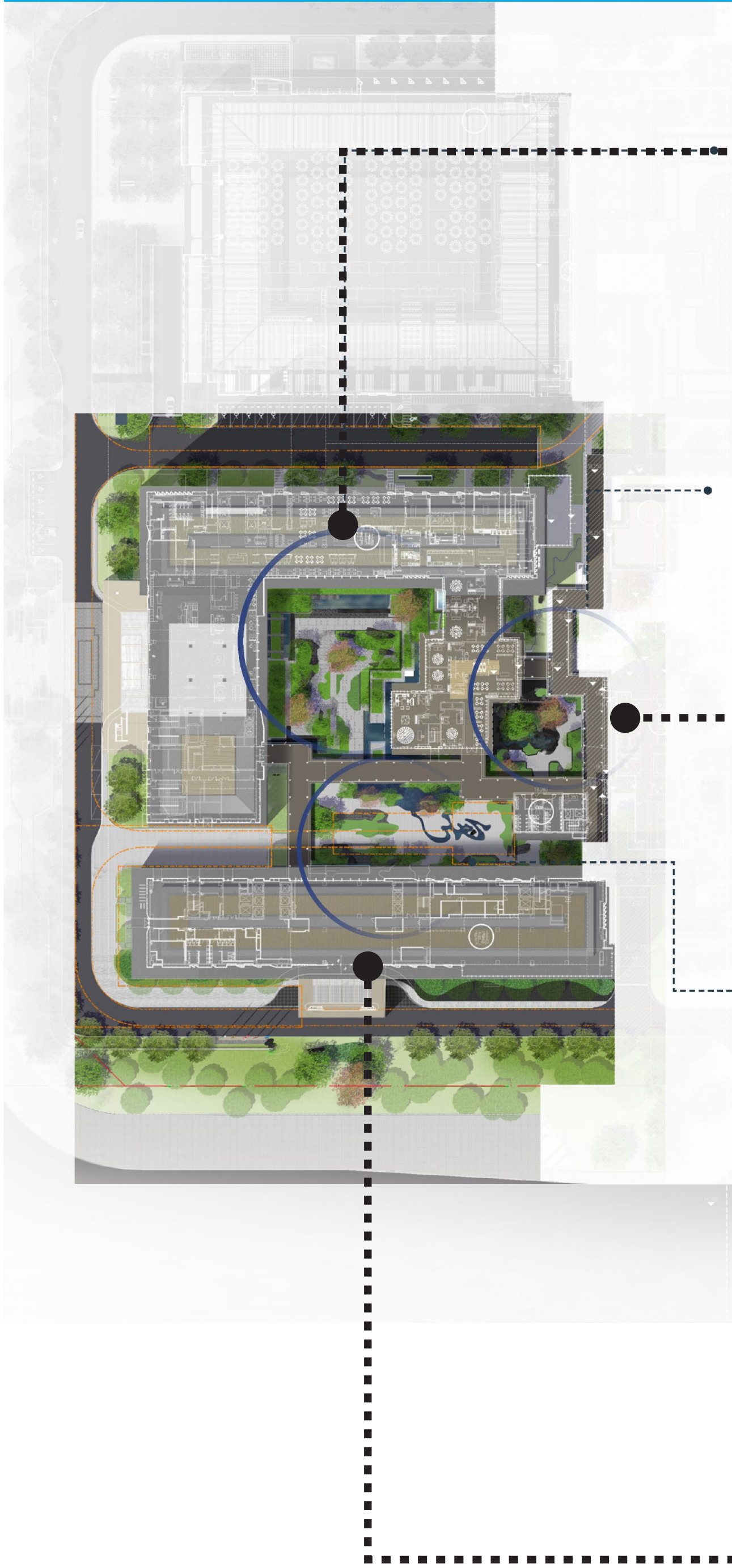

Bonsai Garden:

The bonsai garden is built with stacked stone platforms, and the path meanders through the gardens. The bonsai plants are specially selected, including Curved Holly, shaped Elm trees, Five-needle Pine bonsai, Small-leaf Purple Sandalwood bonsai, Camellia bonsai, and other exquisite Lingnan plants, with pomegranates scatter around the garden.



Inkstone Pond Garden:

Extracting inkstone patterns in a parameterized form, cutting the huge black stone into whole stones to create a beautiful flowing inkstone as a point landscape, combined with a strip of flowing water, as the focal point of the four-sided corridor.



Ink Garden:

The courtyard water landscape of the Ink Painting Garden is a water landscape construction practice for firefighting climbing sites. Through the form of paving and slotting on the ground, a "Yue" shaped water landscape is formed. Water gushes out from the three-dimensional inkstone and flows into the ground, making water and paving together form the central landscape of the Ink Painting Garden.





Westside Hotel Courtyard Aerial View

Bonsai Garden—— Four Star Hotel North Courtyard

The bonsai garden is designed with the imagery of "One Stone, Three Inkstones", incorporating precious flowers, trees, and bonsais of Lingnan. As people wander through the sparse woods and flower shadows, they can feel the charm and serenity of the landscape bonsai. The water is likened to ink, and the shape of the inkstone is compared to the landscape pond, which is arranged in the courtyard with branches extending outwards. When the wind blows, the sparse shadows rustle, bringing elegance to the heart and uniqueness to the residence. By building terraces with layered stones, the pedestrians are orderly guided to the landscape flower pond, experiencing the precious bonsai scenery of Lingnan. This creates a sense of wonderment in observing the sky, strolling through the exotic forest, and traversing the sparse shadows for the visitors.



Bonsai Garden
Aerial View

Bonsai Garden
Human View

Bonsai Garden
Partial View

Inkstone Pond Garden—— Four Star Hotel Middle Courtyard

The Inkstone Pond Garden is inspired by the Thousand Monkey King Inkstone, whose shape resembles a lively monkey squatting on its side and turning its head back. The surface and back of the inkstone are ingeniously designed to evoke the atmosphere of Huaguo Mountain and Water Curtain Cave, creating a landscape for the side garden of the four-star hotel. The Inkstone Pond Garden features a corridor water pavilion with an inkstone-shaped base, adorned with hanging ornaments that depict the architectural symbols of Lingnan. As one enters the garden, one is greeted by a uniquely designed curved water landscape inspired by the texture of the Thousand Monkey King Inkstone. As well as the long and delicate stream of water resembles ink droplets in a painting, dripping and falling into a riot of colors. Thereby, this garden integrates the essence of various elements, creating a rich scholarly ambience.



Inkstone Pond Garden
Aerial View

Inkstone Pond Garden
Partial View



Ink Garden—— **Specialty Hotel Courtyards**

Ink Garden is inspired by the artistic conception of the Yanhua Four Symbols Inkstone, also known as "Crane Inkstone", to form a picture of pine and crane. After passing through the corridor, there is a unique creation combining the "Crane Inkstone" culture of Lingnan with the original "Yue" calligraphy style. And walking in the garden is like entering a painting, with the Snow Plum and Double Crane Picture slowly unfolding before the eyes, creating a rich cultural experience of Lingnan.

Ink Garden
Aerial View

Ink Garden
Partial View

