

IFLA AAPME Awards 2024

Award Categories - Unbuilt Category

Project Binder for

CULTURE-CITY INTEGRATION BASED ON USER
INVESTIGATION: Feixi Jinzhai Road Urban Renewal

Project Name : CULTURE-CITY INTEGRATION BASED ON USER INVESTIGATION: Feixi Jinzhai Road Urban Renewal
Area : 5.6KM along side the road, 18240m²
City Country : Feixi District, Hefei City, Anhui Province, China

PROJECT STATEMENT

As urban development in China accelerates and the living standards of its people continue to improve, citizens' demands for the quality of their urban living environment are also growing. Having experienced decades of rapid urban construction, the quality of street green spaces in many Chinese cities has gradually become insufficient to meet the visual, cultural, and functional needs of urban residents over time, necessitating urgent updates.

In the context of China's urban renewal transitioning from an era of incremental growth to one of optimizing existing assets, this project proposes a design approach guided by resident needs. Based on thorough research into user types, needs, behavioral characteristics, and perceptions of the urban portrait, environment and culture, it aims to integrate local urban culture, street functions, and environmental aesthetics with street spaces by the method of landscape narrative expression, comprehensively enhancing the cultural image, green space quality, and user experience of the green spaces along Jinzhai South Road in Feixi County, Hefei City.

PROJECT NARRATIVE AND CONTENTS:

1. Project Background

Jinzhai South Road, located in Hefei City, Anhui Province, China, spans a total length of 5.6 kilometers. As a historically significant urban thoroughfare, Feixi County, where it is located, boasts a unique and superior natural environment and a rich historical culture. The area is renowned as the home of the Huai Army, the Pearl of Chaohu Lake, and the town of flowers and trees. Jinzhai Road connects Hefei's main urban area with the county center, occupying a central position along the city's north-south axis and serving as a crucial urban traffic artery. Along the route of Jinzhai Road, numerous landmarks deeply embedded in Hefei's collective memory can be found. The development and transformation of this road, including the construction of the Jinzhai Road Overpass, are key components of the Hefei municipal government's "Great Construction, Great Development" initiative. It serves as a vital link between the old city and the emerging economic and technological development zones, administrative and cultural districts, and high-tech development areas, holding significant importance for urban development.

However, due to historical reasons, the areas along Jinzhai South Road currently face issues such as insufficient green spaces, outdated infrastructure, and a lack of cultural identity. These problems make it challenging to meet the increasing demands of residents for urban living environments. In this context, the project aims to fully explore the unique characteristics of the urban area, highlight the regional image of the city, and use urban memory as a link to tell and showcase the city's features and stories through street spaces, thereby enhancing the recognizability, aesthetics, functionality, and readability of urban street spaces.

2. Problems and Strategies

During the site environment survey, we identified three main categories of issues:

- 1、 Environmental Issues: Including poor quality green spaces, lack of plant diversity, and exposed soil, etc.
- 2、 Infrastructure Issues: Including Outdated urban furniture, exposed and deficient infrastructure, etc.
- 3、 Cultural Identity Issues: Including dull and unengaging cultural promotion content, lack of cultural recognizability, Inconsistent cultural language and style, and missing cultural facilities, etc.
- 4、 Space Vitality Issues: Including limited spaces for activities, lack of interactive and experiential space facilities, and monotonous and unappealing spatial functions, etc.

Project Goals and Objectives

To address these issues, the project proposes three main goals for the street green space renovation:

1. Improving Green Space Quality: Enhance the quality of green spaces along Jinzhai South Road.
2. Activating Space: Increase the vitality and usability of the spaces.
3. Strengthening Cultural Identity: Enhance the cultural image and identity of the area.

Based on the current conditions, types of green spaces, surrounding environment, and usage patterns, the project will identify and classify available green space areas. Ultimately, 48 specific points will be selected for detailed updates.

3. Concept and Approach

Given the increasing emphasis on landscape experience and cultural perception in urban landscape design, this project proposes a street space renewal model guided by residents' needs and employing landscape cultural narrative as the main method. Firstly, the project segments the main road and dense points for user questionnaire surveys, conducting in-depth and detailed analyses of user types, behavioral characteristics, functional preferences, and cultural interests (e.g., interactive, educational, innovative entertainment, promotional, and functional preferences). From the survey results, the most frequently mentioned urban intentions and potential user scenarios for the Feixi area (such as walking, jogging, resting spaces, children's play/parent waiting areas, leisure fitness spaces, friend gathering spots, and themed street activity scenes) are extracted to provide data and information support for subsequent design.

After thoroughly analyzing and extracting the survey information, the project considers the site's baseline conditions, user needs, and cultural narratives to develop thematic space features and renewal techniques. The project uses "Time in Feixi" as the main theme, incorporating local resources and dividing the area into three major themes: Chronicle of Objects, Geography, and Biography. Through scene recreation, interactive facilities, and thematic exhibitions, a landscape narrative sequence is constructed. Relevant cultural elements are extracted and embedded in the selected update points, forming a culturally distinctive landscape street in Feixi.

Specifically, In the Geography Chronicle theme section, the plan integrates Feixi's historical context and scene stories with landscape elements such as scenic walls, structures, and interactive facilities to create a visually impactful and interactive Feixi historical and cultural memory corridor. In the Biography theme section, the project features the contributions and life stories of historical Huai Army figures from Feixi, such as Liu Mingchuan and Zhang Shusheng, creating unique urban reading and exhibition spaces dedicated to these historical figures. In the Objects Chronicle theme section, the project extracts characteristic elements of Feixi, such as plants like magnolia, osmanthus, and peach blossoms, and local delicacies, to create an interactive space that offers an experiential journey through Feixi's historical and cultural heritage.

For cultural application and placement, the project selects and extracts cultural elements from the highest-mentioned regional intentions in the survey, integrating these elements into the space in terms of form, elements, colors, and plants. These elements are combined with space functions through urban furniture, image exhibitions, municipal facilities, and art installations. Interactive experiences are created through cultural education, interactive facilities, and themed activities, resulting in comprehensive cultural image integration. This enhances the recognizability of the cultural image of the space and increases the interest and engagement of cultural experiences within the site.

4. Site Outcomes

Based on the aforementioned design principles, the final design scheme has achieved the following improvements for the site:

For the section from Shimen Road to Jinxiu Avenue, the overall green space coverage has increased by 24%, the usable space has increased by 18%, and 8 pieces of urban furniture have been added. Additionally, 6 new cultural facilities have been introduced, including 2 interactive cultural facilities, 3 educational facilities, and 1 promotional cultural facility.

For the section from Jinxiu Avenue to Ziyun Road, the overall green space coverage has increased by 30%, the usable space has increased by 22%, and 5 pieces of urban furniture have been added. There are also 5 new cultural facilities, including 1 interactive cultural facility, 2 educational facilities, 1 innovative cultural facility, 1 functional cultural facility, and 1 promotional cultural facility.

For the section from Ziyun Road to Tangkou Road, the overall green space coverage has increased by 20%, the usable space has increased by 14%, and 5 pieces of urban furniture have been added. This section also includes 3 new cultural facilities: 1 interactive cultural facility, 1 educational facility, and 1 functional cultural facility.

Finally, for the section after Tangkou Road, the overall green space coverage has increased by 10%, the usable space has increased by 12%, and 5 pieces of urban furniture have been added. This section also features 3 new cultural facilities, including 2 promotional facilities and 1 functional cultural facility.



LOCATION ANALYSIS

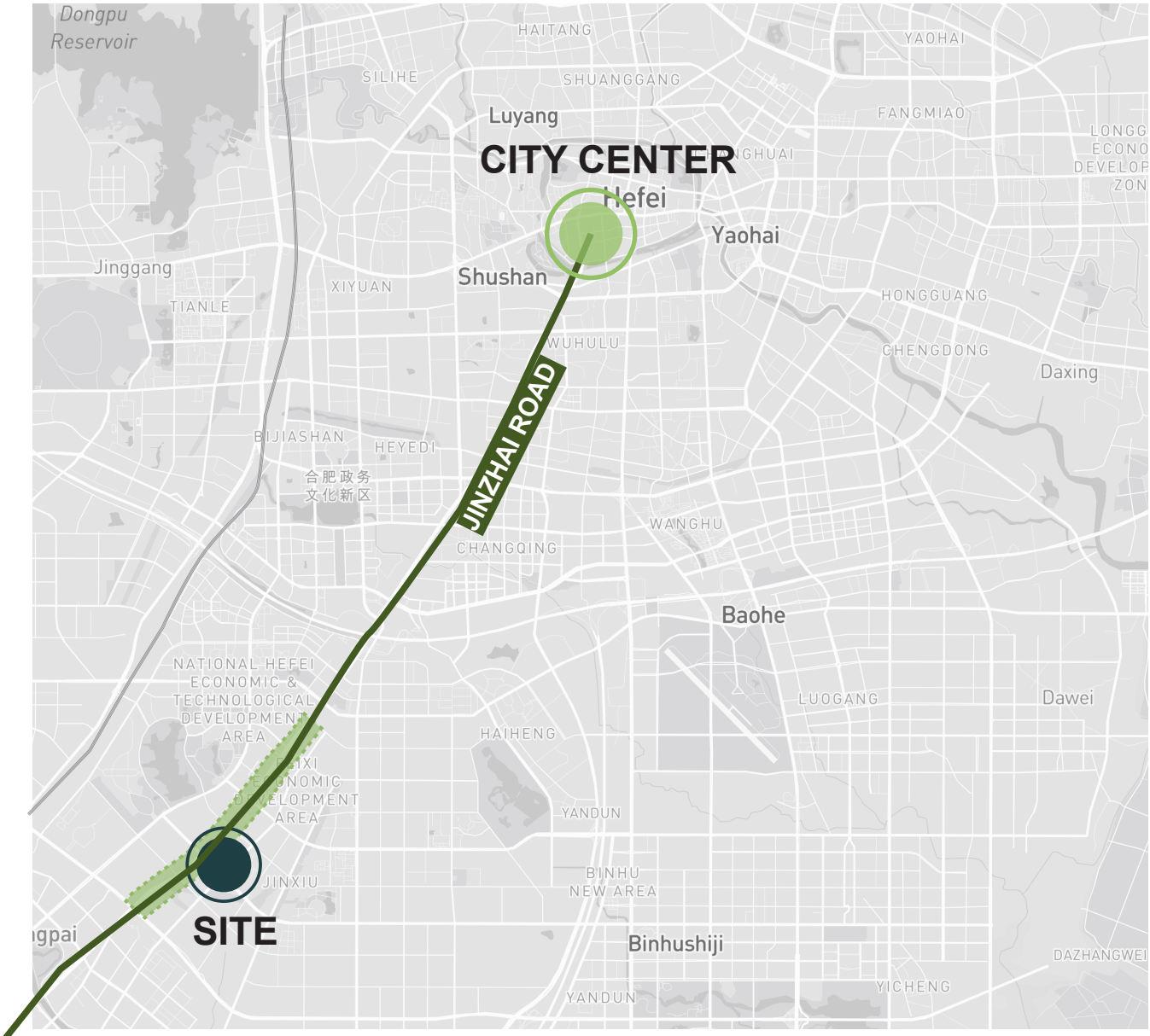
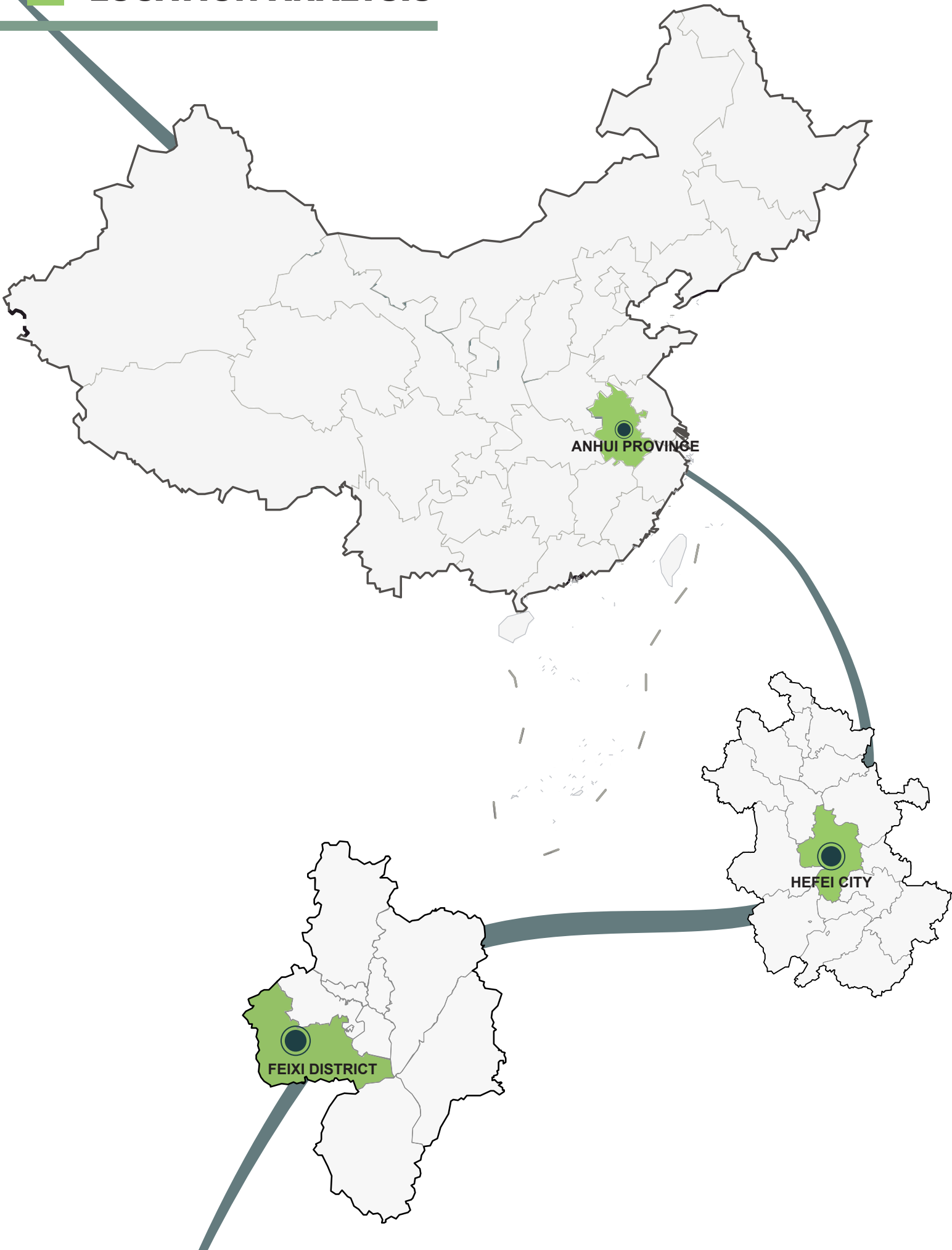

The project is located in Feixi County, Hefei City, Anhui Province, China. The road connects the dual centers of the county, serving as a link between the old town and the emerging Economic and Technological Development Zone, the Government and Cultural New District, and the High-Tech Development Zone.



STATUS QUO

LACK OF ACTIVITY SPACE, LOW SPACE UTILIZATION

People do not share the same lanes, resulting in cramped spaces for slow-moving traffic, leading to a poor experience. The main areas on both sides of the street are used for parking, leaving insufficient space for activities, and the ownership of some of the land is unclear.



MONOTONOUS VEGETATION SPECIES, LACK OF PLANTS COLOR

The quality of street trees varies, with significant inconsistencies. The planting on both sides of the street is irregular and chaotic, resulting in a cramped space, and the plants lack color.

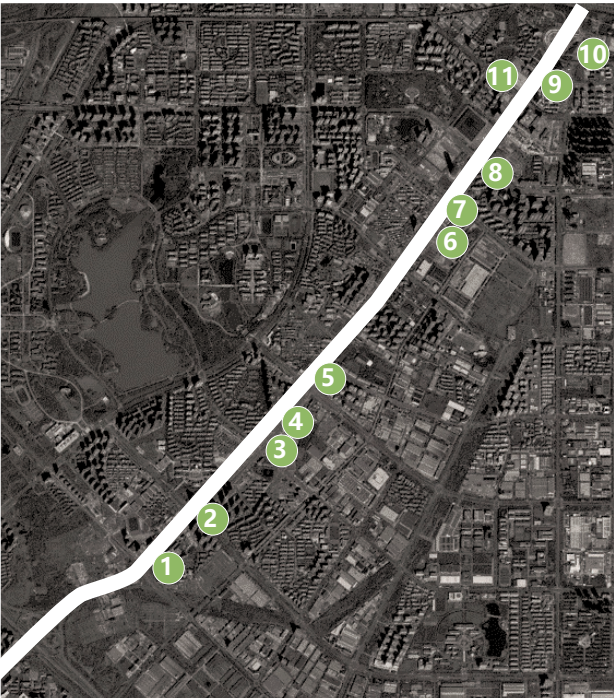

OUTDATED PUBLIC SERVICE FACILITIES, POOR OVERALL IMAGE QUALITY

The style of urban furniture is inconsistent, placed haphazardly, and lacks organization. The signage system is missing. There are numerous urban walls and enclosures, with internal areas that are unmanaged and out of control, posing safety hazards and affecting urban sanitation.

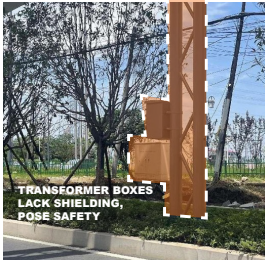
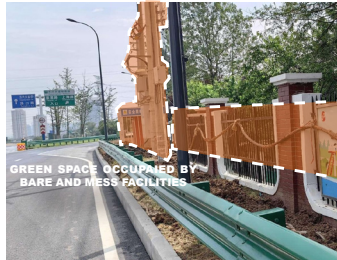
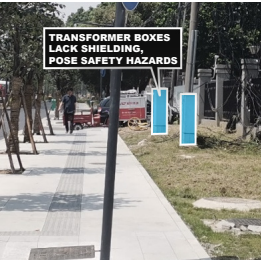
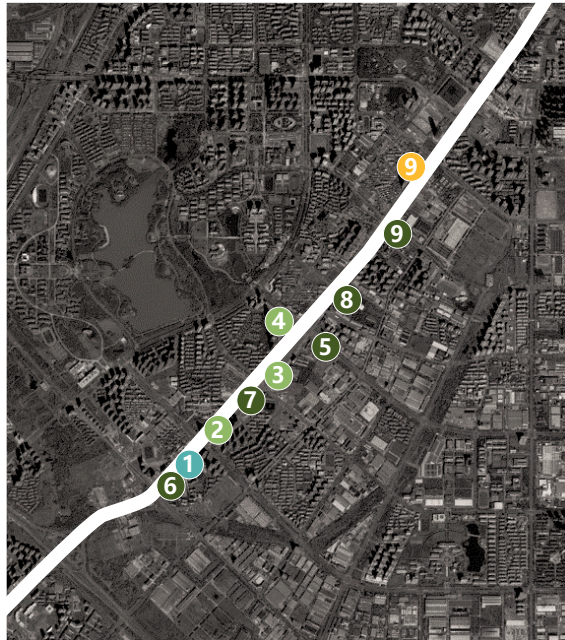

LOW CULTURAL IDENTIFICATION, LACK OF CULTURAL FACILITIES

The cultural promotional facilities and content along the entire project route are monotonous, failing to highlight the city's cultural image. Available cultural facilities are quite lacking, and there is no clear and defined system for the application of cultural elements along the route. The regional cultural identity is weak, and the uniqueness is insufficient.

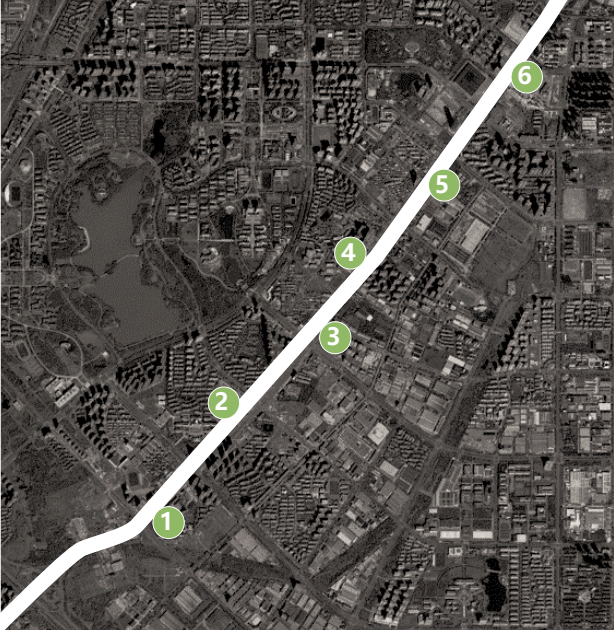

SITE ANALYSIS

JINZHAI ROAD--LINK THE PORTAL IMAGE OF HEFEI AND FEIXI

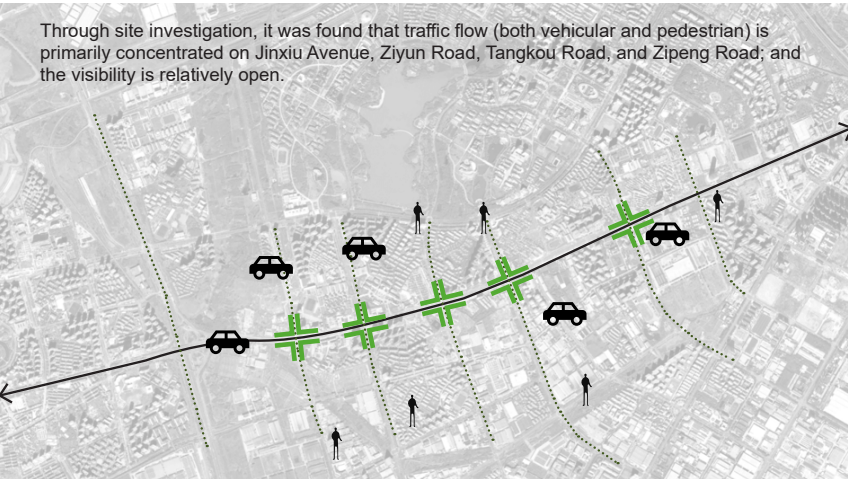
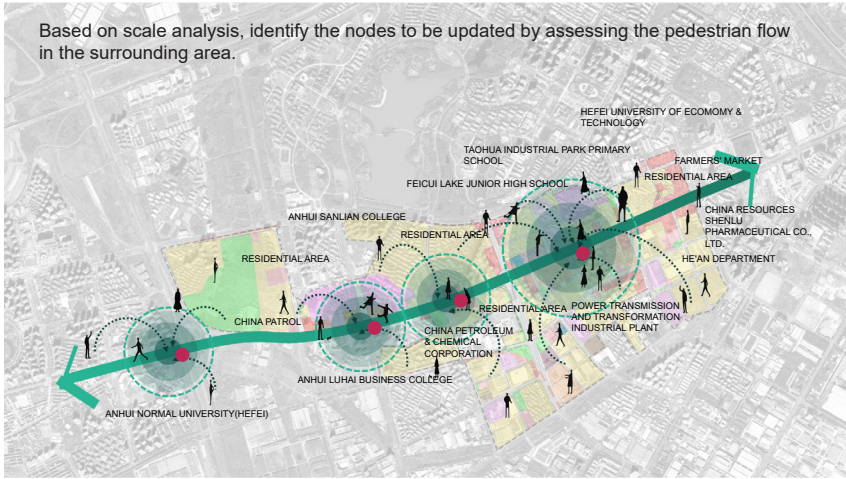

EXISTING GREEN SPACE PROTOTYPE

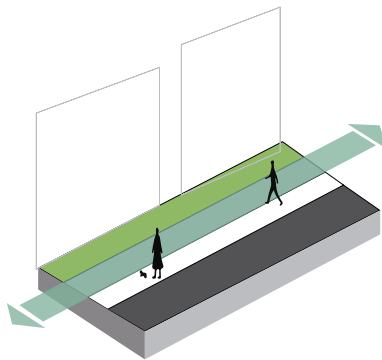

SPOT SELECTION

Based on the current conditions, types of green spaces, surrounding environment, and usage patterns, the project

48 SITE SELECTED

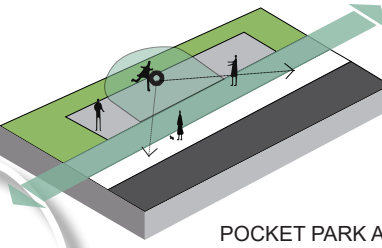
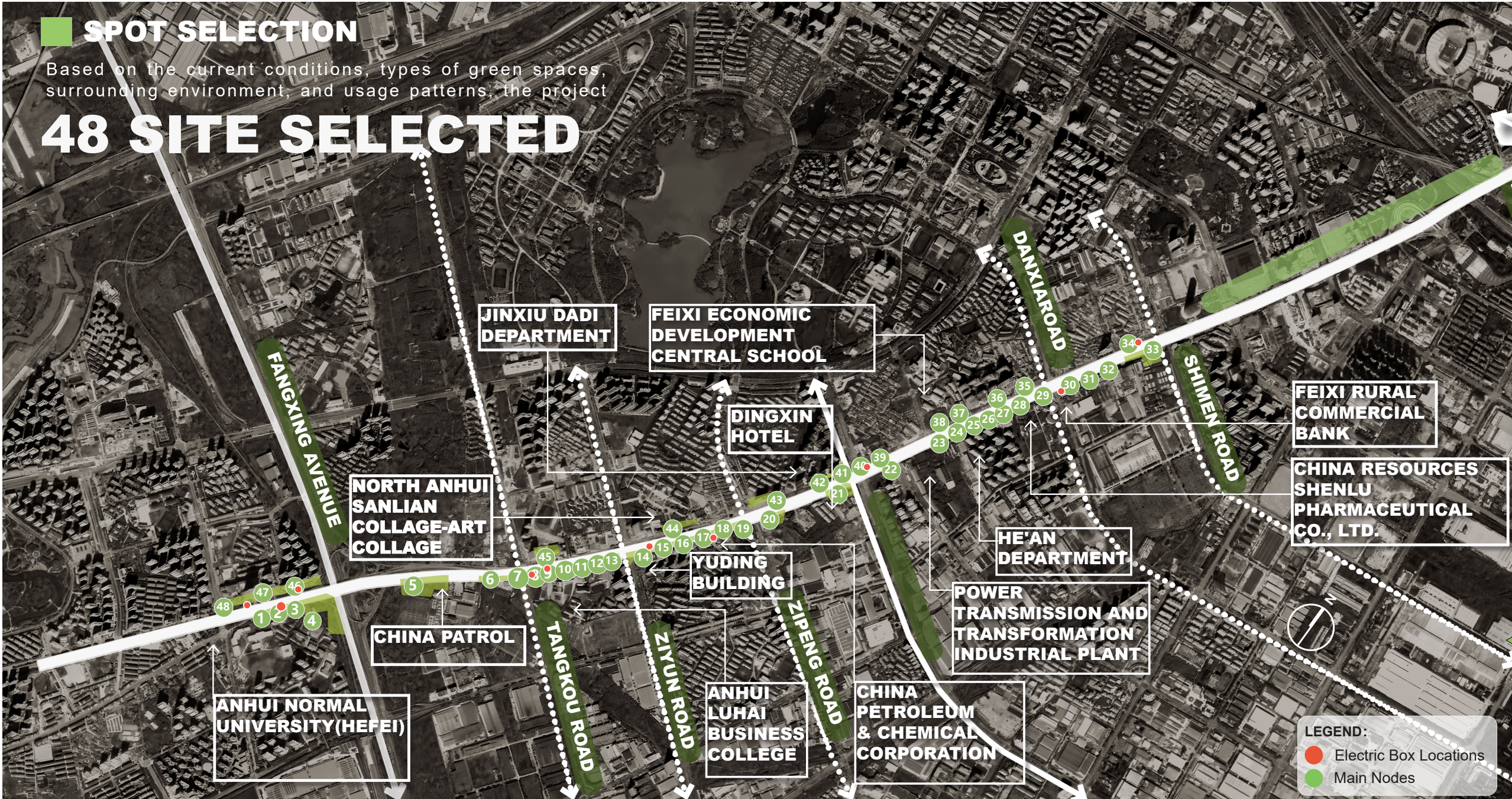

POCKET PARK ALONG SIDE THE ROAD

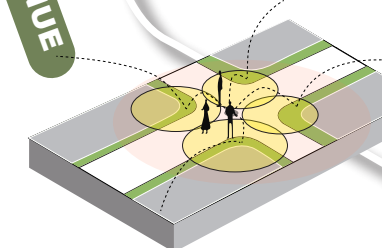

GREEN SPACE ON THE STREET CONNER

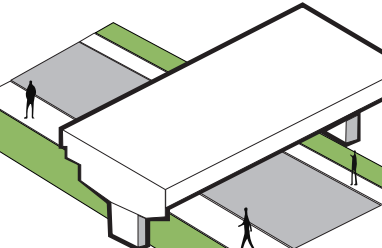

UTILIZATION OF SPACE UNDER BRIDGES

USER TYPES AND PROPORTIONS

The project divides the main roads and surrounding functional areas into 4 segments and conducts research on each segment. This includes studying the types of users of the street green spaces, their behavioral characteristics, functional needs and preferences, cultural preferences, and impressions of the city.

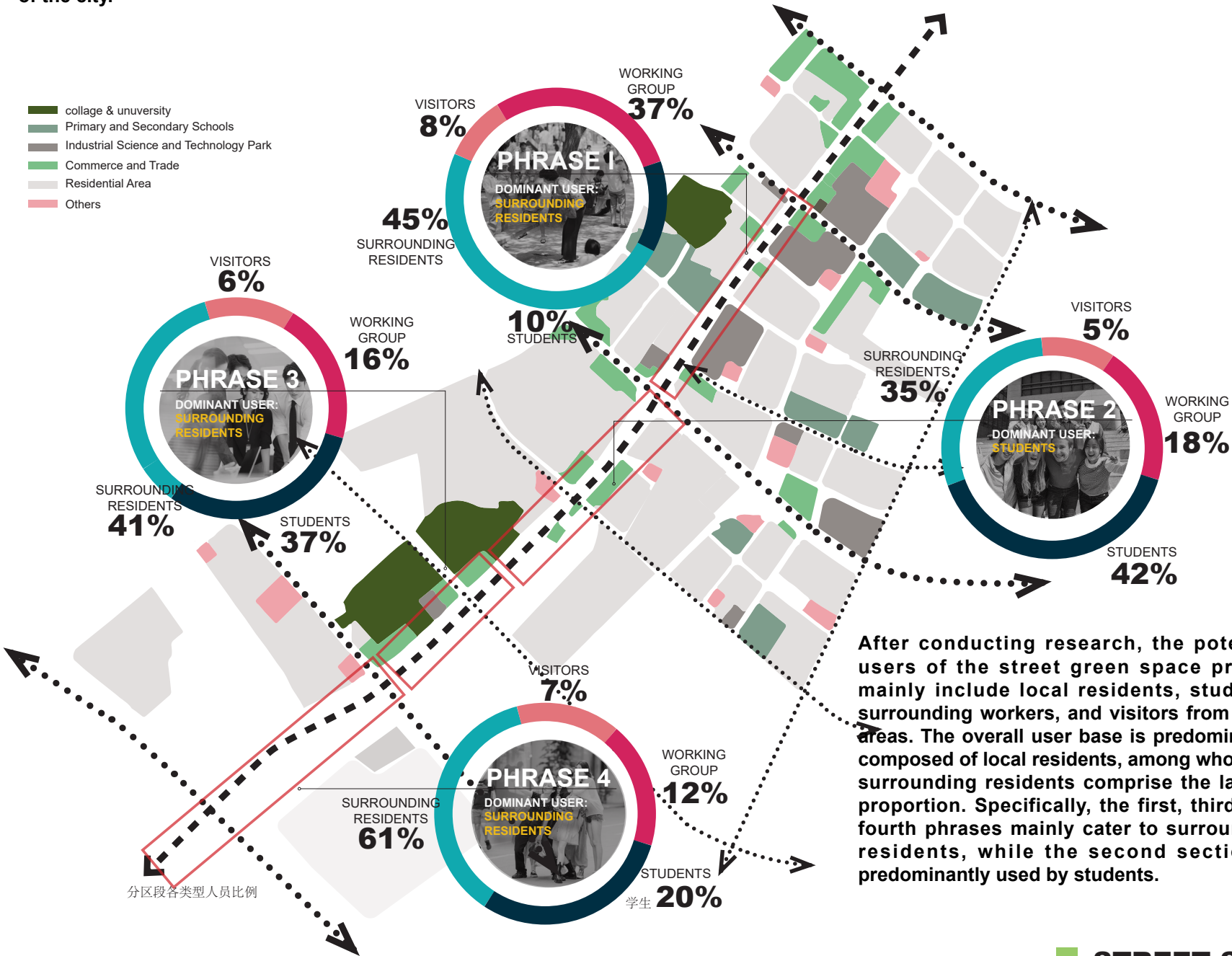

ANALYSIS OF USER DEMANDS AND PREFERENCES

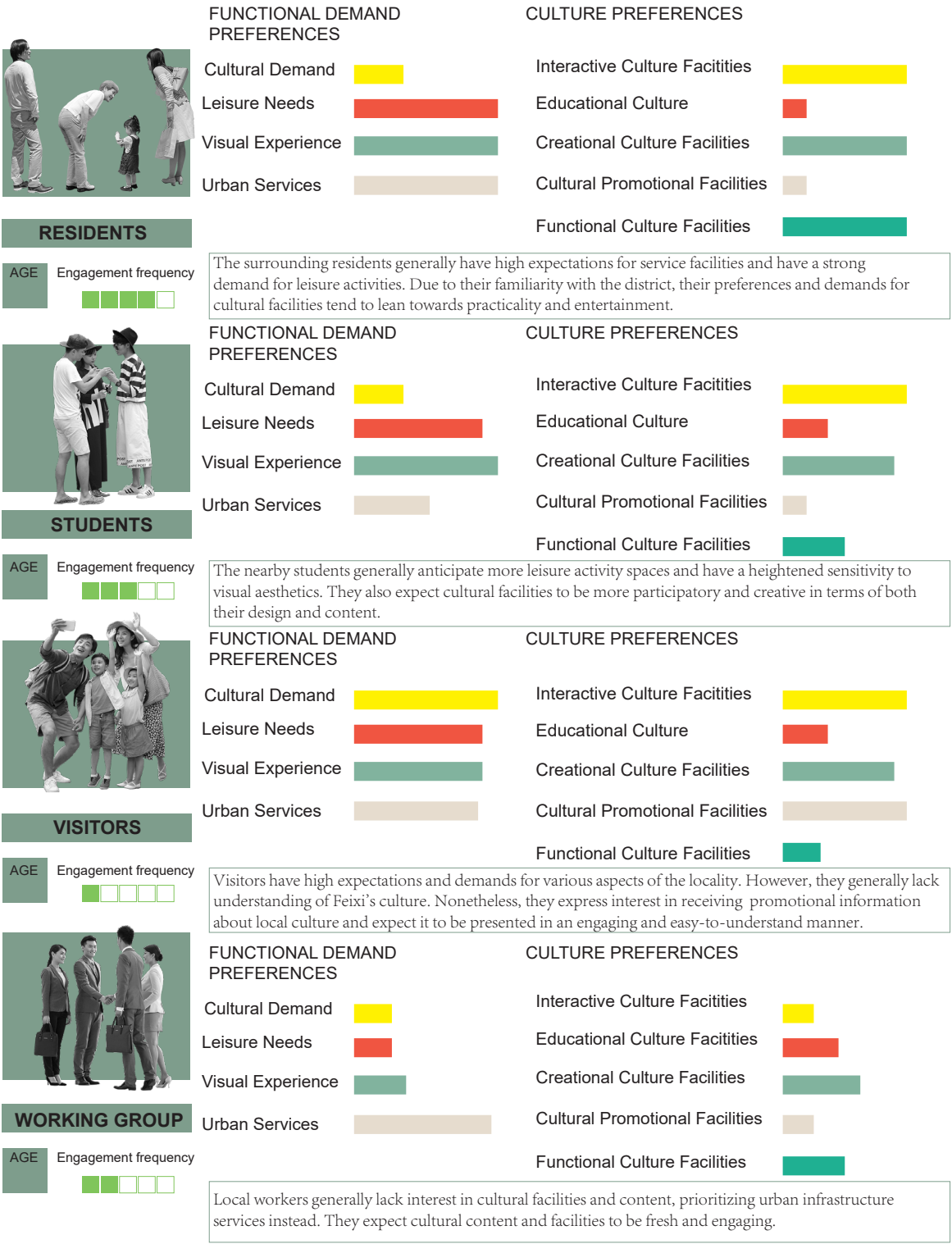

CULTURAL IMPRESSION OF THE CITY BY USERS

Extracted from the impressions of the survey respondents regarding Feixi and Jinzha Road, the following intentions were mentioned



STREET SCENE USAGE VISION BY USERS



CULTURE RESOURCE ANALYSIS

UNIQUE AND SUPERIOR NATURAL ENVIRONMENT, PROFOUND HISTORICAL AND CULTURAL DEPOSITS, AND RICH RESOURCES OF SCIENTIFIC AND EDUCATIONAL TALENTS HAVE JOINTLY SHAPED A VARIETY OF FEIXI

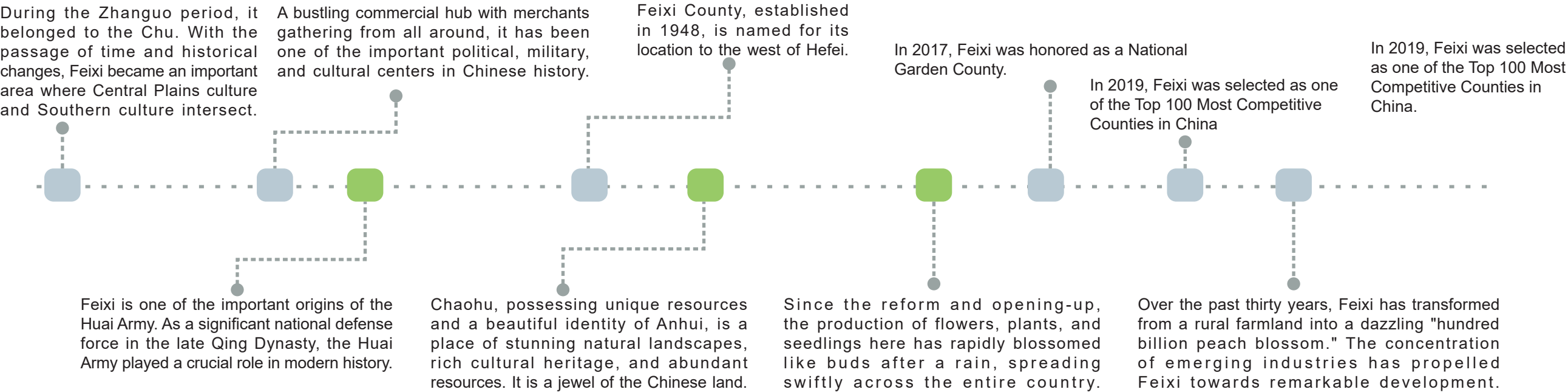

FROM THE MOST FREQUENTLY MENTIONED INTENTIONS REGARDING FEIXI CITY EXPRESSED BY USERS, THE PROJECT HAS ORGANIZED AND EXTRACTED SPECIFIC CULTURAL CONTENT AND POTENTIAL UTILIZATION INTENTIONS.

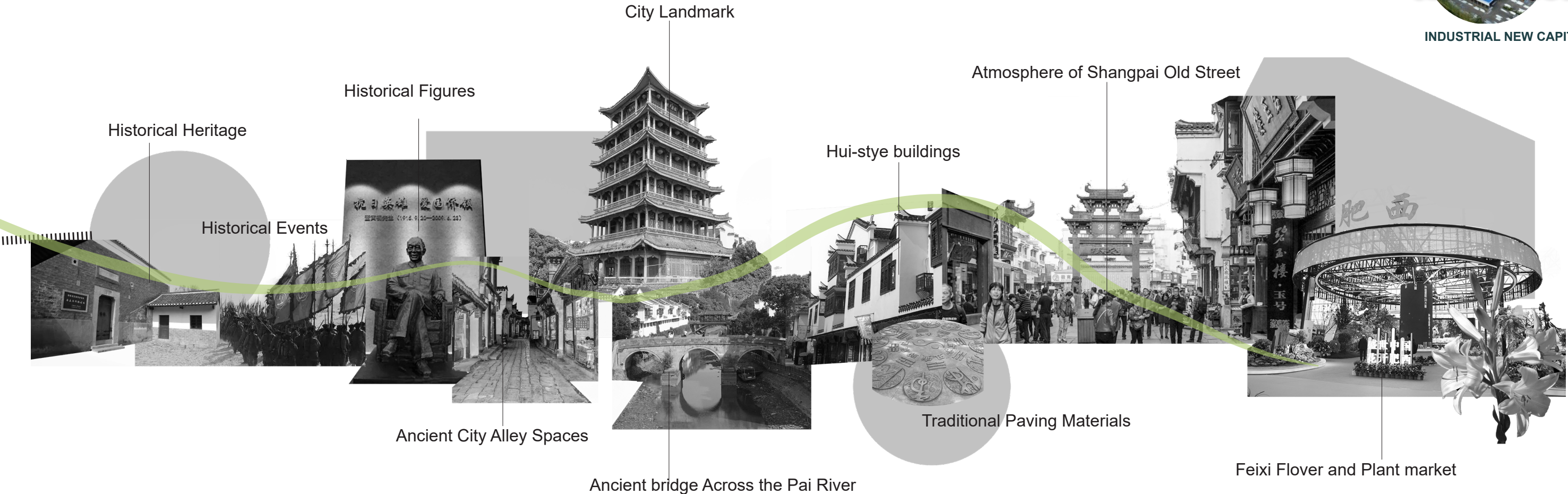

HOMETOWN OF THE HUAI ARMY



PEARL OF CHAOHU



THE LAND OF FLOWERS AND TREES



INDUSTRIAL NEW CAPITAL

CULTURAL NARRATIVE

CITY MEMORY CORRIDOR & FEIXI NEW PORTAL

SITE BASIS+USER ANALYSIS+CULTURE NARRATIVE

——THEME FEATURES AND RENOVATION TECHNIQUES

"TIME IN FEIXI" serves as a comprehensive exploration of the rich local culture of Feixi.

This initiative delves into three major themes: the Gazetteer of Local Products, the Gazetteer of Geography, and the Gazetteer of People
Embedding the city's memory and creating a cultural corridor that harmonizes with Feixi.



Osmanthus Tree



Ginkgo



Centennial Magnolia



History of the Huai Army



1998 Shangpai Old Middle Street

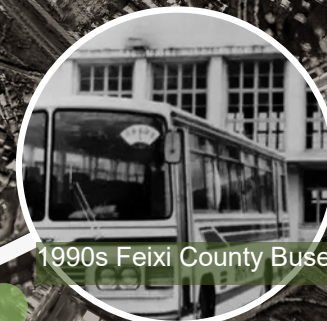

1990s Feixi County Buses

JINZHAI ROAD

TEME 1

TIME IN FEIXI
Geography
Chronicle
theme

TEME 2

TIME IN FEIXI
Biography
theme

TIME IN FEIXI
Objects
Chronicle
theme

TEME 3



Representative works of Liu Mingchuan: "Poems of Da Qianshan House" and "Memorials of Liu Zhuangsu Gong".



Liu Mingchuan's notable works include "Da Qianshan Fang Shi Chao" (Poetry Collection of the Great Qianshan Studio) and "Liu Zhuangsu Gong Zouyi" (Memorials of Lord Liu Zhuangsu).

At the former residence of Liu Mingchuan, there is an intertwined magnolia tree. In Panlongdun Hao, a well-preserved osmanthus tree, with an age of about 160-170 years. Additionally, in Zhou Lao Hao, there is a ginkgo tree that is approximately 150 years old.

CULTURAL RENEWAL STRATEGY

CULTURE+SPACE



Site Spatial Form

Extract cultural elements and apply them to the spatial layout and facade design.

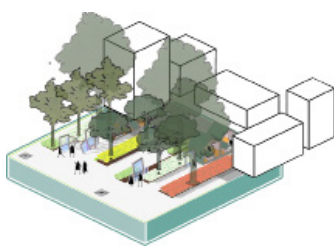

Application of Indigenous Plant Features

Select local tree species that are suitable for the environment and plants with local characteristics and cultural significance for greening design, enriching the levels, colors, and seasonal changes of greening.

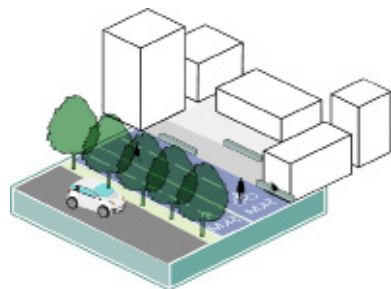

Unified Color Elements

Choose representative color schemes with local characteristics, and unify the color elements in each landscape element for coordination and application.

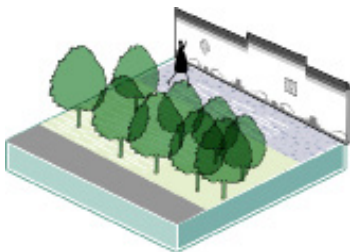

Application of Cultural Elements

Extract local regional cultural elements, such as paving materials, architectural forms, calligraphy, paintings, etc., and apply them to various landscape components to enhance the cultural visual image.

CULTURE+FUNCTION

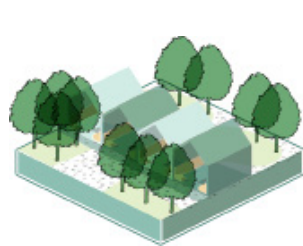

Urban Furniture

Integrate cultural facilities with urban service functions, such as seating, pergolas, etc., to enhance the practicality of cultural applications.

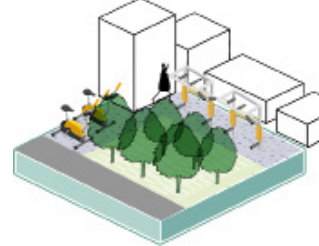

Municipal Facilities

Integrate cultural elements with municipal facilities to incorporate cultural elements into the daily lives of citizens.

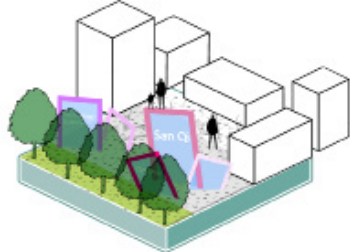

Promotion of Cultural Image

Combine cultural content and elements with urban cultural promotional facilities to establish the city's cultural image and enrich its cultural heritage and connotations.

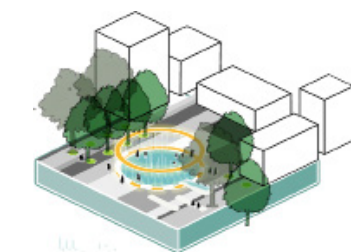

Landscape Installations

Combine cultural elements and content with artistic installations to increase the visual impact and experiential aspects of culture, enhancing the enjoyment of cultural perception.

the project selects and extracts cultural elements from the highest-mentioned regional intentions in the survey, integrating these elements into the space in terms of form, elements, colors, and plants. These elements are combined with space functions through urban furniture, image exhibitions, municipal facilities, and art installations. Interactive experiences are created through cultural education, interactive facilities, and themed activities, resulting in comprehensive cultural image integration. This enhances the recognizability of the cultural image of the space and increases the interest and engagement of cultural experiences within the site.

CULTURE+SECENRY&EXPERIENCE



Cultural Scene Atmosphere Creation

Recreate local cultural legends and historical stories through scene reenactments, event experiences, etc., to form immersive cultural landscape scenes.

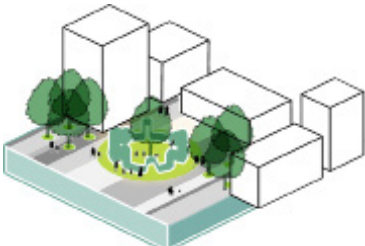

Multidisciplinary Art Fusion

By using landscape art design techniques to integrate cultural elements from various themes, we create a cultural experience full of creativity and trendiness, injecting freshness into the landscape space.



Flexible Site Functionality

Set up flexible spaces that can adjust functions and usage scenarios according to different time periods and the needs of different users, thus enhancing site utilization efficiency.



Cultural Interactive Facilities

Innovatively apply cultural elements, combine them with modern technology, and create interactive cultural facilities to enhance the experiential and entertaining aspects of cultural facilities. This will attract people of all ages to participate, promoting the inheritance of local culture.



Cultural Theme Activities

Set up various types of themed activities based on different regional cultural contents to attract citizen participation, establishing regional cultural Intellectual Property and enhancing site vitality.

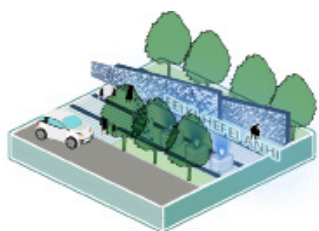

Cultural Educational Exhibition

Innovate the form and content of cultural exhibitions, enriching the themes to make urban cultural promotion no longer monotonous and boring.

PLANTING PLAN

Feixi is renowned for its reputation as the "hometown of flowers and trees." Through literature research and citizen surveys, the project has carefully selected native tree species that thrive in Feixi and the most representative plants of the local region for the plant space design. This creates a diverse and rich plant hierarchy, showcasing the distinctive botanical features of Feixi.

Specific plant species can be found in the table on the right.



Osmanthus fragrans



Acer negundo L.



Punica granatum L.



Lagerstroemia speciosa (L.) Pers.

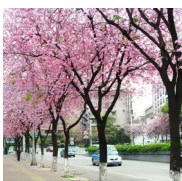

Cercis chinensis Bunge



Prunus persica



Mahonia fortunei (Lindl.) Fedde

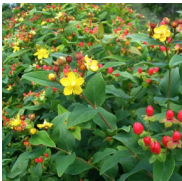

Hypericum monogynum L.



Euryops pectinatus (L.) Cass.



Salvia japonica Thunb.

SITE PLAN AND NODES - PHRASE 2

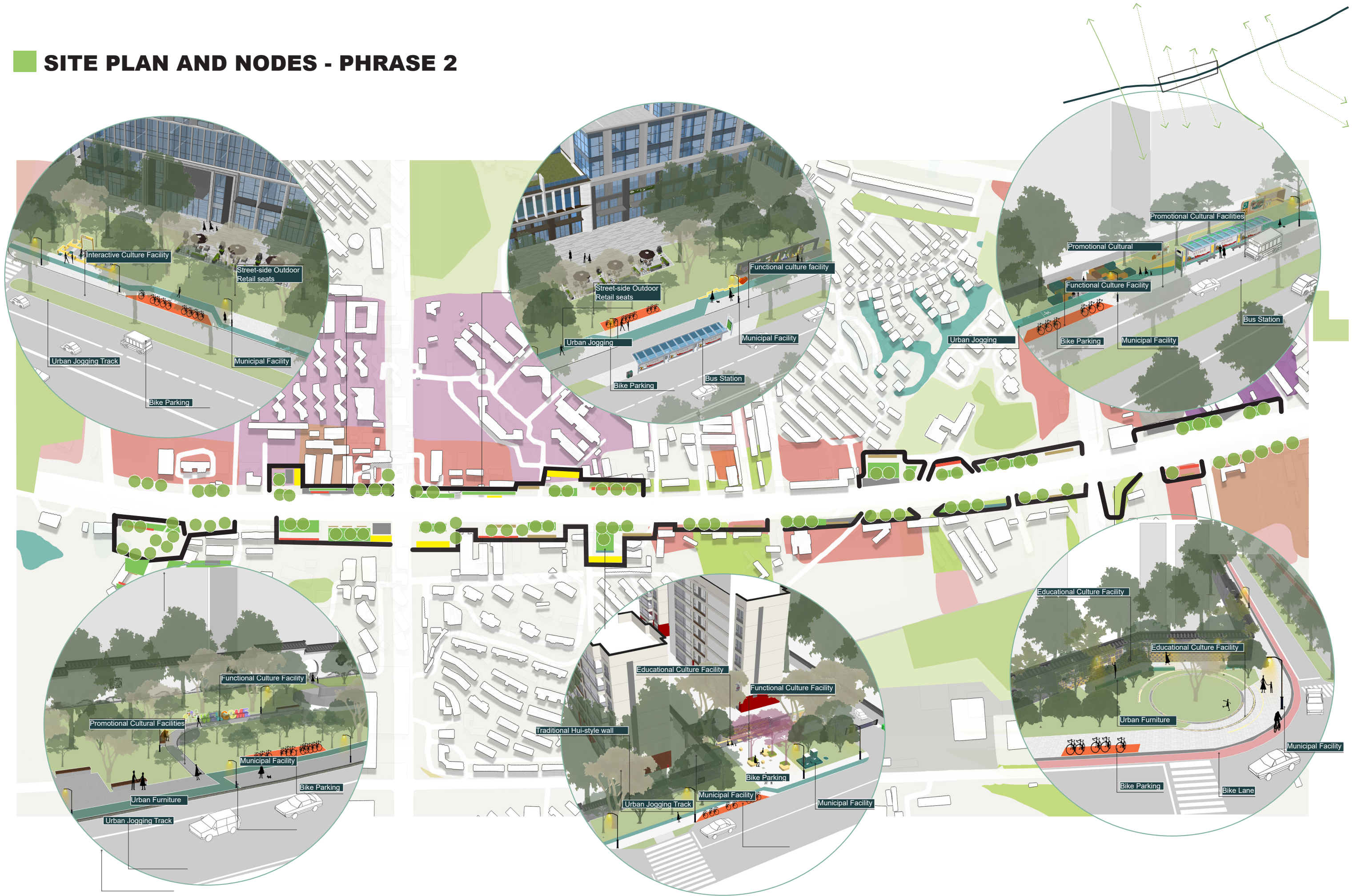

LAYOUT ANALYSIS

Based on the survey results, the project comprehensively consider the renovation content and extent for each section of the street space.

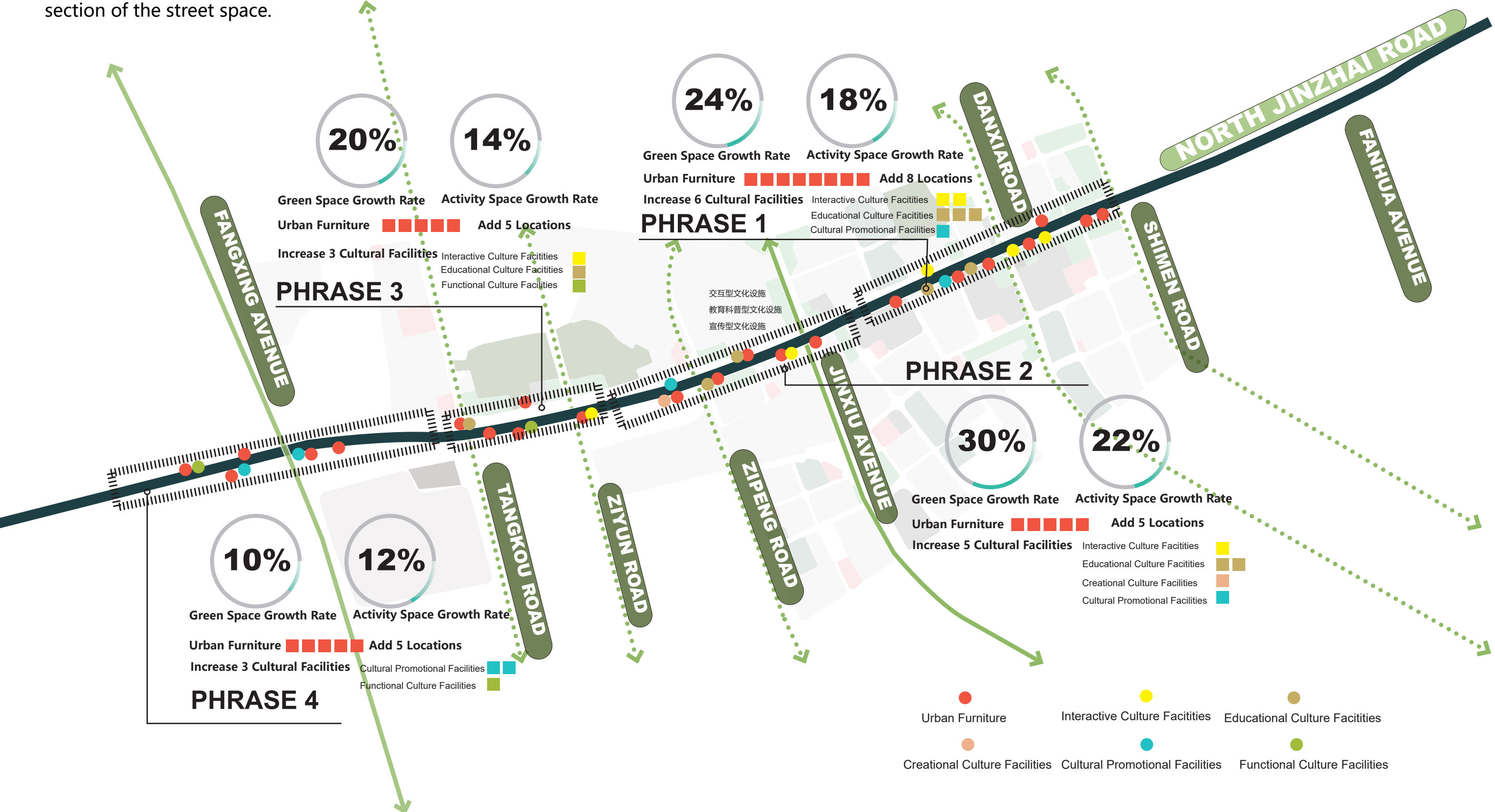

RENDERINGS



Artfully render city landmarks to create a silhouette that represents the city's image. Apply this silhouette in the construction of cultural image displays at city street intersections, while using Feixi's characteristic perennial flowers to create a flower wall backdrop for these cultural image displays.



Artfully render the letters of "Feixi" to form an alphabet wall with urban furniture functions. This wall will showcase Feixi's cultural and artistic image while providing a place for citizens to rest and gather along the street. Additionally, the citizens' interactive wall will allow for cross-temporal communication and interaction, enhancing the appeal and functionality of the urban furniture.



Make full use of the existing walls, combining the characteristics of Huizhou-style walls in Feixi with the images and stories of historical figures to create a Feixi character cultural wall with educational functions.