



GUANGDONG MAOMING YUNXI POCKET PARK

LOCATED IN THE PROSPEROUS CITY CENTER OF MAONAN, WHERE SCHOLARS GATHER

IFLA-APPME AWARD 2024

Award Categories -Economic Viability

LANDSCAPEPROJECT BINDER FOR

Project Name: Guangdong Maoming Yunxi Pocket Park

PROJECT NAME: Guangdong Maoming Yunxi Pocket Park

PROJECT ADDRESS: No. 1 of Dongyue North Road, Maonan District, Maoming City

CITY & COUNTRY: Maoming, Guangdong, China

AREA(SQM): 13333 square meters

YEAR OF COMPLETION: October, 2023

PROJECT CATEGORY: Economic Viability

PROJECT STATEMENT

The narrow and irregular space, with only 81m wide and 227m long, organically integrates communities, green spaces, and schools not only physically but intellectually. The message is that urban nature can also be a "community living room". The open front waiting space provides enough space for parents to pick up and drop off their children. It is wrapped in this park and provided with safety and convenience. It's a great example of a center for environmental experience that realizes the use of the openness of urban street corners. Transforming the inherent services of the community into urban services. The landscape architect tailored the level of detail to the scale of the children. It gives the nearby residents a direct reason to become participants in the space, activate the vitality of the block, endow the site with vitality, and make the park temperature and the beautiful touch of life accessible. The implementation of the project has been recognized by the city, community residents, and students, and has successfully become a community engine and detonated regional popularity.

PROJECT NARRATIVE

This project is located in Maoming City, Guangdong Province, China. It is the connection link between cities and towns on the suburban boundary. An L-shaped street corner space is formed based on the intersection of Dongyue Road and Planning Road. Existing parks are concentrated in urban areas, and the distribution of parks on the east and west sides is uneven.

The site is a free open park developed and built by a real estate company to provide the local community. With the improvement of urban quality and the construction of beautiful communities as the core construction goals. Both the southwest and east side are densely distributed with urban residential buildings and farmland and wasteland, and the north side is occupied by built houses and primary schools. The park is the core gathering place within the region. The urban roads have been established in a system, evenly distributed in a grid shape, and the transportation is convenient. Although it is surrounded by dense residential areas, it lacks green space for public activities for citizens to participate. Citizens can only spontaneously complete fitness and entertainment activities in a single, chaotic temporary venue.

Returning to the needs of urban residents can be of greater value of pocket parks . Therefore, we clearly found the opportunities, needs and problems of the project from several directions such as urban development vision and lack of regional functions. Then we clarified our goals: a community neighborhood garden that is happy for all ages, a life theater with neighborhood temperature, and a growth garden with a memory point of growth. This park can meet the city's quality development positioning; the all-age activity community can meet residents' needs for public activities, and the vibrant shared green space can drive the improvement of regional quality through the gathering of people.

Throughout the design process, based on our understanding of the site, we completed the site construction through five strategies.

STEP1: Guided by the goal of "a garden at the doorstep, a classroom outside the campus", it will become a strong link between the community and the school, directly connect the school entrance and exit, connect the communities with roads, and then increase the value of the land;

STEP 2: the introduction of multi-directional circulation lines, the crowd is invisibly attracted through the participatory space in the venue, and enters the venue from the outside, which strengthens the sense of stay and gathering.

STEP 3: Combined with the site positioning and comprehensive attributes, the site is upgraded from an ordinary leisure park to a multi-functional public community park for all ages.

STEP 4: The house park is not a simple pocket park, but a multi-meaning ecological park that carries the construction of sponge city. It uses land art topography to form a green island space, and the site functions are combined with the green island to form a natural landscape system.

STEP 5: Based on the design principle of seeing the world from a height of one meter, create a vertically changing, interesting and dynamic amusement scene.

The entire design process rationally plans the functional space of the site based on the site attributes and surrounding people, so that the space forms a comfortable scale and the circulation space on the circulation line and the activity space are organically combined. In this way, the crowd can be introduced into the site through an attractive participation space and integrated into the site. In terms of the function of the site, from the urban interface to the public entrance, functional activities for all ages are interspersed and arranged, organized and finally expressed using customized design language.

In the process of focusing on the site design, the urban entrance plaza utilizes open and guiding streamlined pavement. For the front court space, we use a more natural and tense approach to fall into a land art terrain, breaking the conventional park form and exposed features, and enhancing the overall sense of quality. Similarly, as a three-point and one-line process from the community to the park and then to the school, the children's play area in the park becomes a key link between the past and the next.

The rich spatial experience turns this place into a public park, which strongly activates the site. Participation lights up the urban space. Located on the north side of the site and connected to the school entrance square, the open front waiting space provides more safety and convenience for parents to pick up and drop off their children. It is wrapped in a park green space and provides more safety and convenience.

01 SITE LOCATION ANALYSIS

Maoming Yunxi Pocket Park, A Happy School Road That Creates Growing Memories Provides A Venue For Parent Child Activities, Providing Users With A Novel, Interesting, Safe And Worry-Free Activity Space.

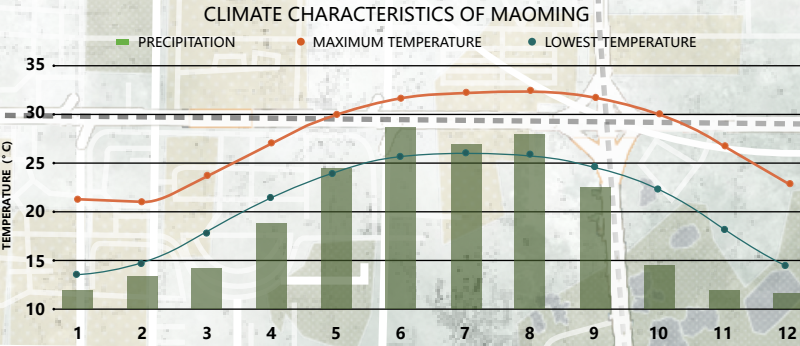
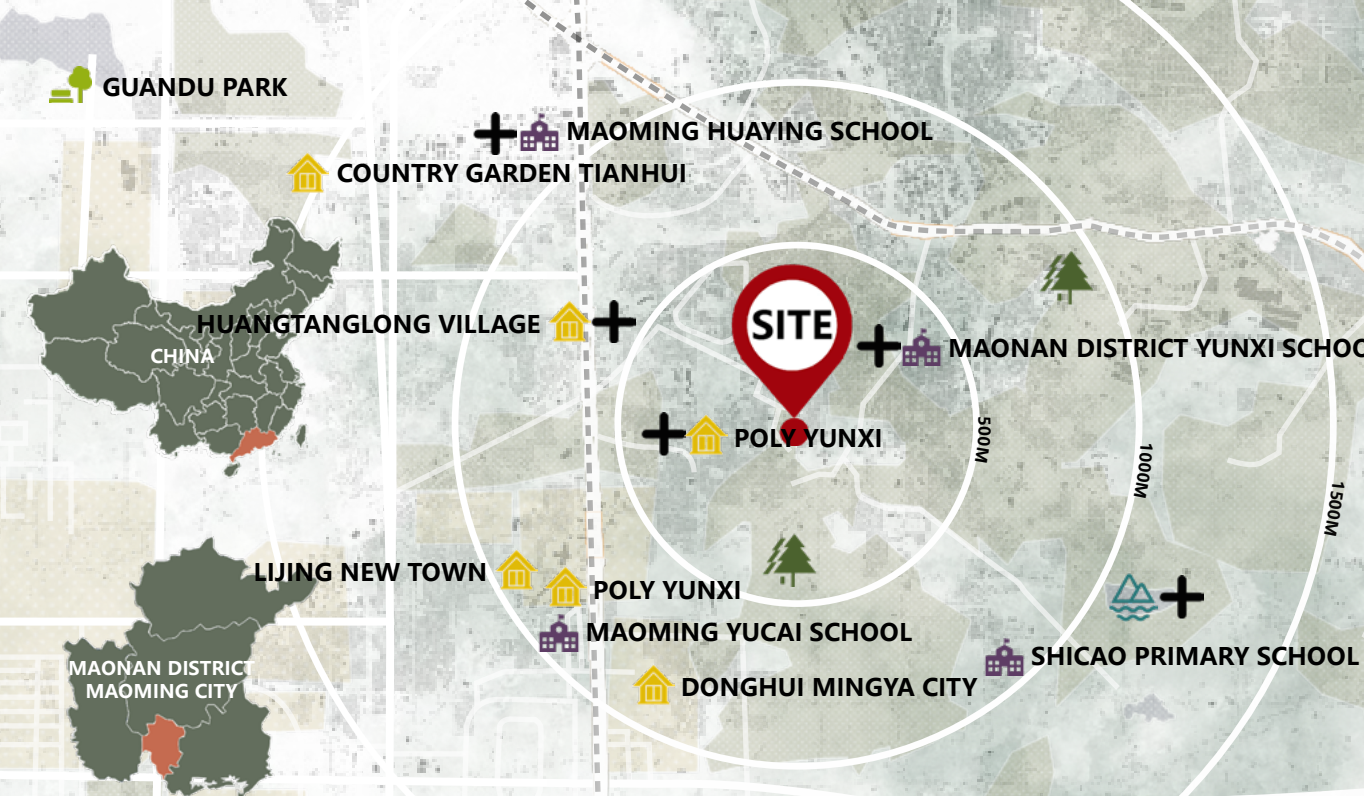

THE PROJECT SITE IS LOCATED IN MAONAN DISTRICT, MAOMING CITY, CLOSE TO SCHOOLS AND RESIDENTIAL AREAS.



04.SITE CLIMATE ANALYSIS

Maoming city is located south of the tropic of cancer and belongs to the subtropical monsoon climate zone. Northerly winds prevail in winter and southeasterly winds prevail in summer.



03.TRAFFIC ANALYSIS

The base is located in the core area of the eastern city, with convenient transportation, outstanding educational resources around the project, and mature supporting resources in the area.



02.SURROUNDING LAND PROPERTIES

It is surrounded by several residential sites in the southwest, densely populated urban residential houses and farmland in the east, and a completed primary school in the north.



01.LOCATION OF THE VENUE

This project is located in Maoming City, Guangdong Province, China. The site has a tendency to expand eastward and southward, and is located at the link between the city and the town.

02 PLAN AND ANNOTATION

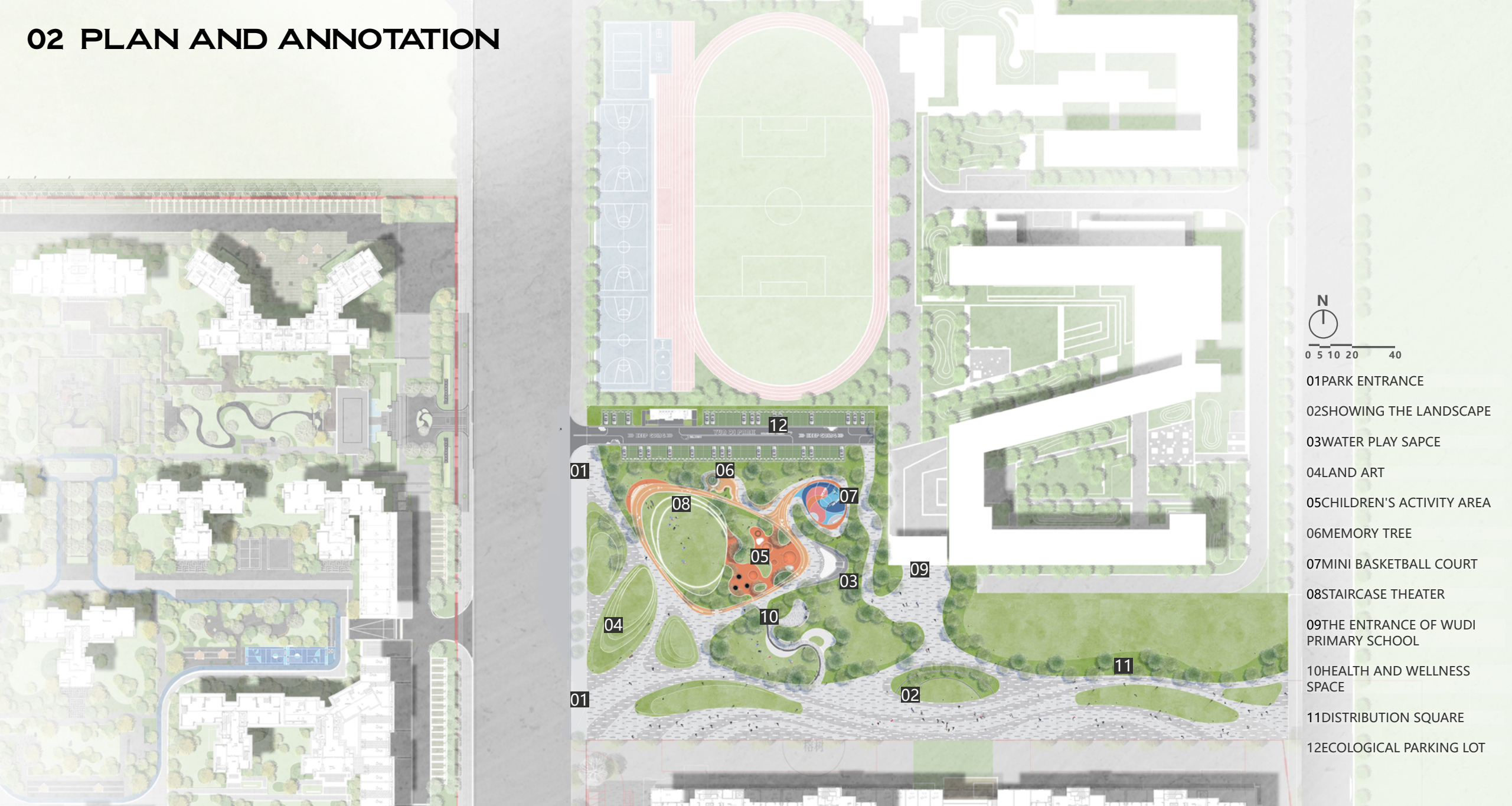

- 01PARK ENTRANCE
- 02SHOWING THE LANDSCAPE
- 03WATER PLAY SAPCE
- 04LAND ART
- 05CHILDREN'S ACTIVITY AREA
- 06MEMORY TREE
- 07MINI BASKETBALL COURT
- 08STAIRCASE THEATER
- 09THE ENTRANCE OF WUDI PRIMARY SCHOOL
- 10HEALTH AND WELLNESS SPACE
- 11DISTRIBUTION SQUARE
- 12ECOLOGICAL PARKING LOT

THE PARK CAN PROVIDE A GROWING GARDEN WITH VITALITY AND A COMMUNITY NEIGHBORHOOD GARDEN FOR ALL AGES TO ENJOY.

03 PROJECT BACKGRONUD

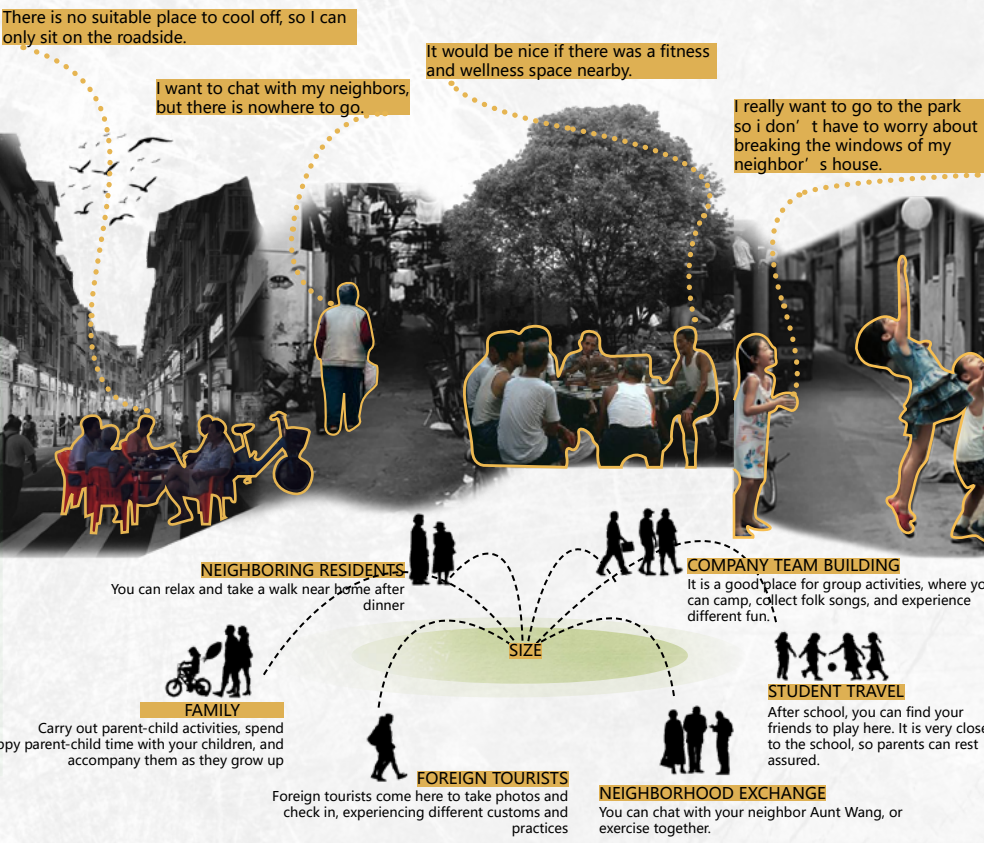
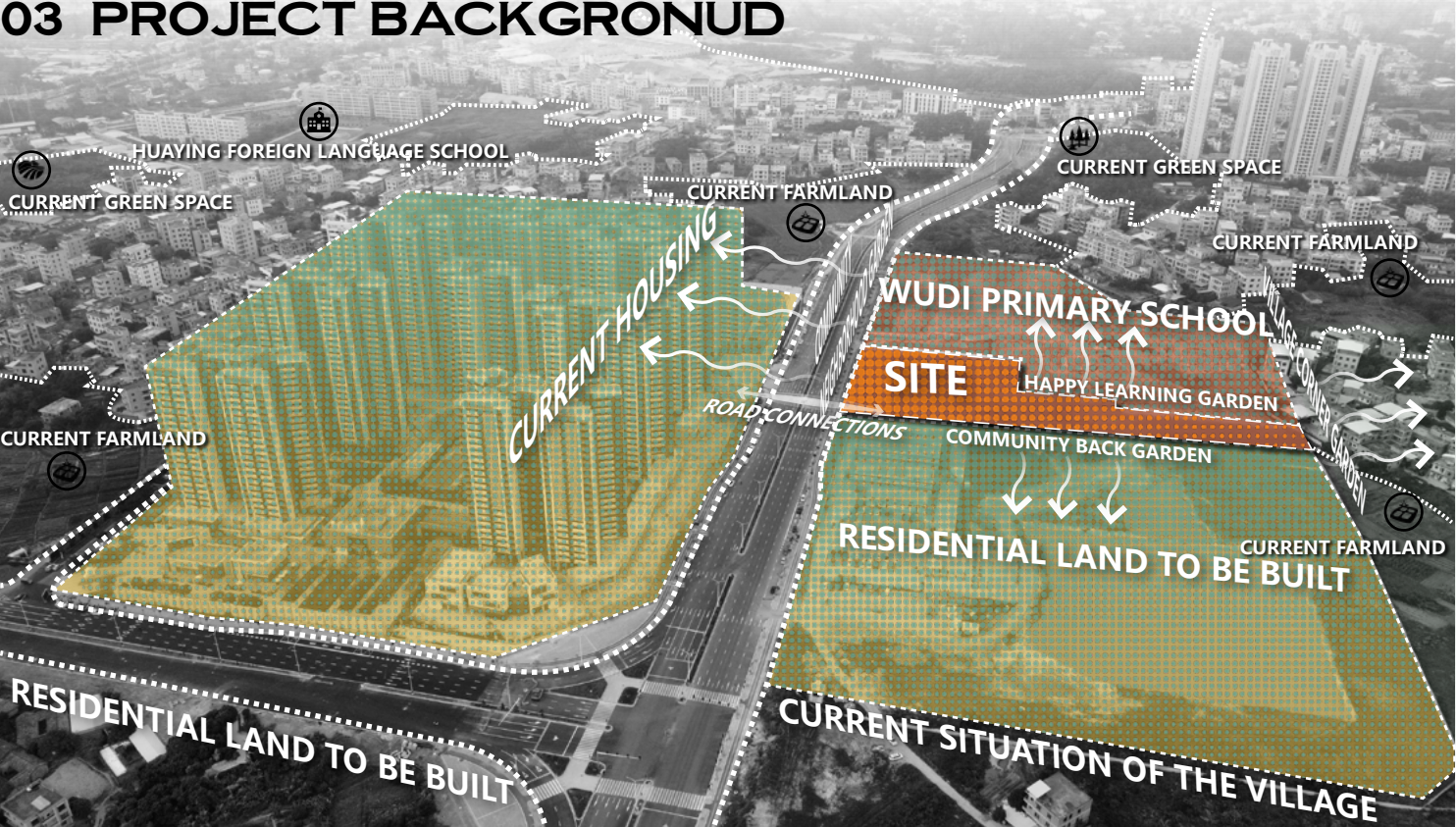

MAOMING ACADEMY

During the ming and qing dynasties, a large number of academies were built in maoming, and many of the traditional academies have been preserved to this day.



LION ON HIGH FEET

The high-legged lion dance, also known as the tall lion dance, is said to have originated in the late Ming and early Qing dynasties and is a traditional folk dance in Guangdong Province.

LADY XIAN'S BELIEFS AND CUSTOMS

The belief in Lady Xian is a folk worship, mainly through temple fairs and sacrificial activities held in the Xian Tai Temple in various places. Lady Xian is an indispensable deity in the traditional "annual" parade.

MAOMING DEPARTMENT STORE

Maoming Department Store was built in 1958 and is one of the landmark buildings in the early days of Maoming City.



CANTONESE OPERA

Maoming is also influenced by Cantonese culture, and Cantonese opera and song culture are also popular.



GAOZHOU PUPPET SHOW

Gaozhou puppet show, also known as "puppet show" or "puppet show", is a rod puppet that originated during the Wanli period of the Ming Dynasty and was developed on the basis of Fujian glove puppets.



THIS CITY EXUDES A LONG HISTORICAL HERITAGE AND A STRONG URBAN IMPRESSION, AND THE STREETS ARE FILLED WITH THE BUSTLING ATMOSPHERE OF HUMAN LIFE.

04 COMPREHENSIVE SITE ANALYSIS

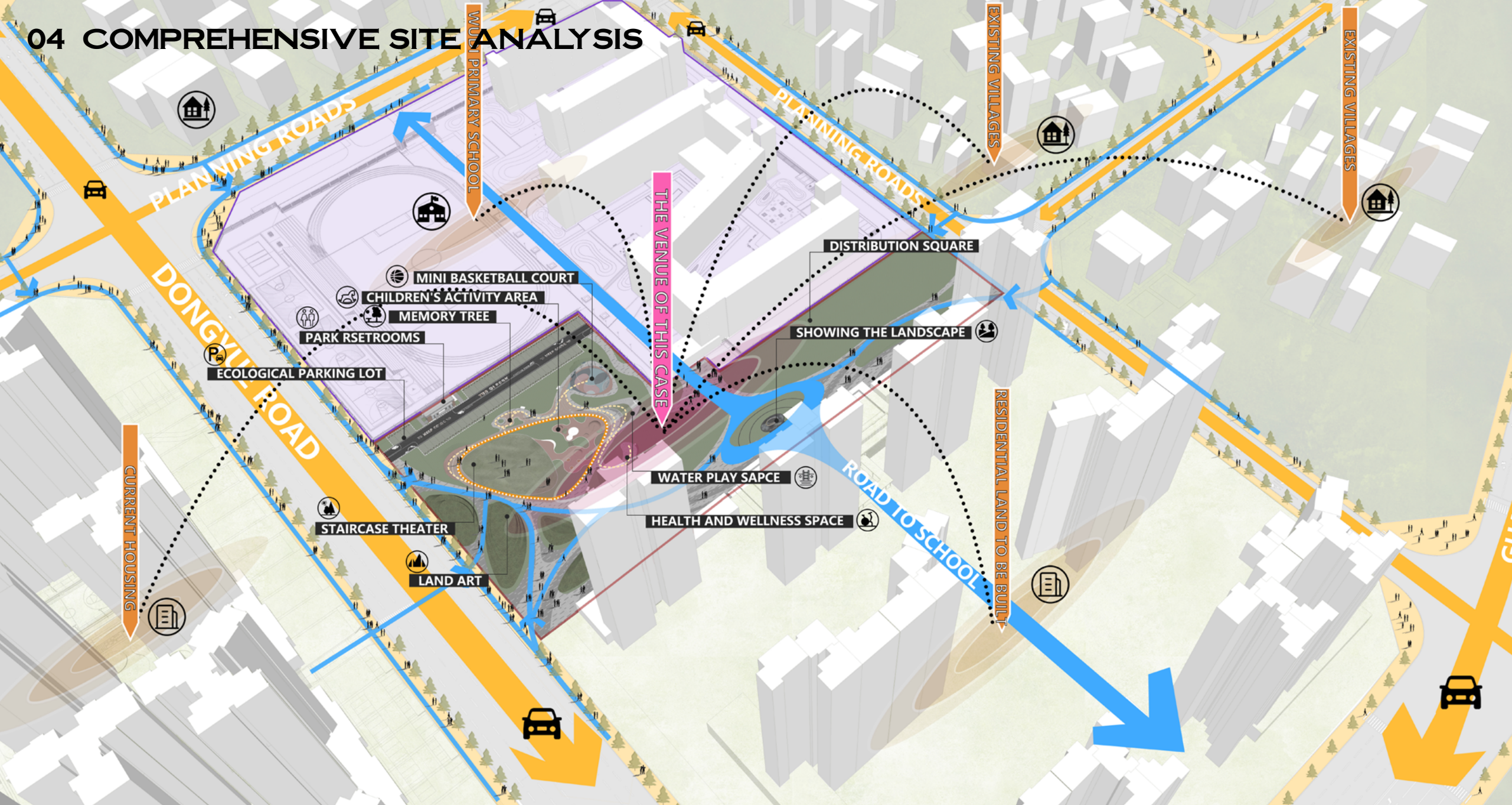

THE PARK IS GUIDED BY THE GOAL OF "A GARDEN AT THE DOORSTEP, A CLASSROOM OUTSIDE THE CAMPUS", BECOMING A STRONG LINK BETWEEN THE COMMUNITY AND THE SCHOOL.

05 DESIGN AND EXPRESS

- THE PARK ADOPTS A MULTI-DIMENSIONAL THREE-DIMENSIONAL DESIGN, USING THE TOPOGRAPHICAL FEATURES OF LAND ART TO ENRICH THE VERTICAL RELATIONSHIP OF THE ENTIRE SITE.
- BY INCORPORATING SPONGE CITY TREATMENT TECHNIQUES, A RICH BOTANICAL GARDEN AND NATURAL ECOLOGICAL ENVIRONMENT HAVE BEEN CREATED.

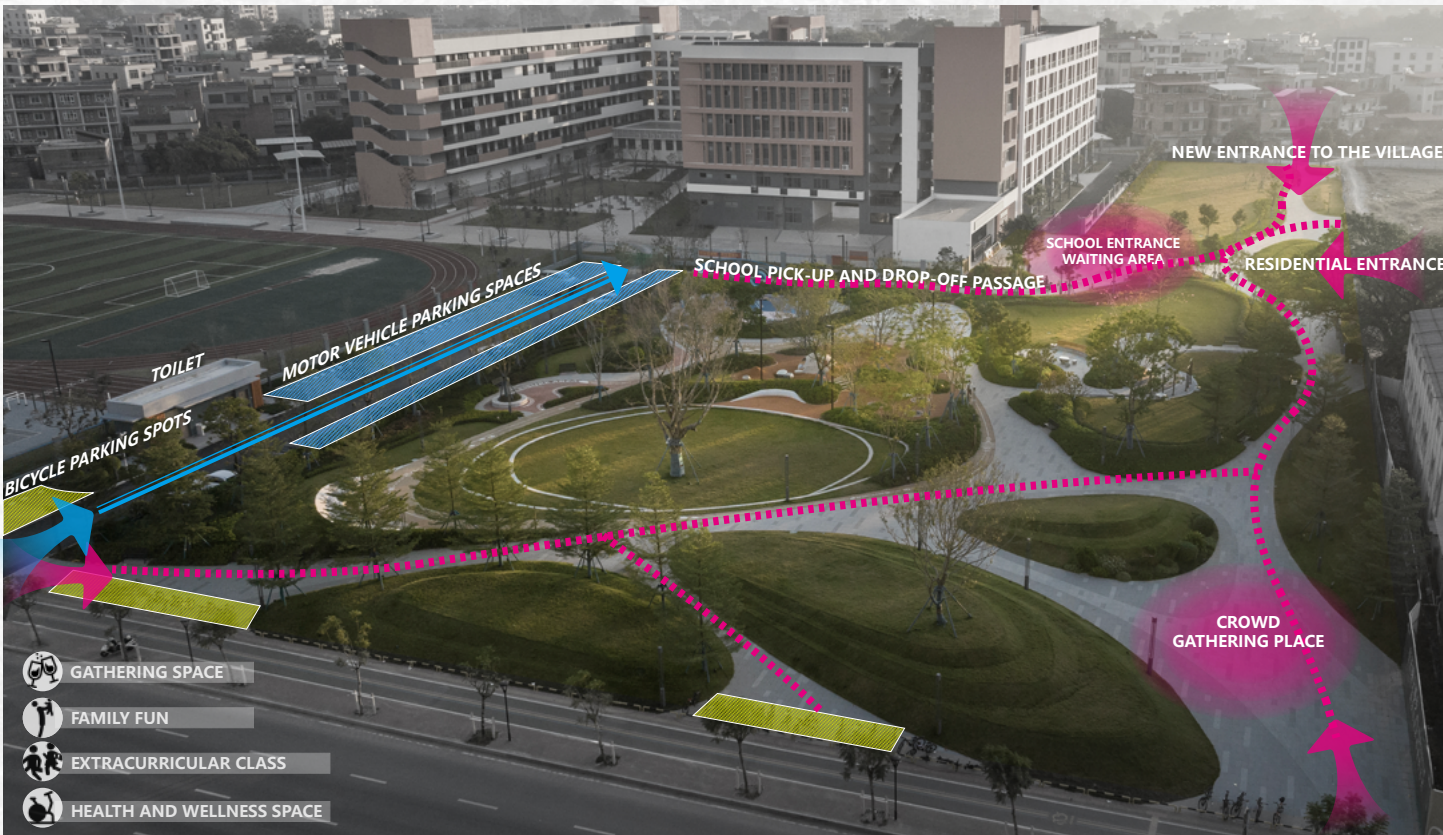
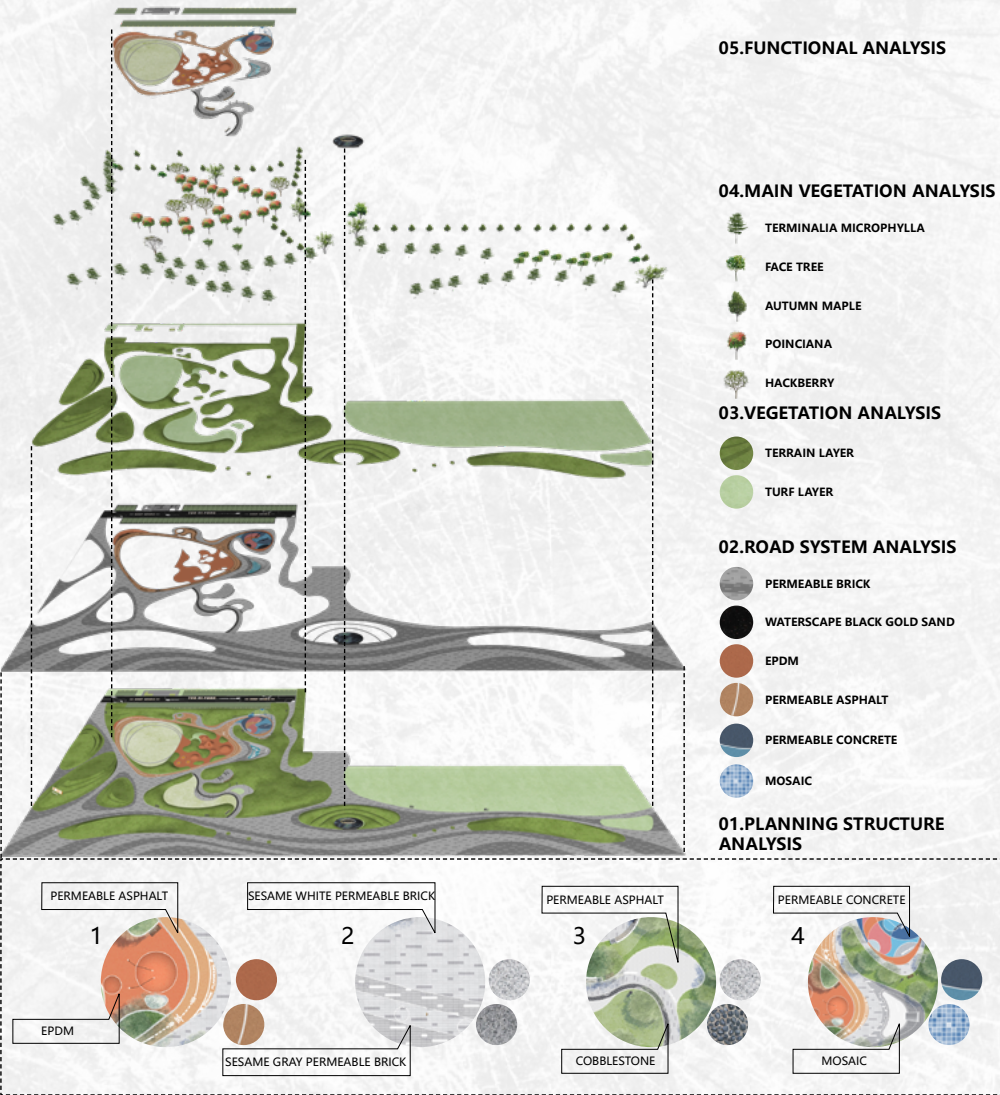

THE SITE CONSTRUCTION FOCUSES ON PROPOSING CORRESPONDING DESIGN STRATEGIES FOR HAPPY SCHOOL ROUTES, CHILD-FRIENDLY PARKS AND COMMUNITY NEIGHBORHOOD CENTERS.

06 SITE SPONGE CITY ANALYSIS

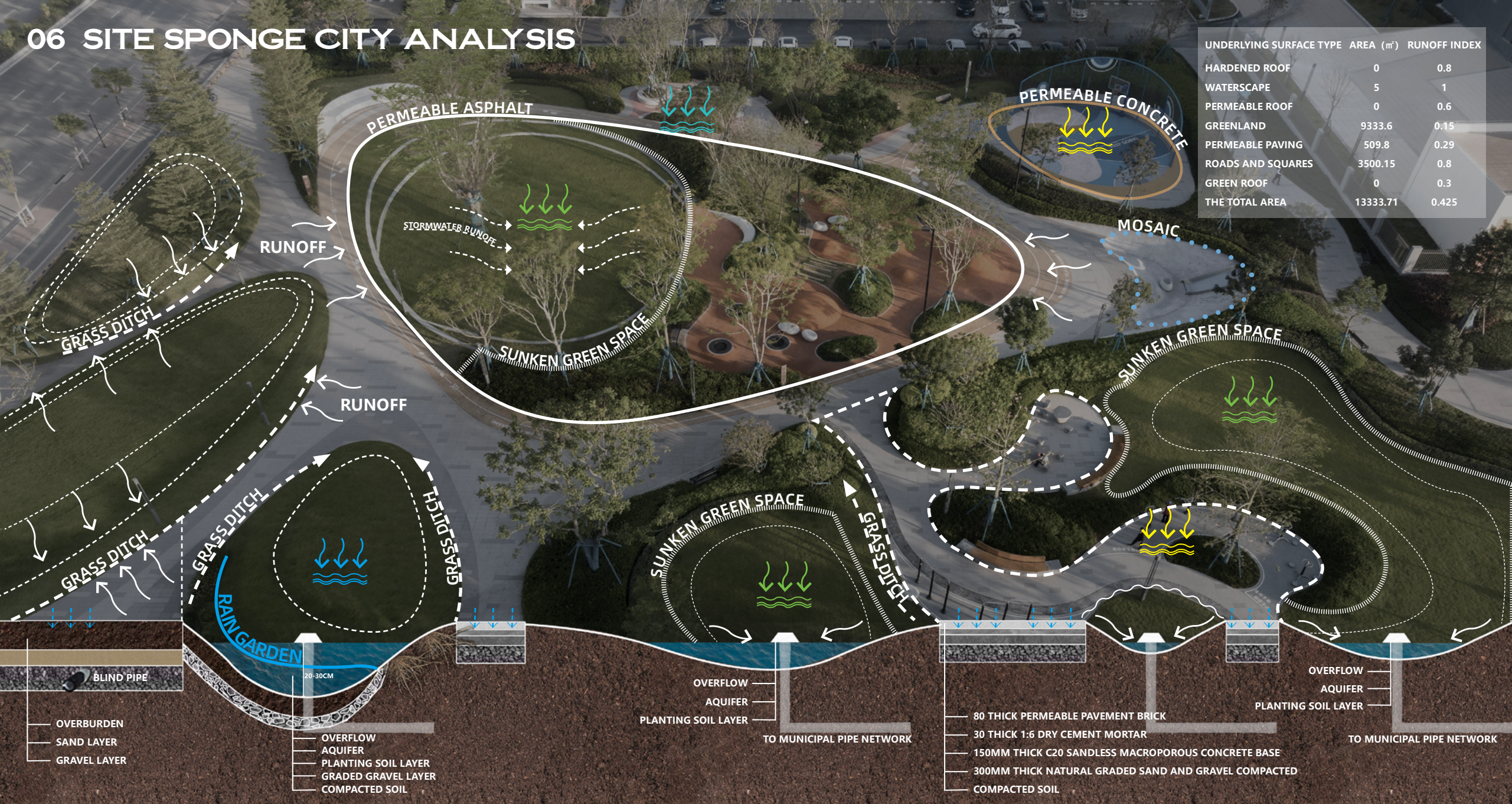

PARK SPONGE CITY STRATEGY: TRANSFORMING CITIES INTO SUSTAINABLE ECOLOGICAL ENVIRONMENTS AND IMPROVING URBAN ECOSYSTEMS THROUGH GREENING AND WATER RESOURCE MANAGEMENT.

07 CHILDREN S ACTIVITY VENUE DISPLAY



NON-MECHANICAL CHILD-FRIENDLY PLAYGROUNDS ARE SAFE, CREATIVE AND INTERACTIVE PLACES DESIGNED SPECIFICALLY FOR CHILDREN, OFFERING A RICH VARIETY OF GAMES AND ACTIVITIES.

08 CORE ACTIVITY VENUE DISPLAY



BY INCORPORATING CHILD-FRIENDLY PLAYGROUNDS AND AGE-FRIENDLY REQUIREMENTS INTO PARK DESIGN AND PLANNING, A MULTI-GENERATIONAL SPACE CAN BE CREATED.

09 DETAIL MAGNIFICATION



THE RUNNING TRACK REST AND REFUELING STATION PROVIDES RUNNERS WITH A FULL RANGE OF SUPPORT AND CONVENIENCE.

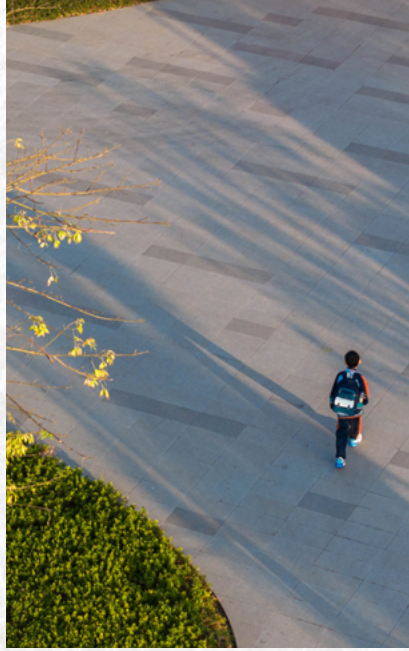

A HAPPY ROAD HOME FROM SCHOOL COVERED WITH SUNSHINE.



THE CLIMBING AREA AND SLIDES ARE DESIGNED TO BE SAFE WITHOUT SHARP CORNERS.



ROLLING AROUND ON THE GRASS WITH YOUR FRIENDS, FEELING THE PURE AND UNRESTRAINED HAPPINESS.



IMPLEMENTING A HEALTH AND WELLNESS SPACE SUITABLE FOR THE ELDERLY.



THE PARK ON THE HAPPY WAY TO SCHOOL PROVIDES A FUN PLACE FOR STUDENTS TO SPEND TIME AFTER SCHOOL. THE PARK HAS SPORTS FIELDS, PLAY EQUIPMENT AND OUTDOOR LEARNING AREAS.

10 ELDERLY HEALTH SPACE



THE ELDERLY RECREATIONAL ACTIVITY SPACE IS A PLACE DESIGNED SPECIFICALLY FOR THE RECREATIONAL NEEDS OF THE SURROUNDING ELDERLY.