



ISO 9001:2015 CERTIFIED

GEE ESS ENGINEERING WORKS

FOR TOP PERFORMANCE ALWAYS USE “GEC”
INDUSTRIAL CHAINS AND CONVEYORS, BUCKET
ELEVATORS, DRAG CONVEYORS, SLATS & RAKE
CONVEYORS.

Palm Oil Industry Chains

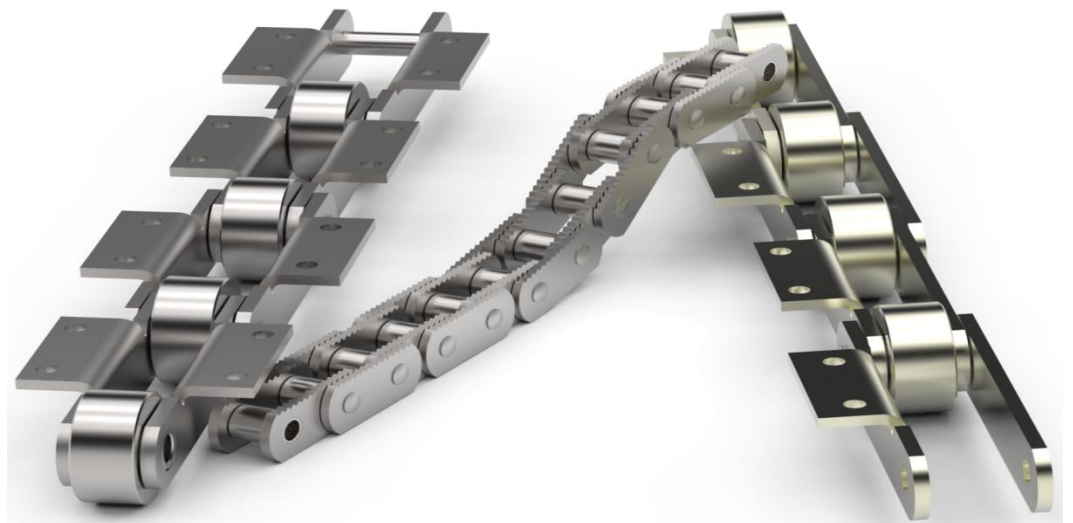



ISO 9001:2015 CERTIFIED

Gee Ess Engineering Works

About Us

- GEE ESS's Malleable, All steel fabricated and forged conveying or elevating is required, All over the Indian subcontinent and to the different parts of the world these are regularly supplied to the plants and to the original equipment manufacturers and as spares for various kind of machines and material handling, along with the corresponding and other attachments.
- We are manufacturing a wide range of chains, From 2.5" pitch to 12" pitch & chains (long pitch & heavy duty) for special applications. Our chains are well known for their strength ruggedness and durability .We have achieved many distinctions in manufacturing and improving the quality of chains to achieve longer working life.
- GEE ESS's has followed a tradition of identifying with the Technologist and Engineer, his needs, wants & upholding the cause, trying to find a solution to his each problem and applying the experience gained on the future supplies & various types of chain being manufactured under the progressive design and development along with the user engineers, Manufacturing of all the chains is done in a technologically sound environment following the most productive techniques involving the precise metallurgical stages of controlled production making the chains to work successfully under the most strenuous conditions.
- We have the most modern machinery Imbibing the latest technology. All Side links are manufactured under the Compound dies achieving the accurate pitch. Intensive care is taken for the workmanship of the pins, bushes, and rollers. Heat treatment is applied to achieve the required shear stresses, impact and wear resistance.





ISO 9001:2015 CERTIFIED

Gee Ess Engineering Works

Vision

We are proud to say that we being a part in

“Collaborative Growth of Our Nation for more than four decades” our journey towards collaborative success has & we have a long way to go. We see GEE ESS as one of the distinguished and greatest company representing India , globally. We are setting example of core engineering, fine technology, and modern mechanism and global recognitions.

Mission

WE WOULD LIKE TO SERVE OUR CLIENTELE WITH QUALITY
CONVEYOR CHAINS & SPROCKETS & OTHER MACHINERY
SPARES AT A VERY COMPETITIVE PRICE AND FASTEST DELIVERY.

“ Client satisfaction, service of commitment to quality is our utmost priority”.

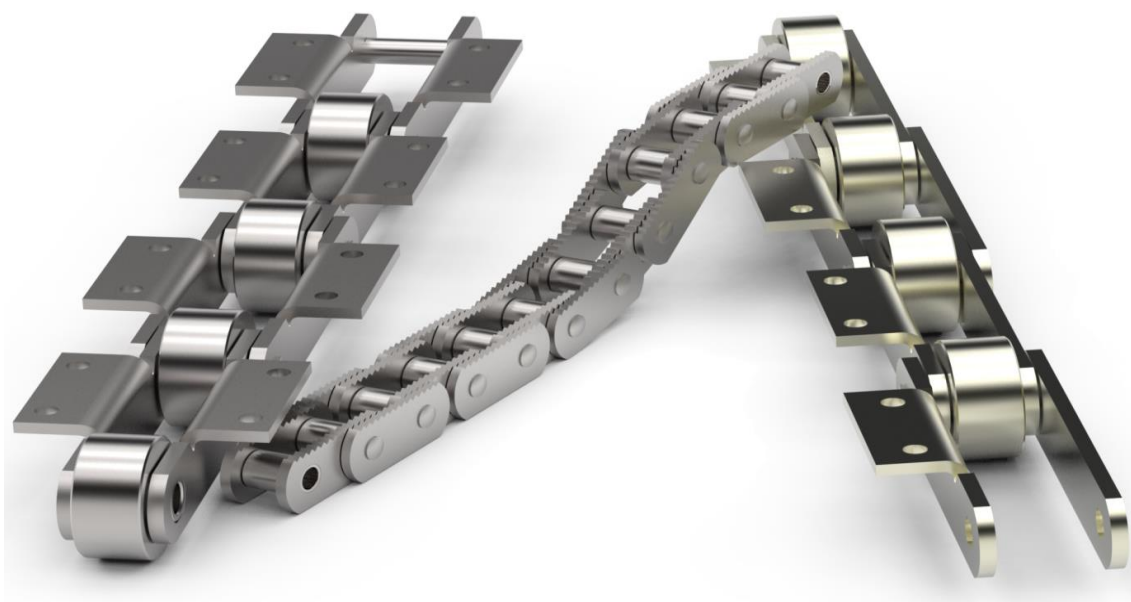



ISO 9001:2015 CERTIFIED

Gee Ess Engineering Works

MANUFACTURING FACILITIES



We have the most modern power presses imbibing the latest technology. The presses are operated by well trained persons to achieve the absolute perfection. Side links of all type of Chains are punched with compound dies to achieve the accurate pitch. After heat treatment the side links are tested for alignment crack detecting, hardness testing etc. by the experienced technicians and then passed on the assembly section.

Similarly, proper heat treatments are given to the pin, Bushes and Rollers according to the material used for each and after proper testing the material are sent to the assembly section for the assembly of chain.

GEE ESS employs several heat treating processes to improve the material characteristics. The heat treating process used in each application is determined by IS standards & as per requirements of materials specified.

“The more perfect the Alignment Greater is the Increase in life of chain”.





ISO 9001:2015 CERTIFIED

Gee Ess Engineering Works

Range Of Palm Oil Chains

GEE ESS's palm oil mill chains are designed & Manufactured to meet the needs of our customers providing a suitable choice. Chain parts manufactured precisely, subject to heat treatment and selected materials to suit the individual operating conditions to run their continuous production.

Range	Sidebars	Pin	Bush	Roller
HEAVY DUTY	Alloy Steel Hardened & Tempered	Alloy Steel Hardened & Tempered, Further Induction Hardened Surface	Alloy Steel Hardened & Tempered	Alloy Steel Hardened & Tempered
EXTRA HEAVY DUTY	Alloy Steel Hardened & Tempered	Alloy Steel Case Hardened	Alloy Steel Case Hardened	Alloy Steel Hardened & Tempered
STANDARD	Carbon Steel Hardened & Tempered	Alloy Steel Case Hardened	Alloy Steel Case Hardened	Alloy Steel Case Hardened
STANDARD (AS)	Alloy Steel Hardened & Tempered	Alloy Steel Case Hardened	Carbon Steel Case Hardened	Alloy Steel Hardened & Tempered
UNIVERSAL	Alloy Steel Hardened & Tempered	Alloy Steel Hardened & Tempered, Further Induction Hardened Surface	Carbon Steel Case Hardened	Alloy Steel Hardened & Tempered



ISO 9001:2015 CERTIFIED

Gee Ess Engineering Works

Range Of Palm Oil Mill Chains

RANGE - 1 HEAVY DUTY Range

Chain Ref.	Pitch	U.T.S Lbs.	Pin Dia D	Roller Dia R	Side Bar Height A	Dist. b/w S/bars G	Side bar Thickness' T	Extended Screw Pin	
								Y	Z
HD9503	76.708	27891	14.224	29.972	38.100	31.496	6.350	-	-
HD1016H	101.600	20862	19.050	47.498	38.100	19.050	6.350	37.338	M16
HD5289	152.400	31746	22.098	66.802	50.800	25.400	6.350	40.894	M20
HD09060	152.400	48073	19.050	69.850	50.800	38.100	9.525	38.862	M18
HD6889	152.400	52608	31.750	88.900	60.960	38.100	8.890	50.038	M30
HD5305	160 .00	43084	17.526	69.850	50.800	38.100	6.350	36.068	M16

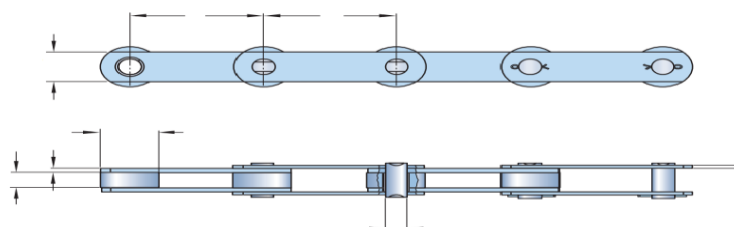

Solid Pin

RANGE - 2 EXTRA HEAVY DUTY Range

SS188	66.268	11338	12.700	No Roller	31.750	26.924	6.350	-	-
EHD-9503	76.708	27891	14.224	29.972	38.100	31.750	6.350	-	-
EHD-B3076	76.708	7256	13.970	31.750	25.400	17.399	3.987	-	-
EHD-B4075	101.600	7256	13.970	31.750	25.400	17.399	3.987	-	-
EHD-B5125	101.600	15420	11.430	47.752	31.750	21.336	4.826	-	-
EHD-B5126	101.600	15420	11.430	44.450	28.702	26.924	6.350	-	-
EHD-B1016H	101.600	20862	19.050	47.752	38.100	19.050	6.350	37.338	M16
EHD-B5326H	152.400	17234	19.050	47.752	38.100	19.050	5.080	-	-
EHD-B5289	152.400	31746	22.098	66.802	50.800	25.400	6.350	40.894	M20
EHD-09060	152.400	48073	19.050	69.850	50.800	38.100	9.652	38.862	M18
EHD-B6889	152.400	52608	31.750	88.900	60.960	38.100	8.890	50.038	M30
EHD-B5305	160mm	43084	17.526	69.850	50.800	38.100	6.350	36.068	M16
EHD-POM4P32	101.600	14513	19.050	47.752	38.100	19.050	5mm	36.068	M16
EHD-POM6P40	152.400	18141	19.050	47.752	38.100	19.050	6mm	37.338	M18
EHD-POM6P60	152.400	27211	22.098	66.802	50.800	25.400	6mm	40.894	M20
EHD-POM6P80	152.400	36281	19.050	69.850	50.800	38.100	8mm	38.862	M18
EHD-ES9503S25	152.400	27891	14.224	29.972	38.100	31.750	6.350	-	-
EHD-ES4P23	101.600	17234	19.050	47.752	38.100	19.050	5.080	36.068	M16
EHD-ES90R20	101.600	17687	11.430	47.752	31.750	21.336	4.826	-	-
EHD-ES94R30	101.600	26757	14.478	50.800	38.100	29.972	6.350	-	-
EHD-ES604R30	152.400	26757	14.478	50.800	38.100	29.972	6.350	-	-
EHD-ES6P36	152.400	37188	26.924	66.802	50.800	25.400	7.797	43.942	M24
EHD-ESB5305R	160mm	43084	17.526	69.850	50.800	38.100	6.350	36.068	M16

- All Dimensions are in mm. Dimensions are liable to change considering the quality & working loads of chains.



ISO 9001:2015 CERTIFIED

Gee Ess Engineering Works

Range Of Palm Oil Mill Chains

RANGE 3 (Continued.) STANDARD Range

Chain Ref.	Pitch P	UTS LBS	Pin Dia. D	Roller Dia. R	S/bar Height A	D/b S/bars G	Sidebar Thickness T	Extended Screw pin	
								Y	Z
SD4161	101.600	8163	19.050	47.625	38.100	19.050	4.50MM	37.084	M18
SD4162	101.600	14512	26.898	66.675	50.800	25.400	6.40MM	39.878	M20
SD6241	152.400	8163	19.050	47.625	38.100	19.050	4.50MM	37.084	M18
SD6242	152.400	14512	26.898	66.675	50.800	25.400	6.40MM	39.878	M20
SD6243	152.400	22676	31.750	88.900	60.960	38.100	9.00MM	50.038	M30

RANGE 3 (Continued.) STANDARD (AS) Range

AS4161	101.600	11791	19.050	47.625	38.100	19.050	4.50MM	37.084	M18
AS4162	101.600	22676	26.898	66.675	50.800	25.400	6.40MM	39.878	M20
AS6241	152.400	11791	19.050	47.625	38.100	19.050	4.50MM	37.084	M18
AS6242	152.400	22675	26.898	66.675	50.800	25.400	6.40MM	39.878	M20

RANGE 3 (Continued.) UNIVERSAL Range

UV4161	101.600	13605	19.050	47.625	38.100	19.050	4.50MM	37.084	M18
UV4162	101.600	27211	26.898	66.675	50.800	25.400	6.40MM	39.878	M20
UV6241	152.400	13605	19.050	47.625	38.100	19.400	4.50MM	37.084	M18
UV6242	152.400	27211	26.898	66.675	50.800	25.400	6.40MM	39.878	M20

Range 3 STANDARD = 4" & 6" pitch chains 18,000 – 50,000 Lbs U.T.S (see specification detail)

Range 3 STANDARD (AS) = 4" & 6" pitch chains 26,000 – 50,000 Lbs U.T.S (see specification detail)

Range 3 UNIVERSAL = 4" & 6" pitch chains 30,000 – 60,000 Lbs U.T.S (see specification detail)

RANGE 3 – UNIVERSAL = RENOLD EQUIVALENT

- All Dimensions are in mm. Dimensions are liable to change considering the quality & working loads of chains.



ISO 9001:2015 CERTIFIED

Gee Ess Engineering Works

Cast Elevator Chains

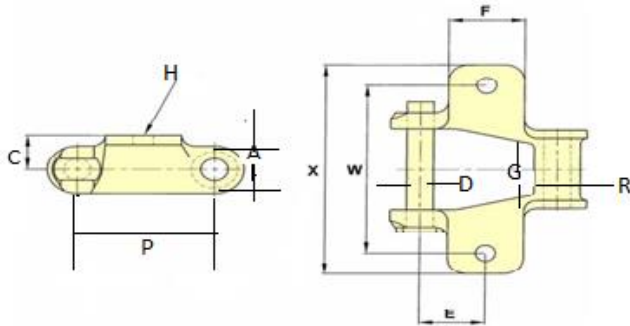

K1 Attachment

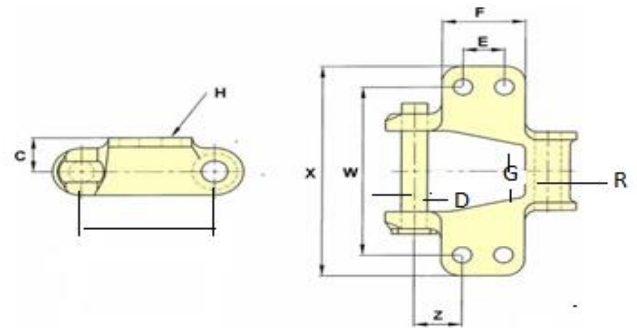

K2 Attachment

Chain Ref.	Pitch	UTS (LBT)	Pin Dia D	S/bar Height A	Max Gearing G	Barrel Dia R	C	E	F	Bolt Dia H	T	W	X
503K1	76.708	9070	14.224	35.052	28.702	27.686	22.352	-	41.402	9.652	7.874	111.252	143.002
504K2	103.124	12472	16.002	42.926	44.450	33.274	25.400	38.100	66.802	12.700	12.700	147.574	177.800

Heavy Duty Steel Rotary & Drive Chains

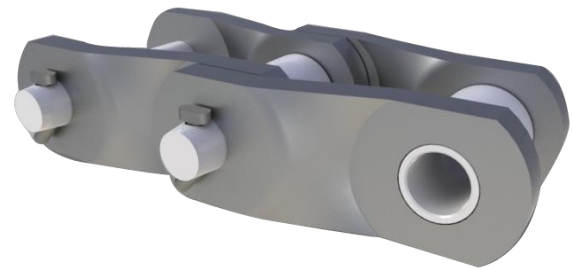
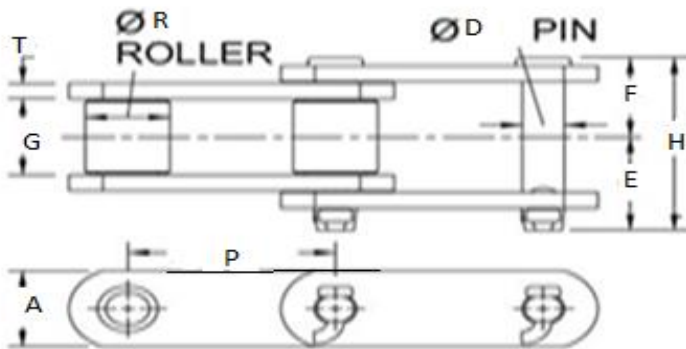

Drive Chain

Chain Ref.	Pitch p	UTS	Pin Dia. D	Roller Dia. R	S/bars Height A	Max Gearing G	T
AP13P	78.105	34014	16.510	31.750	39.624	38.100	9.652
B7811	78.105	45351	16.510	31.750	44.450	38.100	9.652
AP14P	103.200	68027	22.352	44.450	57.150	50.800	12.700

- All Dimensions are in mm. Dimensions are liable to change considering the quality & working loads of chains.



ISO 9001:2015 CERTIFIED

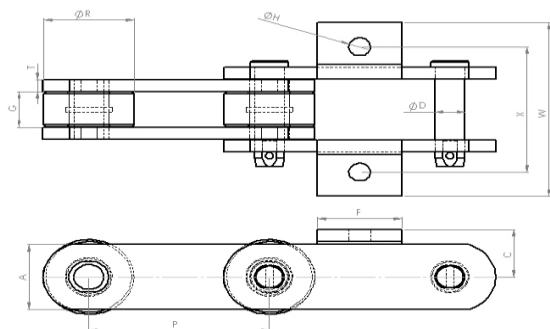

K1 Attachment

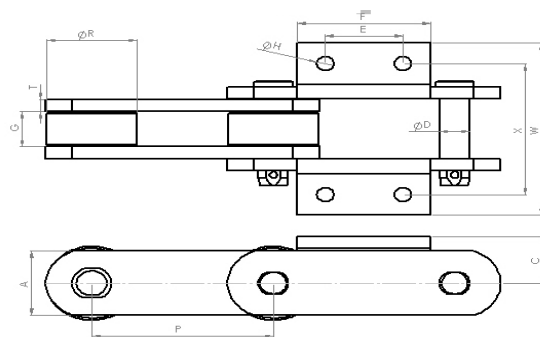

K2 Attachment

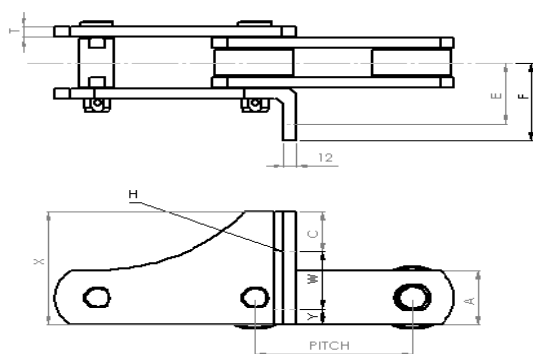

LA 2 Attachment

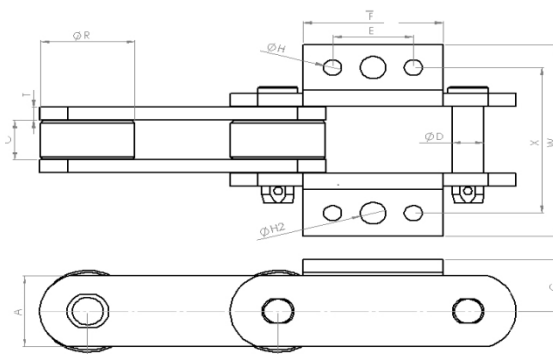

K3 Attachment

K1 Attachments

Chain Ref.	C	F	H	T	W	X
HD9503 9503, EHD9503S25	25.400	45.974	11.938	6.350	111.252	143.002

K2 Attachments

Chain Ref.	C	E	F	H	T	W	X
HD5289, EHD-B5289	38.100	60MM	100MM	12.700	6.350	120MM	170MM
HDB1016H, EHD-B1016H, EHD94R30	31.750	31.750	71.374	10.668	6.350	88.900	139.700
EHD4P23	31.750	31.750	71.374	10.668	5.080	88.900	139.700

K3 Attachments

Chain Ref.	C	E	F	H	H1	T	W	X
EHD90R20	31.750	31.750	63.500	10.668	13.970	4.8MM	88.900	123.698

LA 2 Attachments

Chain Ref	C	E	F	W	X	H	T
HD5289, EHD-B5289	50.800	69.850	11.938	6.350	40MM	88.900	22.860
EHD90R20	50.800	69.850	11.938	4.8MM	40MM	69.850	23.114

- All Dimensions are in mm. Dimensions are liable to change considering the quality & working loads of chains.



ISO 9001:2015 CERTIFIED

Gee Ess Engineering Works

Hollow Pin Chains

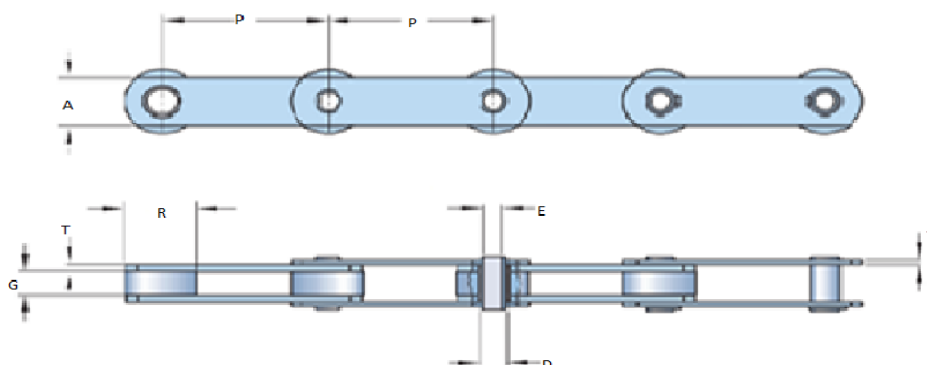

Hollow Pin

Chain Ref.	Pitch p	UTS (LBS)	PIN O/D D	PIN E	Roller Dia. R	S/Bar Height A	Dist.B/W G	Thk. T
HP-5127	101.600	5442	19.050	13.208	47.752	38.100	19.050	5.080
HP-S4P18	101.600	8163	19.050	13.208	47.752	38.100	19.050	5.080
HP-5130	101.600	16327	26.924	20.066	66.675	50.800	25.400	6.350
HP-5325	152.400	13605	26.924	20.066	66.675	50.800	25.400	6.350
HP-5328	152.400	15873	26.924	20.066	66.675	50.800	25.400	6.350
HP-S6P30	152.400	17234	26.924	20.066	66.675	50.800	25.400	7.112
HP-5327	152.400	22676	26.924	20.066	66.675	50.800	25.400	8.001
RANGE 3 - STANDARD Hollow Pin (For Specif. Details See Page No.1)								
HP-4161	101.600	6803	19.050	13.208	47.625	38.100	19.050	4.50mm
HP-4162	101.600	11791	26.898	20.066	66.675	50.800	25.400	6.40mm
HP-6242	152.400	11791	26.898	20.066	66.675	50.800	25.400	6.40mm
HP-6243	152.400	19955	31.750	23.114	88.900	60.960	38.100	9.00mm
RANGE 3 (Continued.) - STANDARD (AS) Hollow Pin (For Specif. Details See Page No.1)								
HP-4161	101.600	7710	19.050	13.208	47.625	38.100	19.050	4.50mm
HP-4162	101.600	16327	26.898	20.066	66.675	50.800	25.400	6.40mm
HP-6242	152.400	16327	26.898	20.066	66.675	50.800	25.400	6.40mm
RANGE 3 (Continued.) - UNIVERSAL Hollow Pin (For Specif. Details See Page No.1)								
HP-4161	101.600	10884	19.050	13.208	47.625	38.100	19.050	4.50mm
HP-6242	152.400	22676	20.066	20.066	66.675	50.800	25.400	6.40mm

- All Dimensions are in mm. Dimensions are liable to change considering the quality & working loads of chains.



ISO 9001:2015 CERTIFIED

Gee Ess Engineering Works

WHATS APP: 98766-00450

S-255, INDUSTRIAL AREA,
JALANDHAR-144004, PUNJAB, INDIA
e-mail: gec.chains@gmail.com

Manufacturers & Exporters

Of Industrial Chains, Sprockets, Slats & Other, Machinery Parts.