

وسملانا

Car Vacuum Cleaner

#CarVac



**Instruction Manual
& Warranty Card**

Instruction Manual

This product has been carefully engineered and manufactured to give you dependable operation.

Please read this manual thoroughly before operating your new product, as it contains the information you need to become familiar with its features and obtain the performance that will bring you continued enjoyment for many years.

SPECIFICATIONS

Name	:	Car Vacuum Cleaner
Description	:	Wet/Dry Vacuum Cleaner
Model	:	LLVAC01
Power Source	:	60W

IMPORTANT SAFETY INSTRUCTIONS

When using this appliance, basic safety precautions should always be observed including the following:

- Do not operate if unit or cord is damaged
- Do not operate in the presence of explosive and/or flammable fumes or liquids.
- Do not block air circulation openings when operating this unit.
- Do not yank on cord to disconnect unit from socket
- Do not apply lubricants to the motor of this appliance
- This appliance is not a toy Keep away from children.

IMPORTANT

- This appliance is not designed for the purpose of massive or lengthy cleaning jobs.
- For efficient cleaning and to avoid over heating, do not use for more than 20 minutes on each usage.
- Allow to cool before further usage.
- Do not use this appliance to pick up solvent based liquids, flammable or combustible materials.
- Filter is designed to prevent damage to motor.
- Do not operate without filter properly in place or with a filter which is worn, blocked by dirt or has holes.
- Do not use vacuum for any other purpose other than which it is intended.
- Do not operate from any other power source other than that for which it was designed.

1. Dirt Reservoir
2. Filter
3. On/Off Switch
4. Reservoir Release

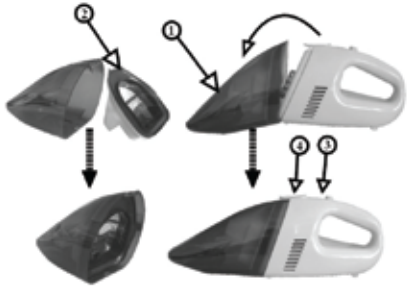

OPERATION

Make sure filter and dirt reservoir are properly in place. Plug into the cigarette lighter socket in your vehicle or other 12 volt D.C. power supply and push on/off switch on top of unit. You can vacuum for period up to 20 minutes without noticeably affecting the power of a normally charged vehicle battery in good condition. For the best results, vehicle motor should be running (see caution notes below)

- Do not use this unit if your vehicle's electrical system is weak or damaged.
- NEVER leave vehicle running in an enclosed or not properly ventilated space.
- DO NOT start vehicle with appliance plugged in to socket. The resulting voltage surge could damage the unit. Unplug unit before starting vehicle, then - plug appliance in after vehicle is running. If the vacuum fails to operate, make sure outlet is powered and rotate plug in the socket.

NOTE: Some vehicle cigarette lighters and 12 volt power ports do not operate unless the ignition switch is in the "accessory" or "on" position. If unit still doesn't operate. Unplug it from the power supply and make sure the outlet socket is clean . Check fuse in plug. Replace if necessary.

CLEANING TIPS

Regular nozzle: use regular nozzle for most cleaning jobs.

Crevice tool: use crevice tool for narrow and hard to reach areas like between seats, etc.

Caution: do not vacuum up lit cigarette butts as this may cause fires or damage filter.

For best results, empty dirt reservoir and brush off filter after each use.

CLEANING

Vacuum should be cleaned after each use. Unlatch the reservoir and empty out dirt. Gently brush dirt off filter. If filter becomes very soiled, remove from unit and wash gently by hand. Allow to dry before remounting in unit. Check filter for signs of wear or holes and replace immediately if they occur, If housing becomes soiled, wipe with a clean, damp cloth. Do not use solvents or chemicals. DO NOT immerse motor portion in water.

FUSE REPLACEMENT

This appliance is fitted with a 8A fuse located in the cigarette lighter plug. Should fuse need replacing, unscrew end cap and replace with equivalent.

CAUTION- for continued protection against risk of fire, replace only with same type and rating of fuse.



CONSUMER WARRANTY CARD

Dear Customer,

Thank you for choosing a Lifelong consumer product. All Lifelong Consumer products are designed and manufactured to the highest standards to deliver high quality performance, as well as easy installation and use. At Lifelong, we believe in providing not only service, but adding value to your purchase. The warranty has therefore been designed especially for you with your interest at heart.

Warranty Service

All Lifelong consumer products are covered against manufacture's defects from them date of purchase.

Name of the product: _____

Model: _____

Warranty coverage: 6 months

Please note:

Purchase receipt is necessary for warranty verification.

Customer Care: customercare@lifelongindia.com

Customer Details

Name: _____

Address: _____

Home Number: _____

Office Number: _____

E-mail Address: _____

Product Details

Model No.: _____

Serial No.: _____

Purchase Date: _____

Invoice Number: _____

Online Site: _____

Please log onto to www.lifelongindia.com and complete the online warranty form with your personal and product details within 14 days.

Terms and Conditions

- 1 This Warranty is void if:
 - a. The completely filled warranty card is not presented at the time of servicing the product.
 - b. The product is not operated according to the instructions given under the user manual.
 - c. Damages are caused by lightning, abnormal voltage, water or other liquid intrusion, fire, flood, accident, negligence or improper handling.
 - d. Product has been damaged due to installation, repairs, alterations or modifications by unauthorized service organizations or persons.
 - e. Product label specifying the model number, serial number and production code has been removed and altered.
 - f. Defects or parts requiring replacement due to ordinary wear and tear, corrosion, rust or stains, scratches, dents on the casing or paintwork of the product.
 - g. Claims damaged and/or missing parts (accessories) after 7 days from the original date of goods received.
 - h. Defects or faults in product which have been used for commercial/industrial purposes or which have been rented/leased or have been otherwise subject to non-household/non-domestic use.
2. Repairs or replacements will be carried out by authorized service.
3. During the limited warranty period, Lifelong or its authorized service provider will repair without charge the defective unit inclusive of labor and parts and restore the unit to its optimum working condition. All defective parts used for the warranty repair should be surrendered to Lifelong and/or its authorised servicer.
4. All expenses incurred in collecting the unit (s) or part(s) thereof from authorised service provider as well as any other expenses and incidentals will be borne by the consumer.
5. Lifelong obligations are limited to the repair and replacement of the defective product. Except as set forth above, there are no other express or implied warranty and all warranted, conditions or other terms implied by statute or common law (including any warranty of satisfactory quality, merchantability or fitness for a particular purpose) are excluded to the fullest extent permitted by the law.
6. Lifelong total liability for damages relating to or arising out of the purchase or use of the product regardless of the type or cause of such damage of the form of characterization of the claim asserted (e.g. contract or tort) shall not exceed the original purchase price paid for the product.
7. However in no event shall Lifelong and Lifelong authorized distributors be liable for any punitive, special incidental, indirect or consequential losses or damages whatsoever (including without limitation, damages for the loss of revenue, business, profits, goodwill, or contracts, business interruptions, loss of business information or any other pecuniary loss.) Whether or not Lifelong has been advised of the possibility of such damages. These limitations shall apply notwithstanding the failure of the essential purpose of any limited warranty. This limited warranty does not affect consumer's statutory rights under the law.
8. No carrier, dealer or employee is thereof authorized to make modifications to this warranty and you should not rely on any such representation. Lifelong reserves the right to amend the terms and conditions if necessary.

Imported and marketed by:

Lifelong India Private Limited

Made in China

For queries and complaints please

contact: customercare@lifelongindia.com

www.lifelongindiaonline.com