

## **TROPICool® LED Monitor**

**Model WB 240M ( SY 240)**

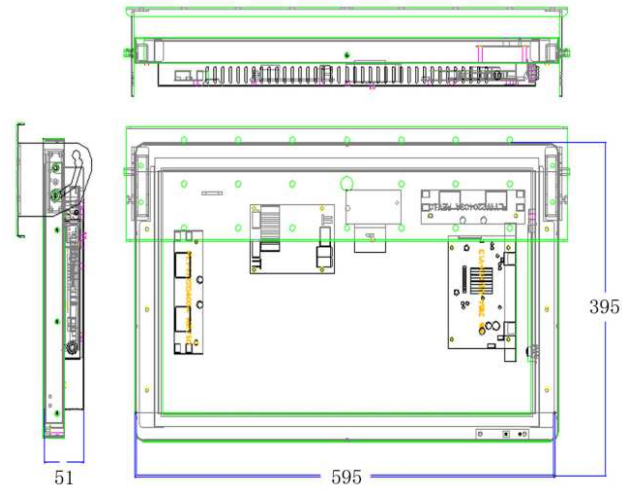

| <b>Specifications :</b>         |   |
|---------------------------------|---|
| <b>Voltage In / Power:</b>      | <b>24VDC ( 9-36 V DC) / &lt; 35 Watts</b>   |
| <b>Type:</b>                    | <b>LED</b>  |
| <b>Size</b>                     | <b>23.6" LCD</b>  |
| <b>Display Mode:</b>            | <b>16:9 ( Wide view screen)</b>   |
| <b>Resolution / Brightness:</b> | <b>1920 x 1080 ( Full HD) /300 cd/sq.mtr.</b>   |
| <b>Interface</b>                | <b>VGA, HDMI, AVI , USB Input</b>   |
| <b>Support:</b>                 | <b>MEPG4(AVI, DIVX, XVID), MEPG2(DVD, VOB, mpeg), MEPG1(VCD, DAT, MPG), MP3, JPG, BMP, GIF, PNG</b> |
| <b>Fixing:</b>                  | <b>metal shockproof frame, top hanging/back hanging with anti-theft lock, tempered glass.</b>       |
| <b>Viewing Angle</b>            | <b>85/85 V/80/80 H</b>  |
| <b>Colours:</b>                 | <b>Black , Beige, Gray</b>  |

|                             |  |
|-----------------------------|--|
| <b>Work Life:</b>           | <b>50000 Hrs</b>   |
| <b>Storage Temperature:</b> | <b>-10 to +70 Deg.C</b>  |
| <b>Working Temp:</b>        | <b>-5 to +65 Deg.C</b>   |
| <b>Dimension / Weight:</b>  | <b>700 x 410 x 51 mm ( L x W x H ) / 9 Kg. With bracket<br/>595 x 395 x 51 ( L x W x H ) w/o bracket</b> |
| <b>Features:</b>            | <b>Auto shut off when panel cover close<br/>USB input: to play video files ( No DVD player required)</b> |
| <b>Fixing:</b>              | <b>Roof mount / Wall mount</b>   |
| <b>Test Mark:</b>           | <b>CE certified</b>  |

---

A-1, Kumar Classics, Aundh, Pune - 411 007, Tel.: (020) 25881704, Fax: (020) 2588 0851  
E-mail: [info@tropicoolindia.com](mailto:info@tropicoolindia.com) Website: [www.tropicoolindia.com](http://www.tropicoolindia.com)

**TROPICool® Car Gadgets Pvt. Ltd..**

**Luxury & Safety On The Wheels ... For The People On The Move**